

# phoebe

- Gas assisted free adjustment
- High quality die cast aluminium
- Removable rotating VESA plate
- Integrated cable management



PHOEBE gas assisted single and dual monitor arms from OE Electrics are constructed with elegant die cast aluminium and innovative counterbalance technology. The highly adjustable arms allow you to move your monitors up, down, forward and back with just a light touch, until you have achieved the best ergonomic positions.

Monitor installation is made easier due to the removable, rotating, and tilting VESA plate, and PHOEBE's integrated cable management removes untidy cables from your workspace.

Each gas assisted arm has maximum weight capacity of 9kg/19.8lbs, and provides 180° monitor rotation, -90°~ +90° tilt, 180° swivel, plus vertical height adjustment.

PHOEBE single and dual monitor arms are perfect for personal offices, open-plan, or public areas and are available in silver or white. They are supplied with both "C" clamp and through-desk clamp brackets as standard.

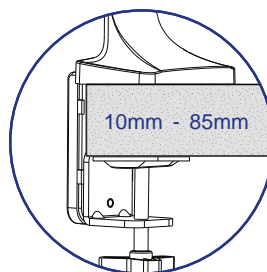

Description		Colour	Product code
PHOEBE	(single)	Silver	<b>2705509</b>
PHOEBE	(single)	White	<b>2705516</b>
PHOEBE Duo	(double)	Silver	<b>2705523</b>
PHOEBE Duo	(double)	White	<b>2705530</b>

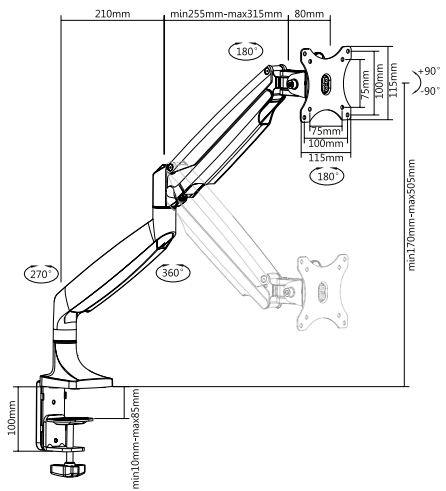
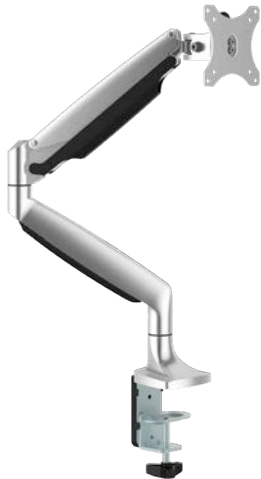

PHOEBE  
Arm Extend: 525mm

min-max  
**13"-32"**  
max vesa 100 x 100

max  
**9kg/19.8lbs**

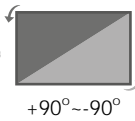
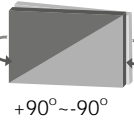

VESA  
compatible

100 x 100  
75x75

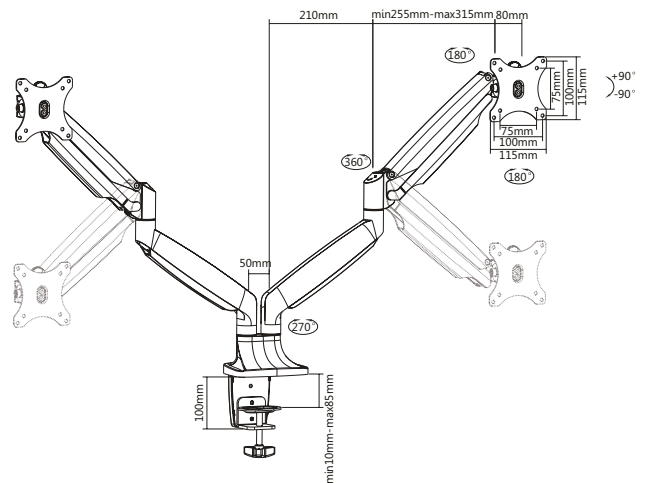

PHOEBE Duo  
Arm Extend: 525mm

min-max  
**13"-32"**  
max vesa 100 x 100

max  
**9kg/19.8lbs**

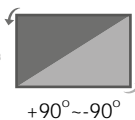
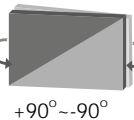

VESA  
compatible

100 x 100  
75x75





**Sales**

email

**+44 (0) 1924 367255**

sales@oeelectrics.co.uk

**Quotes**

email

**+44 (0) 1924 334014**

quotes@oeelectrics.co.uk

**Website****www.oeelectrics.com****Address**

OE House, Thomas Maddison Lane,  
Calder Park, Wakefield,  
West Yorkshire, WF4 3GH

**Sales Offices****London**

tel: + 44 (0) 20 72539738

email: london@oeelectrics.co.uk

1a Briset Street, London, EC1M 5NR

**Europe + rest of world**

tel: + 49 175 689 7227

email: global@oeelectrics.co.uk

**Middle East**

tel: + 971 (0)50 145 7695

email: info.middle-east@oeelectrics.co.uk

**Overseas Manufacturing****Australia**

tel: +61 (0) 2 9454 7515

email: sales@elsafe.com.au

**Elsafe Australia Pty Ltd**

www.elsafe.com.au

