

Did you know? Having set specification standards for the UK, NBS have now established the same high standards for BIM Objects.

NBS National BIM Library offers a free-to-use resource of NBS standard generic and proprietary BIM Objects in industry-neutral IFC and formats compatible with Autodesk Revit, ArchiCAD, Vectorworks, Tekla and Bentley.

NBS Plus product specifications by NBS



The product information below is from the NBS Plus library of product clauses offered in NBS specification products. It has been created by NBS for Nvelope Rainscreen Systems Ltd (NVELOPE). The clause is authored in NBS format and is intended for inclusion in project specifications. The clause can be copied and pasted into your project specification document. **Please note that NBS product guidance is not a replacement for the manufacturer's literature and it is recommended that Nvelope Rainscreen Systems Ltd (NVELOPE) be consulted before specifying.**

To find out more about producing specifications for building projects visit www.theNBS.com/solutions

Nvelope NV6

Features:

- NV6 is the Nvelope system for supporting a timber batten – vertical cladding applications (to support vertical and/ or horizontal cladding elements).
- Timber batten can be used to support timber cladding/ weatherboarding and ply (used as a substrate for other materials e.g. metal).
- Concealed fix system, utilizing Nvelope helping hand brackets plus Nvelope carrier.
- Nvelope flexible point brackets absorb wind loading and allow for expansion and contraction.
- Nvelope fixed-point brackets absorb both vertical dead loads.
- Nvelope Bracket spacing is determined by cladding options such as the dimensions and weight of the facade cladding, local wind loads.

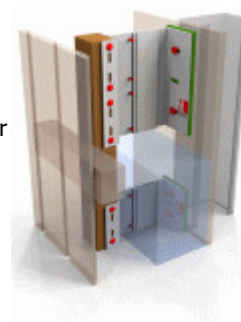

Support:

- Vertical timber cladding: vertical timber bearers are supported with Nvelope carriers brackets fixed back to Nvelope support brackets.
- Horizontal timber cladding: vertical timber bearers are supported with Nvelope carriers fixed back to Nvelope support brackets, then counter battened.

Usage:

- Suitable for the support of vertical or horizontal timber rails or timber boarding, to which timber cladding, weatherboard panels or boards, or panels made to support other materials, e.g. copper, zinc, etc. may be attached.
- The bracket assembly provides a suitable element for the fixing of timber bearers or battens where medium to large cladding zones are required.

More about Nvelope NV6:

[As standard](#) - [Options](#)

Nvelope NV6

- Manufacturer: Nvelope Rainscreen Systems Ltd (NVELOPE).
 - Web: www.nvelope.com.
 - Tel: +44 (0)1707 333396.
 - Product reference: Nvelope NV6.
- Fasteners:
 - Type: [_____] - Consult with Nvelope Rainscreen Systems Ltd for recommendations and details.
 - Number and location: [_____] - Consult with Nvelope Rainscreen Systems Ltd for recommendations and details.
- NV brackets (V):
 - Type: [\[Single\]](#).
[\[Double\]](#).
 - Size: [\[60 mm\]](#). - Adjustment 112–142 mm.
[\[90 mm\]](#). - Adjustment 133–173 mm.
[\[120 mm\]](#). - Adjustment 163–203 mm.
[\[150 mm\]](#). - Adjustment 193–233 mm.
[\[180 mm\]](#). - Adjustment 223–263 mm.
[\[210 mm\]](#). - Adjustment 253–293 mm.
[\[240 mm\]](#). - Adjustment 283–323 mm.
[\[270 mm\]](#). - Adjustment 313–353 mm.

- Fixing: [300 mm]. - Adjustment 343–383 mm.
 - [6.5 mm holes]. - Suitable for steel and/ or timber substrates.
 - [11 mm holes]. - Suitable for block/ concrete substrates.
- Profile:
 - [L, 60 x 40 mm].
 - [T, 40 x 100 mm].
 - [T, 60 x 80 mm].
 - [T, 60 x 120 mm].
 - [T, 60 x 140 mm].

[top ^](#)

Guidance for Nvelope NV6 from Nvelope Rainscreen Systems Ltd (NVELOPE)

More about Nvelope NV6: [As standard](#) - [Options](#)

As standard

Material:

Manufactured from extruded aluminium alloys conforming to BS EN 573–3 (material) and BS EN 755 (production).

Options

Nvelope brackets (V):

Allows adjustment between back of chosen façade and face of substrate material including Nvelope isolator (5 mm).

Nvelope isolators:

An optional PVC isolator can be located between the Nvelope bracket and the face of the substrate being fixed to.

Further Information

Literature:

 CPD information is available for [Nvelope Rainscreen Systems Ltd \(NVELOPE\)](#) from ribacpd.com.

 Additional information may be available for [Nvelope Rainscreen Systems Ltd \(NVELOPE\)](#) from ribaproductselector.com.

Contacts:

www.nvelope.com

info@nvelope.com

T: +44 (0)1707 333396

F: +44 (0)1707 333343

[top ^](#)

NBS Plus

www.thenbs.com/solutions, online library, 23 July 2014