

## System:- NV3 System

aluminium support system for  
rain screen cladding panels

### NVELOPE SYSTEM NV3

#### CONTENTS:

- NV3-01 Tolerances for adjustment
- NV3-02 Elevation of cladding – details
- NV3-03 Elevation of cladding
- NV3-04 Horizontal section – MacFOX 90
- NV3-05 Vertical section – NVELOPE 90 SINGLE
- NV3-06 Vertical section – NVELOPE 90 DOUBLE
- NV3-07 Vertical section with joint in profile
- NV3-08 Vertical section – base detail
- NV3-09 Vertical section – head of cladding
- NV3-10 Horizontal section–external corner
- NV3-11 Horizontal section–internal corner
- NV3-12 Horizontal section–window jamb detail
- NV3-13 Vertical section–window sill detail
- NV3-14 Vertical section–window head detail
- NV3-15 Final fix detail
- NV3-16 Clips and rail detail

#### LEGEND:

- A – Cladding SHEET
- B – PTS Screw or Under cut anchor
- C1 – Secret fixing clip with levelling screw
- C2 – Secret fixing clip.
- D – Screw
- E – Fixing screw
- F – Window profile
- 1 – Steel frame wall
- 2 – NVELOPE – support bracket
- 3 – Primary Fixing
- 4 – L profile vertical ( 60 X 40 X 2.2 )
- 5 – SR2 self drilling stainless steel screw
- 6 – Horizontal Profile
- 7 – Insulation
- 8 – Ventilation
- 10 – NVELOPE Isolator

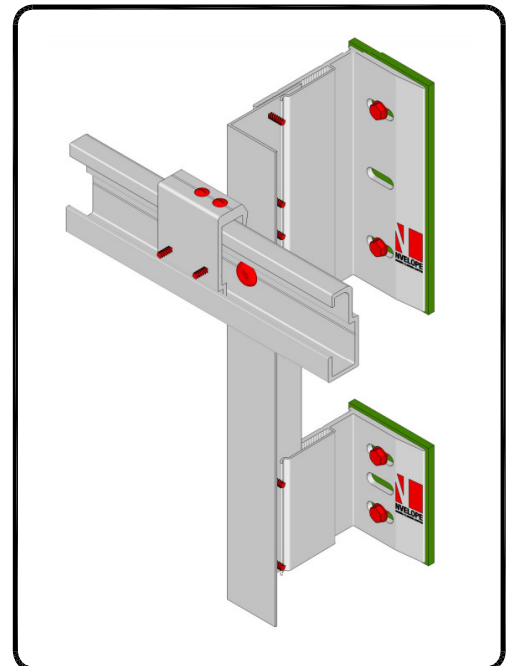
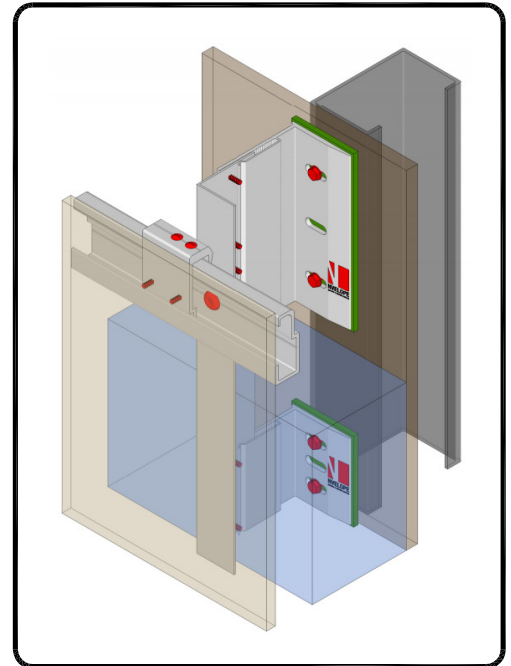

## System:- NV3 SYSTEM

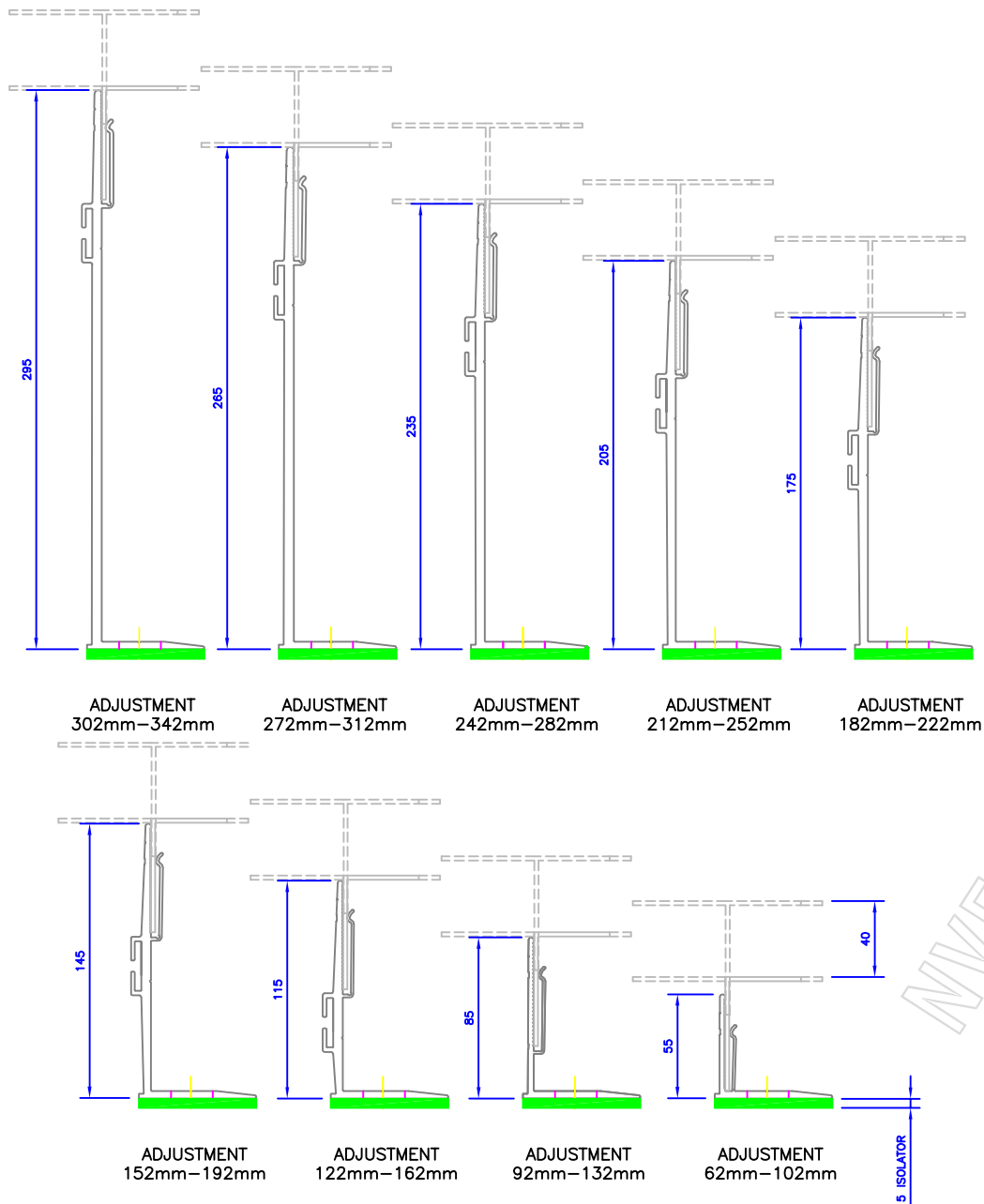

| BRACKETS    | Adjustment range for each bracket ( mm ) |        |
|-------------|--|--------|
| Nvelope 60  | from 62                                  | to 102 |
| Nvelope 90  | from 92                                  | to 132 |
| Nvelope 120 | from 122                                 | to 162 |
| Nvelope 150 | from 152                                 | to 192 |
| Nvelope 180 | from 182                                 | to 222 |
| Nvelope 210 | from 212                                 | to 252 |
| Nvelope 240 | from 242                                 | to 282 |
| Nvelope 270 | from 272                                 | to 312 |
| Nvelope 300 | from 302                                 | to 342 |

HORIZONTAL SECTIONS  
TOLERANCES FOR ADJUSTMENT

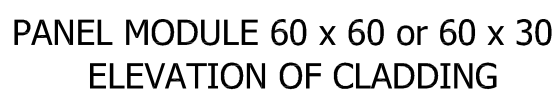

Technical drawing of a rectangular structure, likely a wall or partition, showing dimensions and labels. The drawing includes a side elevation and a cross-section view.

**Dimensions:**

- Overall width: 600
- Overall height: 600
- Top section height: 450
- Middle section height: 280
- Bottom section height: 600
- Left side width: 75
- Right side width: 75
- Bottom section width: 450

**Labels and Callouts:**

- A**: Labels for the top and bottom sections.
- C1**: Labels for the top and bottom sections.
- C2**: Labels for the top and bottom sections.
- 3**: Label for the top section.
- 2**: Label for the top section.
- 6**: Label for the top section.
- 4**: Label for the middle section.

The drawing shows a rectangular structure with a central section and two side sections. The central section is divided into three horizontal sections. The top and bottom sections are labeled 'A' and 'C1', and the middle section is labeled 'C2'. The side sections are labeled '3', '2', and '6'. The dimensions are given in millimeters (mm).

System:- NV3 SYSTEM

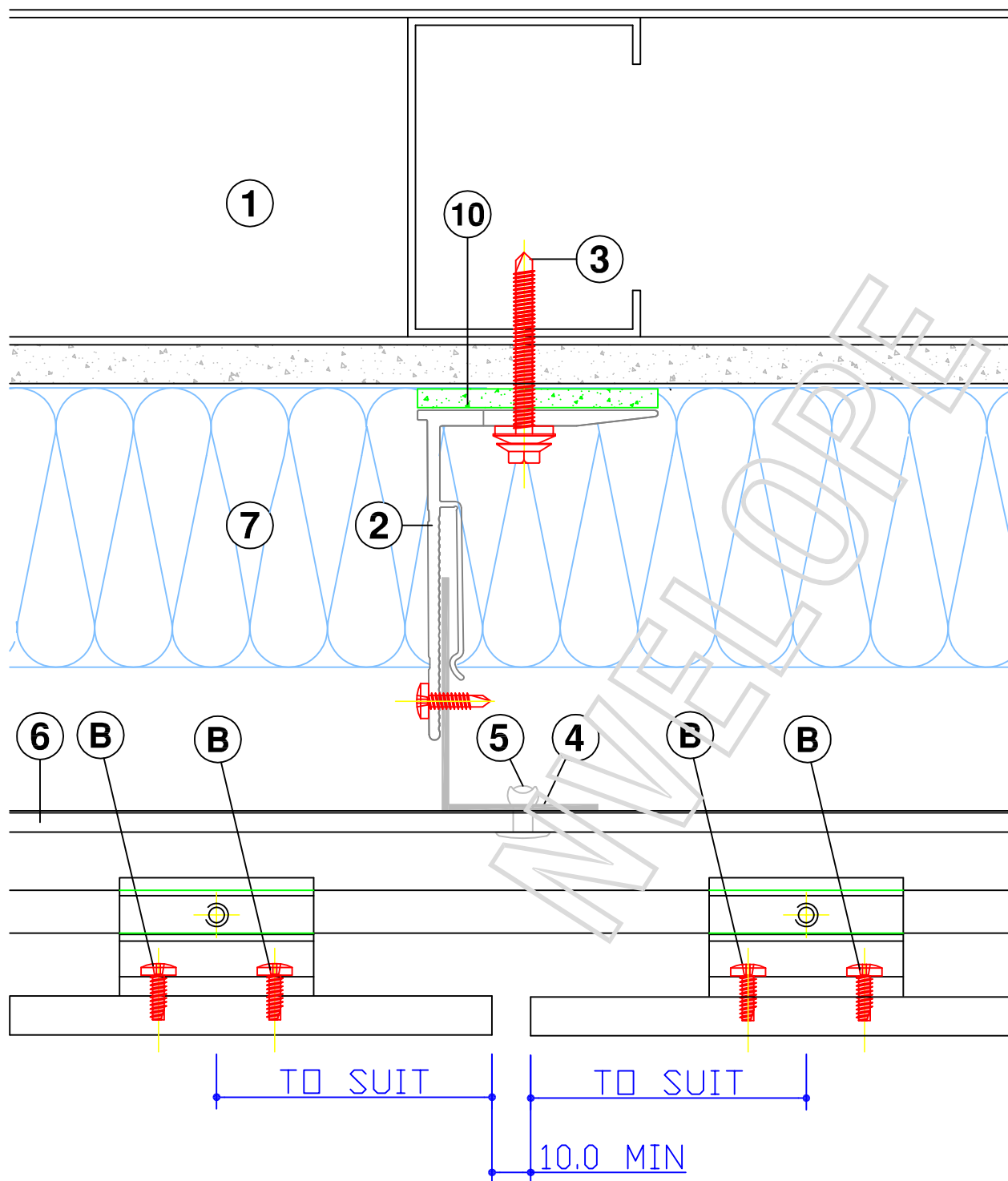

HORIZONTAL SECTION - MacFOX 90

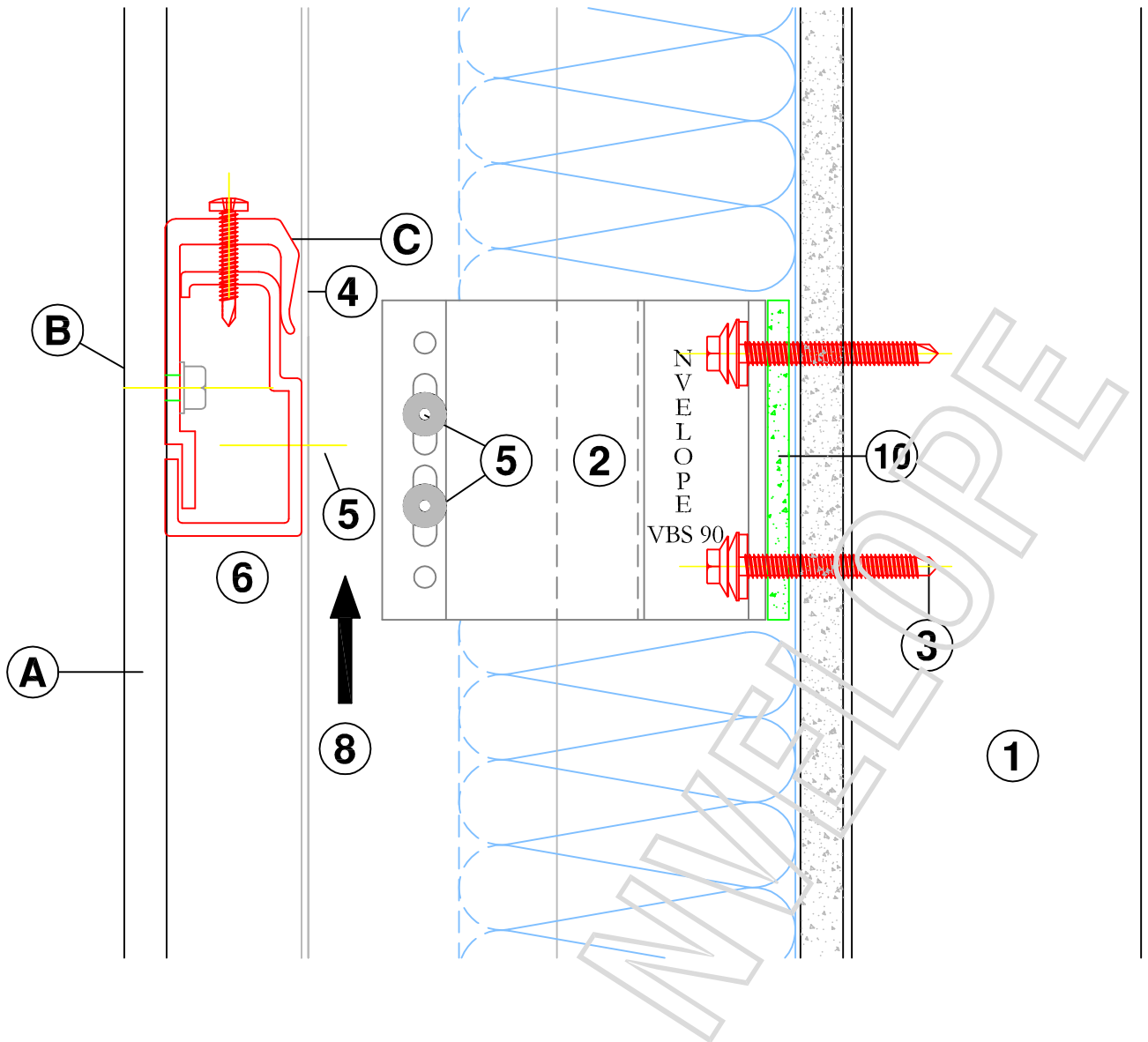

VERTICAL SECTION - NVELOPE 90 SINGLE

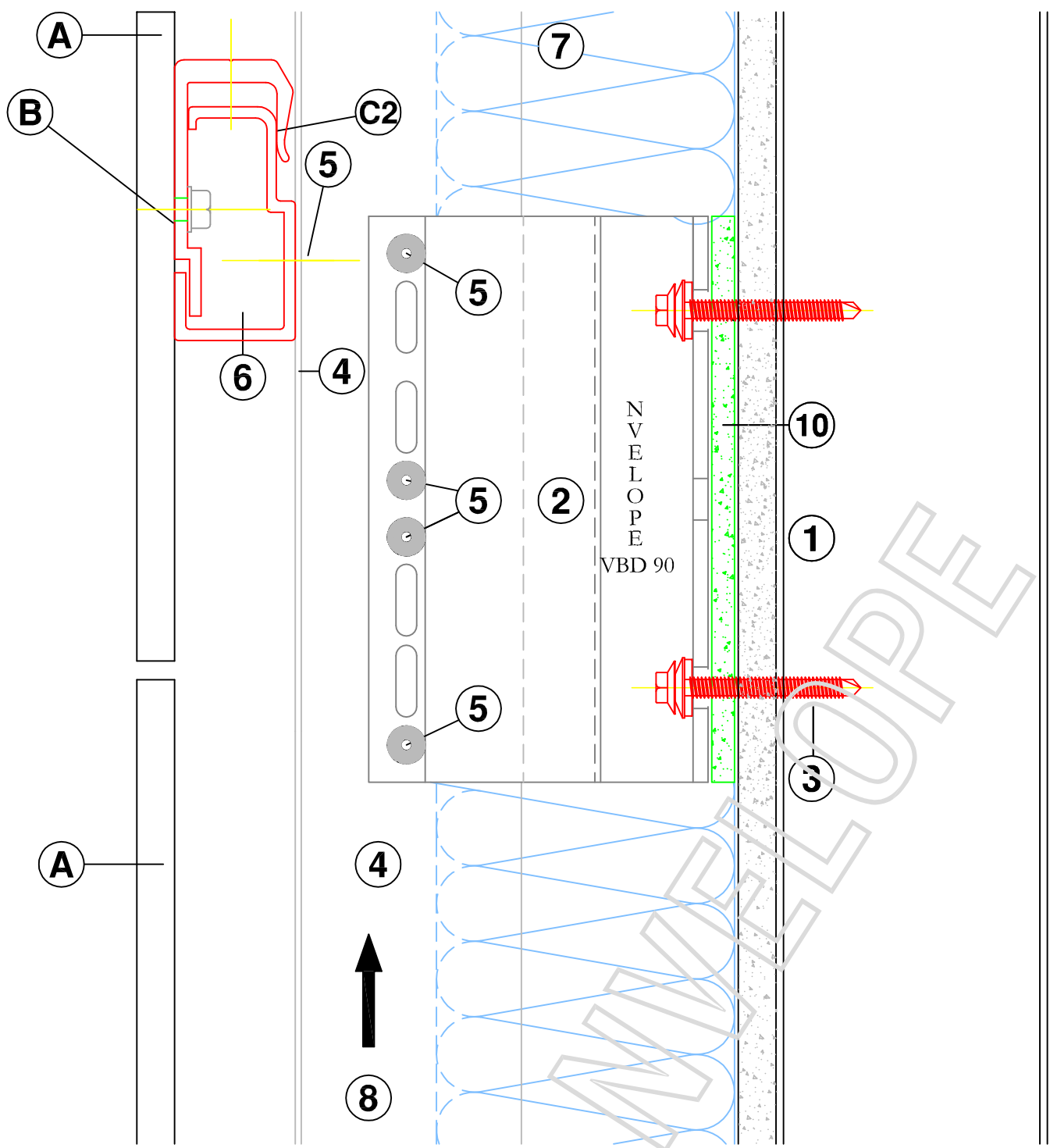

VERTICAL SECTION - NVELOPE DOUBLE

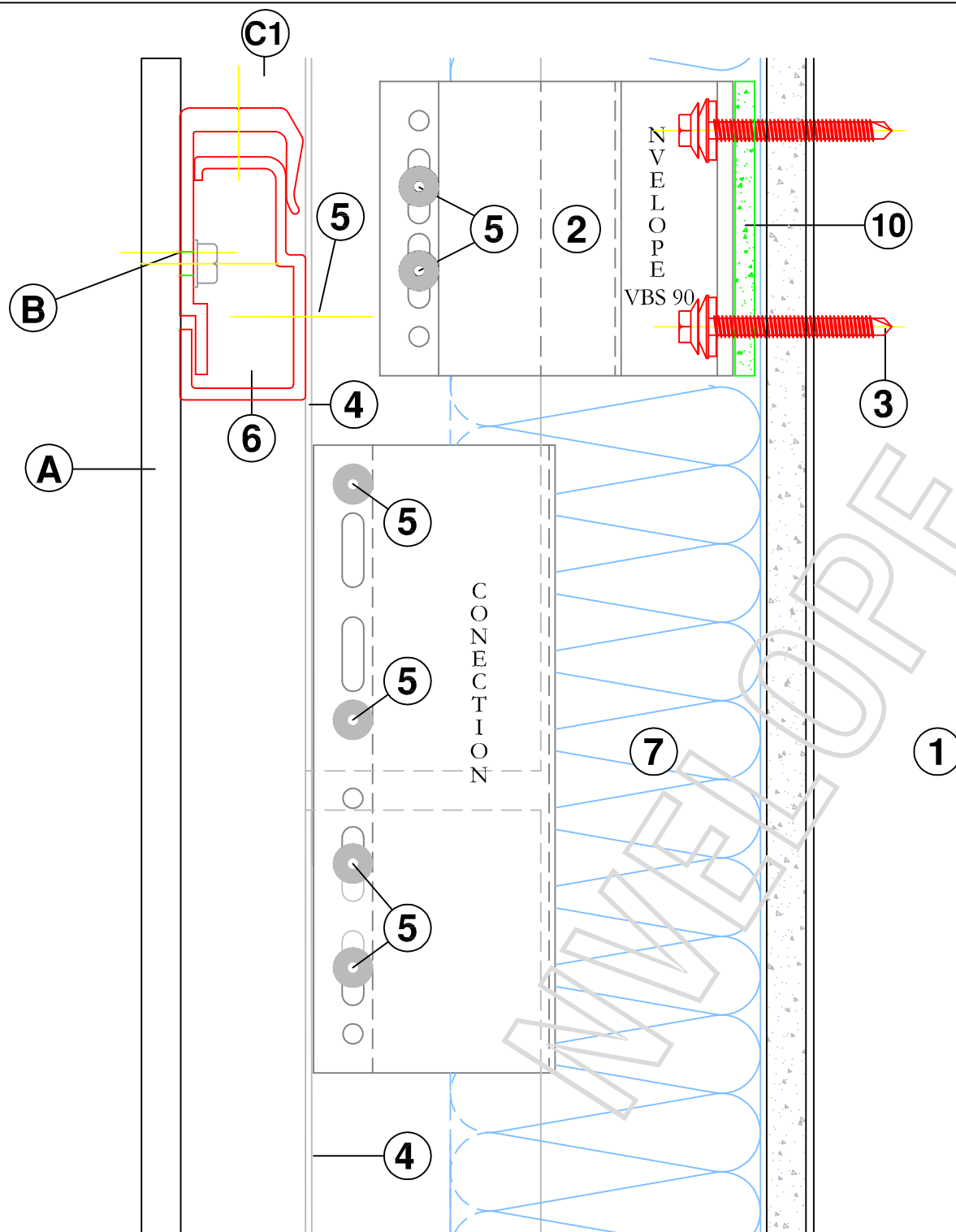

## VERTICAL SECTION - MacCONFOX - JOINING OF PROFILES



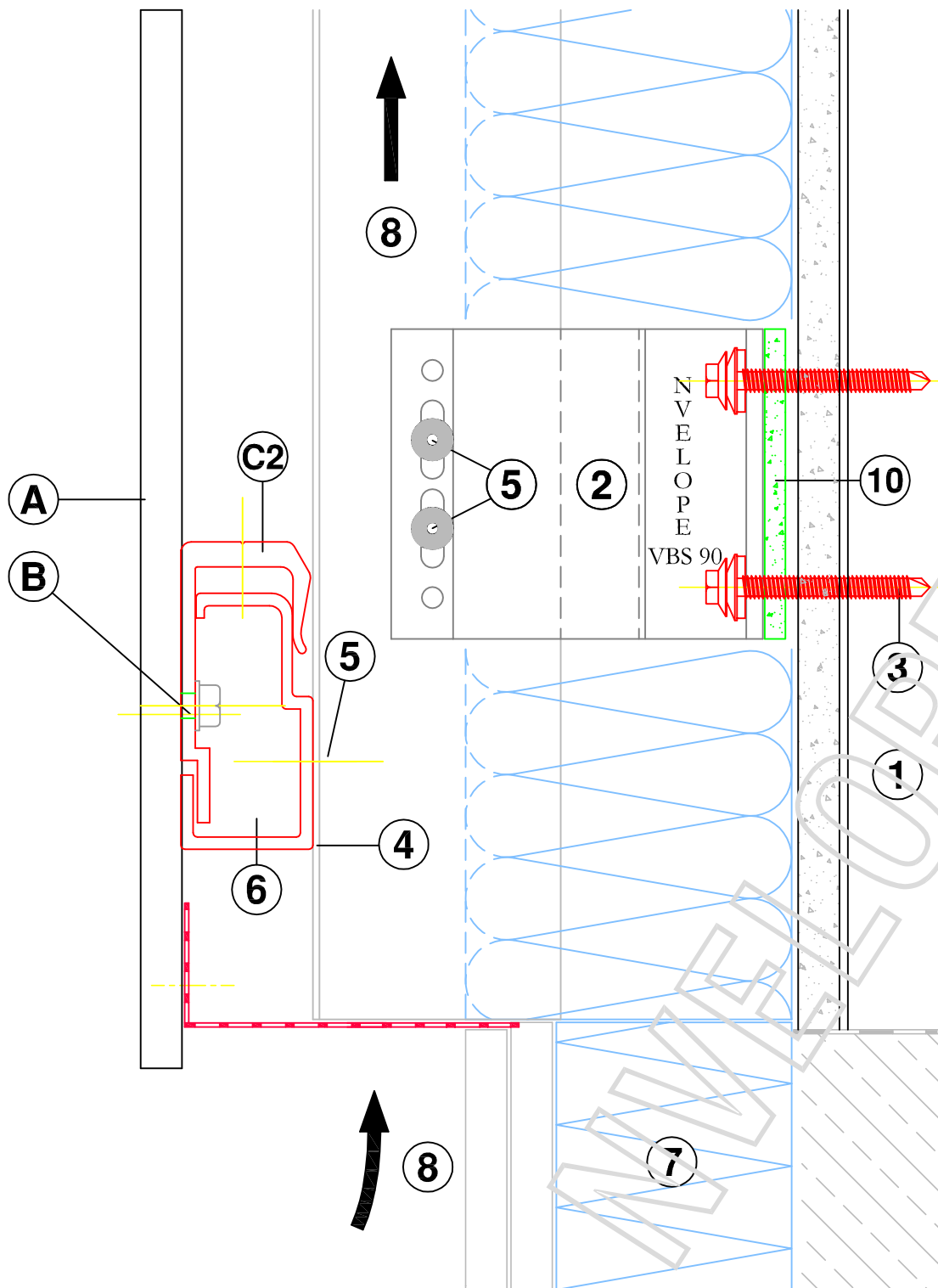

VERTICAL SECTION - BASE OF CLADDING

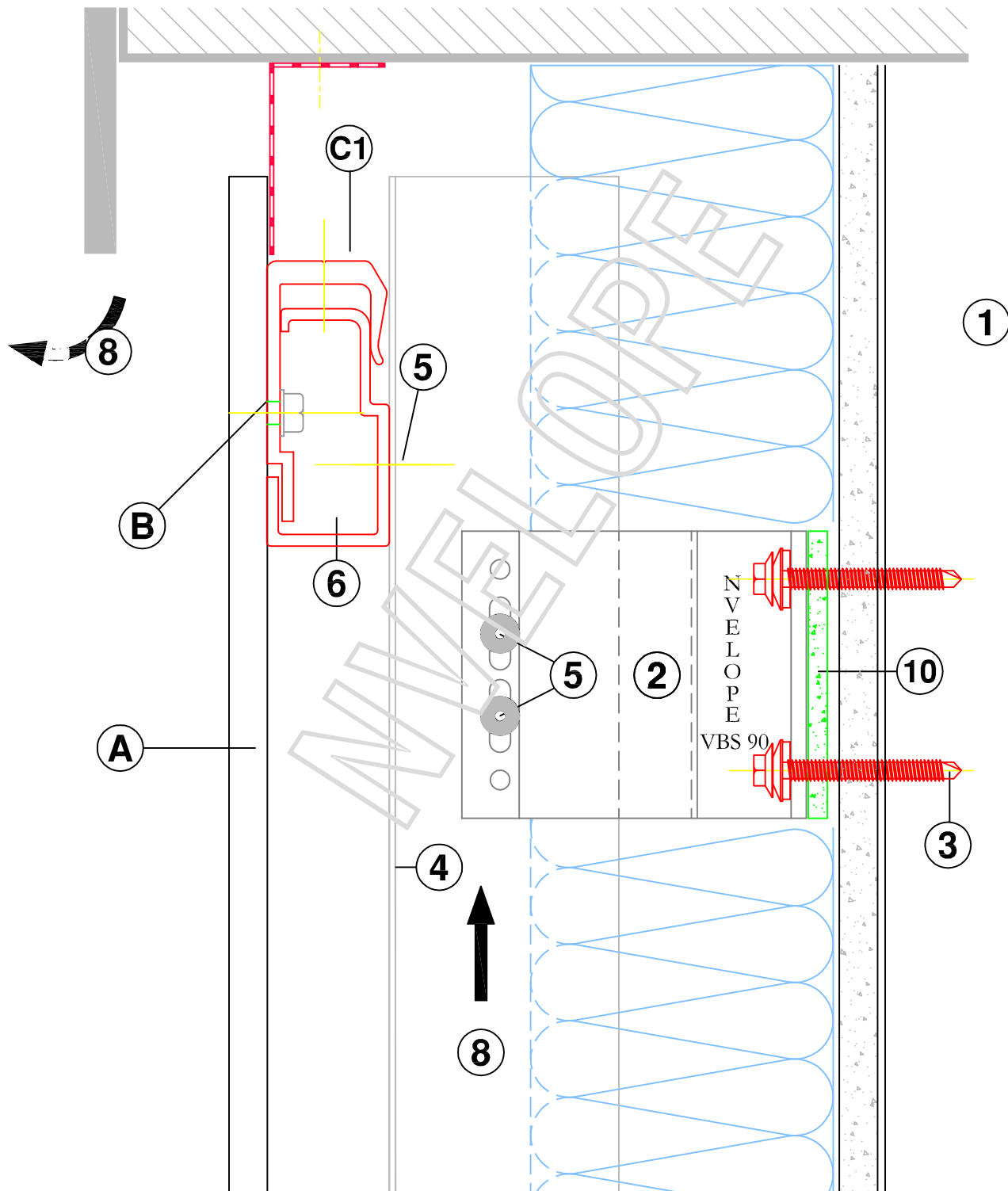

VERTICAL SECTION - HEAD OF CLADDING

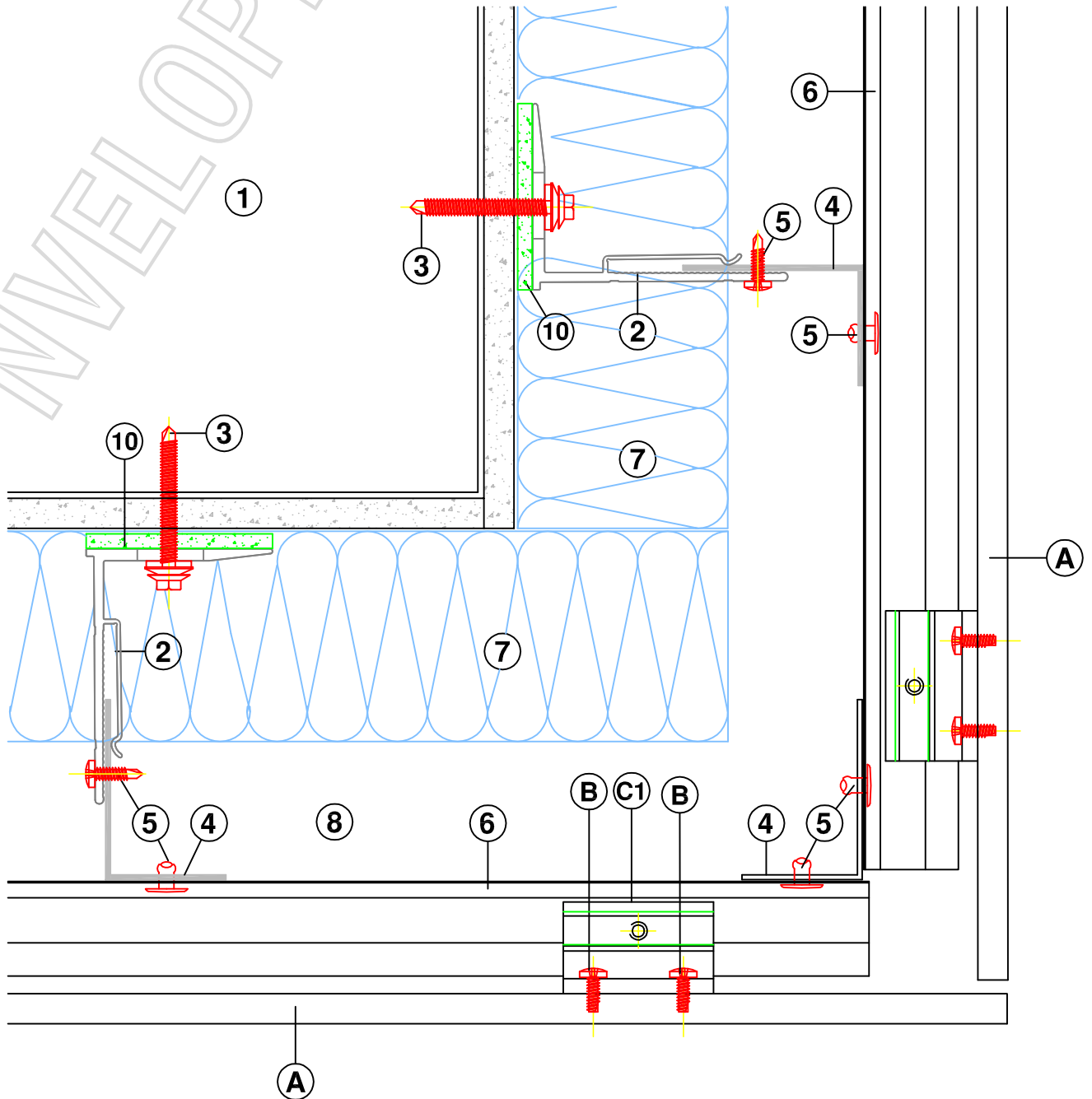

## HORIZONTAL SECTION - EXTERNAL CORNER

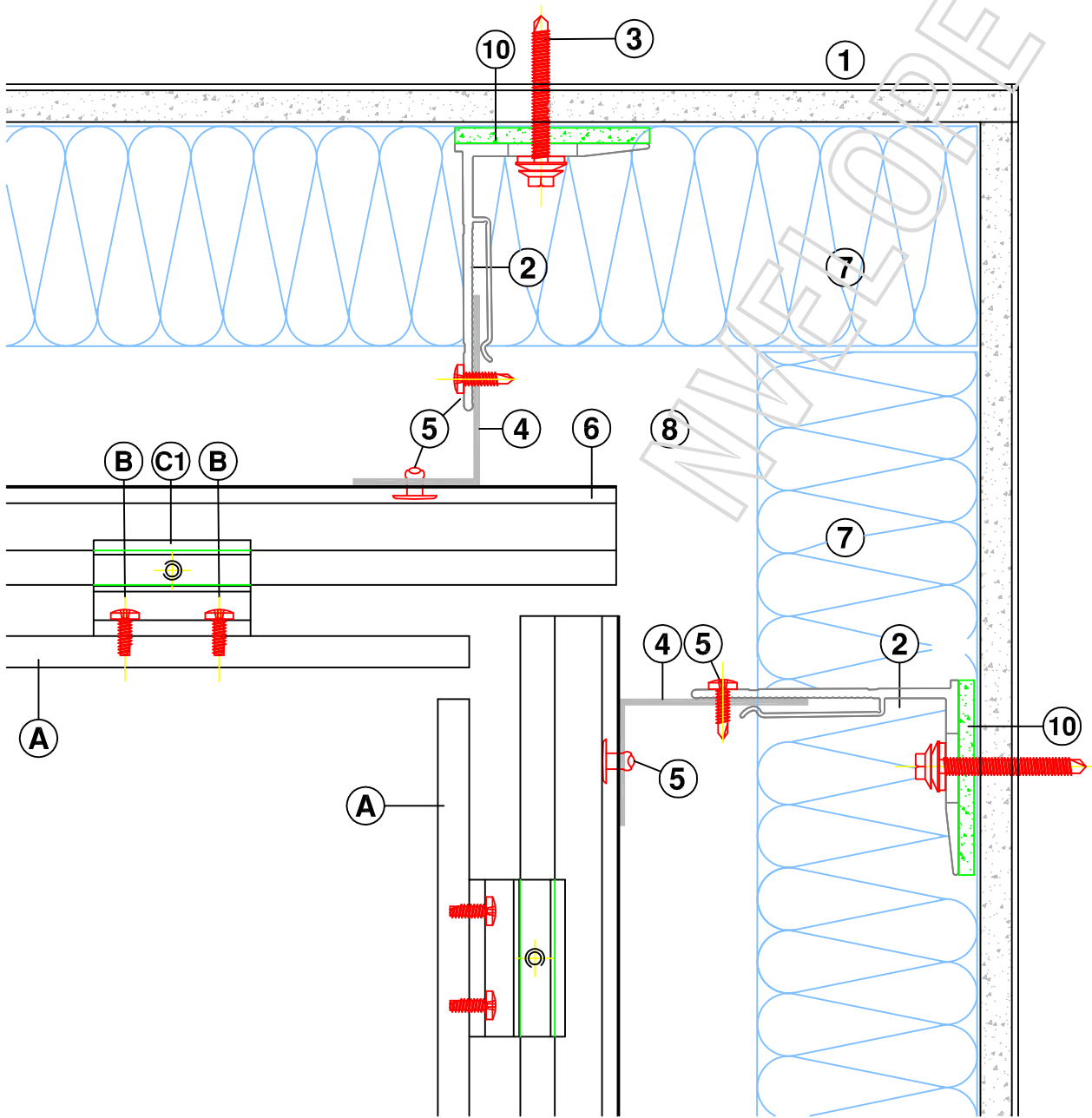

HORIZONTAL SECTION - INTERNAL CORNER

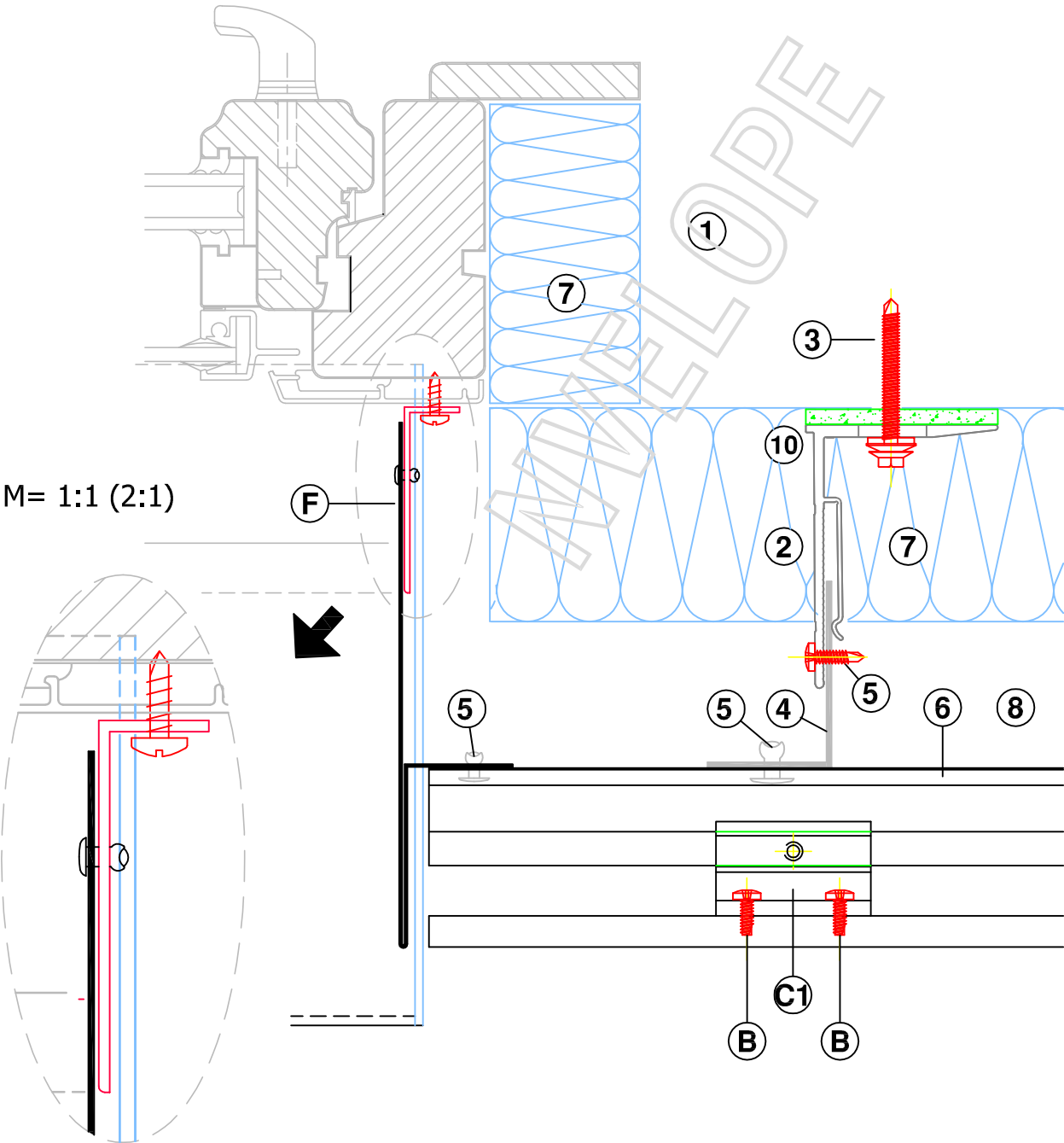

HORIZONTAL SECTION - WINDOW JAMB DETAIL

System:- NV3 SYSTEM

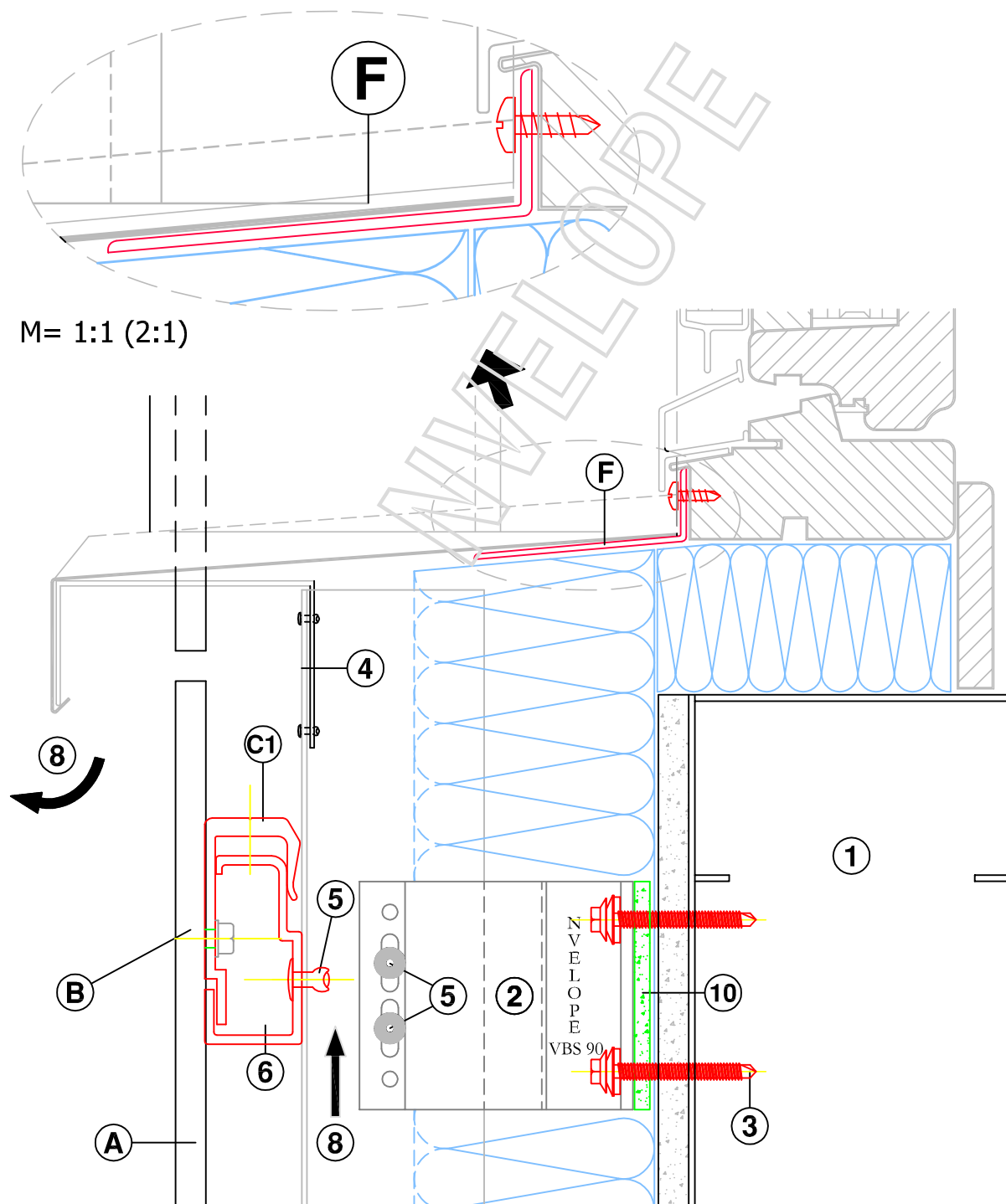

VERTICAL SECTION - WINDOW SILL DETAIL

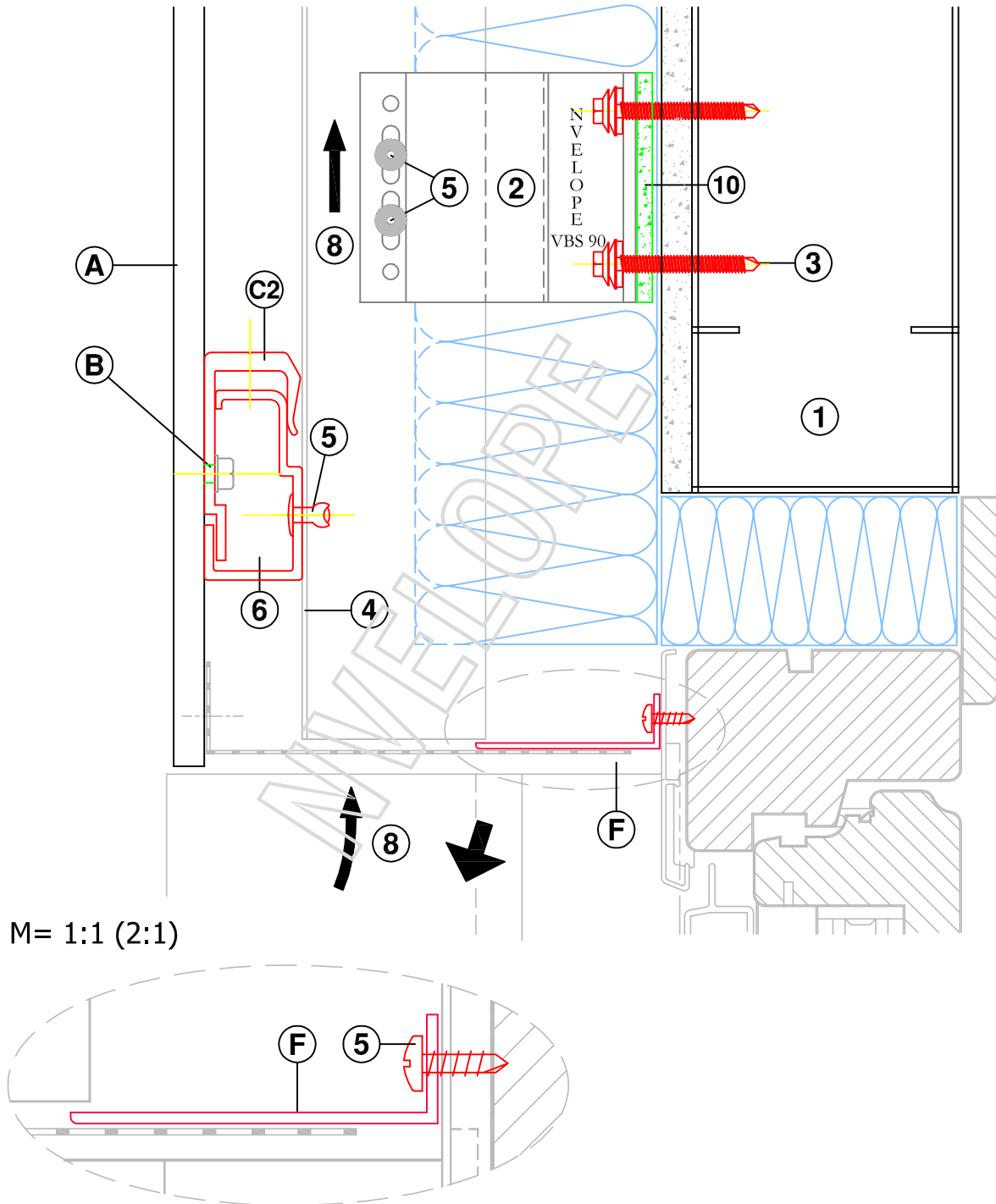

VERTICAL SECTION - WINDOW DETAIL HEAD

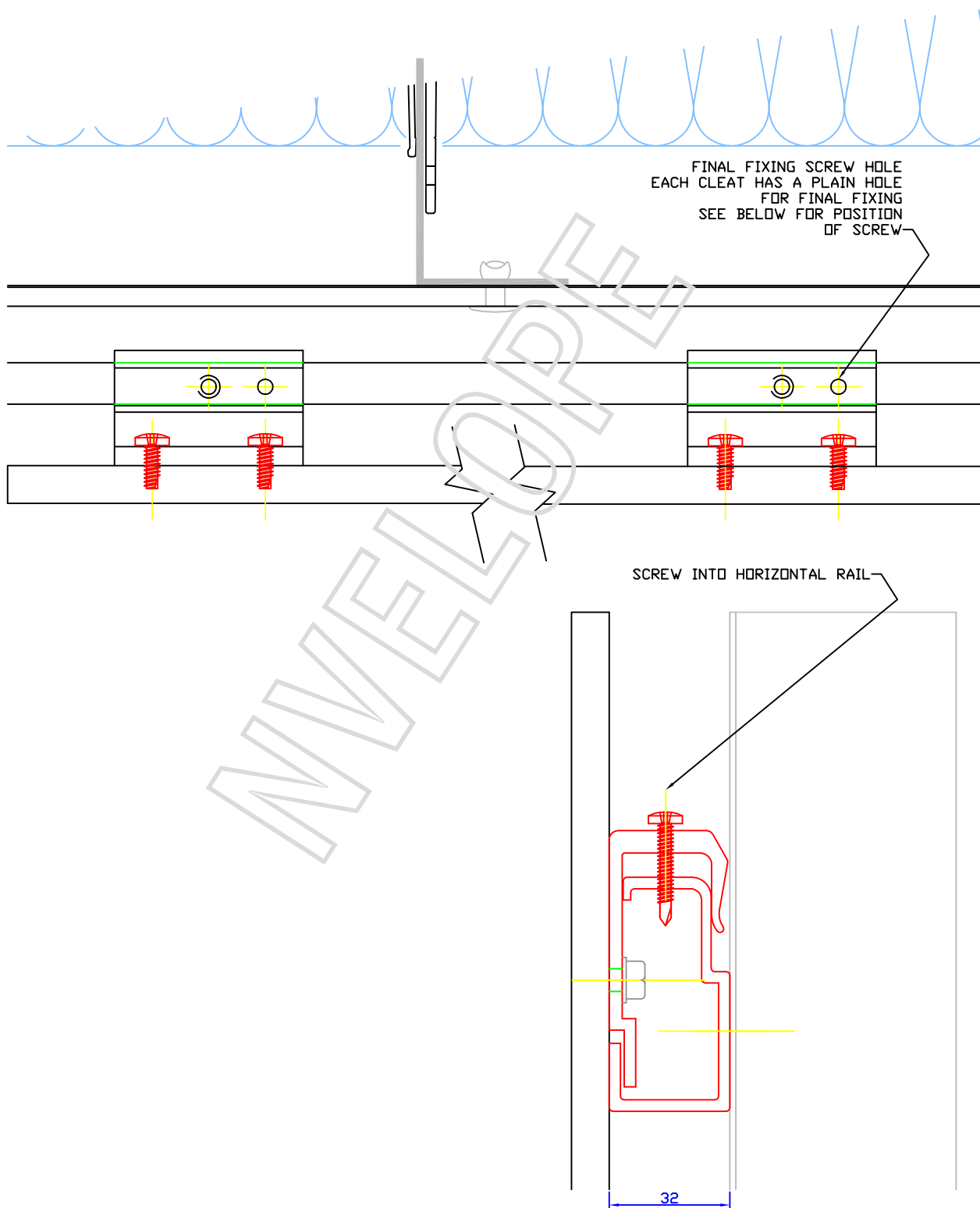

FINAL FIXING SCREW



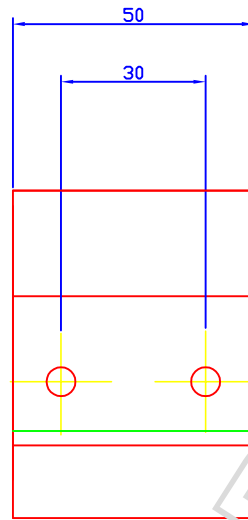
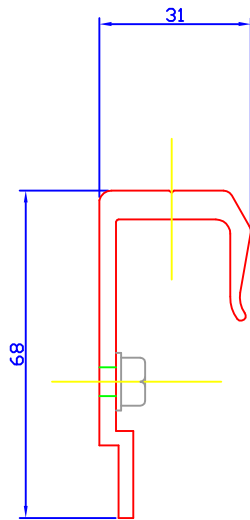

NV3 CLIP

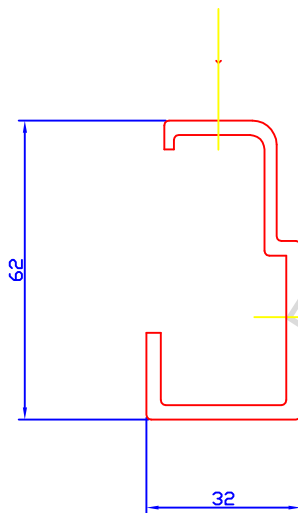

NV3 RAILS

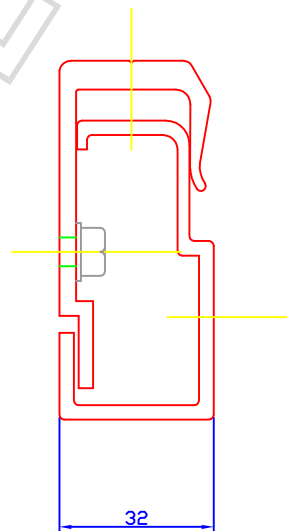

ASSEMBLY DIM