



2200

hand-drawn

for light and medium-weight curtains



**Stable track with
elegant look**





2200

hand-drawn stable & elegant

The design of the Goelst 2200 track makes it extremely stable and gives it an elegant look. It can be easily mounted in various ways on a wall or ceiling. A very popular track that can be used in a wide variety of situations, such as private homes, but also in office buildings and in the care sector.

- The ideal track for sheers and lightweight or medium-heavy curtains.
- Easy to bend and exceptional quality.
- Can be forward or reverse bent in different radii.
- Compatible with the Goelst Flow System for regularly pleated curtains.
- Silent and smooth running, also round bends.



Standard colours

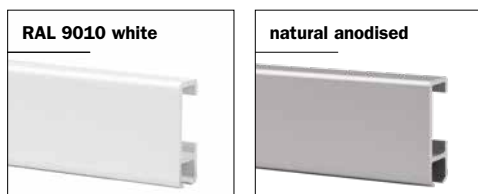

High quality, wear-resistant coating, highly colourfast, UV-resistant.
Other RAL colours & special coatings on request.

Features

Material:	aluminium
Colour:	white, natural anodised
Dimensions:	23 x 9 mm
Weight profile:	164 gr/m ¹
Mounting:	wall or ceiling

Profile specifications

Aluminium profile:

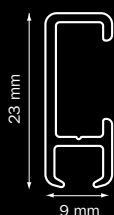

Colours with RAL code and lengths (m):

	RAL	4	5	6	7
white	9010	•	•	•	•
naturel				•	

Mounting surface:

- wood
- masonry/concrete

Bracket type:

- ceiling bracket
- wall bracket
- spacer bracket

Bending:

bending radius	bending tool
R 8 cm	1013
R 10 cm	1012
R 10 cm	1015
R > 80 cm	1018

R 10 cm

R > 80 cm

Flow

The Goelst Flow System keeps pleats in curtains consistent. It can be used with small and wide channel tracks and, because of the broad assortment of components, it can be integrated in hand-drawn, cord-pulled and electrically operated systems.

The Flow System can also be used with curved curtain tracks. For further information, see the Flow product data sheet.



Mounting

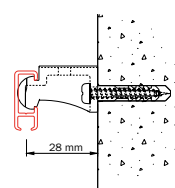

Wall mounting with 2251.

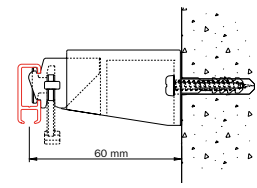

Wall mounting with 7451.

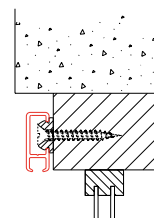

Window frame mounting with 2254.

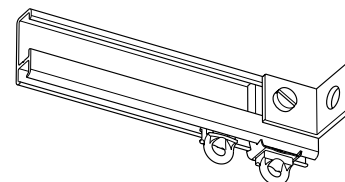

Wall mounting with 2249-N.

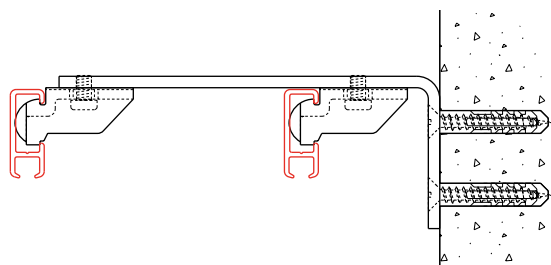

Wall mounting with 2015 wall brackets.

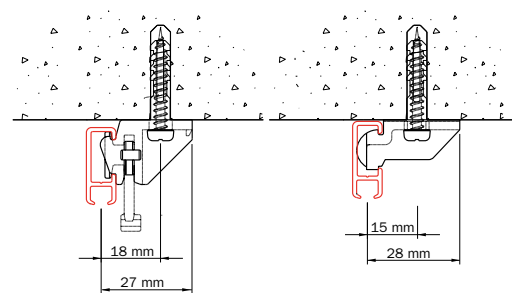

Ceiling mounting with 7450.

Ceiling mounting with 2250.

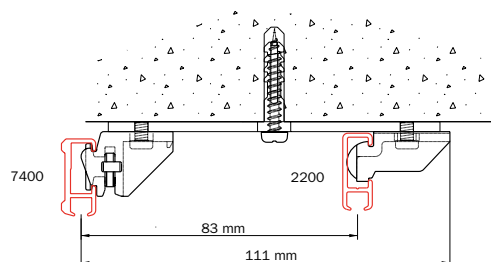

Ceiling mounting with 2216 & 7450 resp. 2250.

Mounting directions

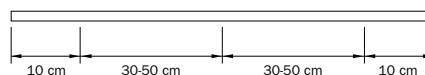

The distance between the brackets can vary depending on the following factors: the mounting surface (wood, concrete or plaster), the weight of the curtains and the curtain fabric production method, the specific application and the system usage intensity. General advice: with the curtains open, place additional brackets where the pleats bunch together. Also place additional brackets before and after bends.



Application example

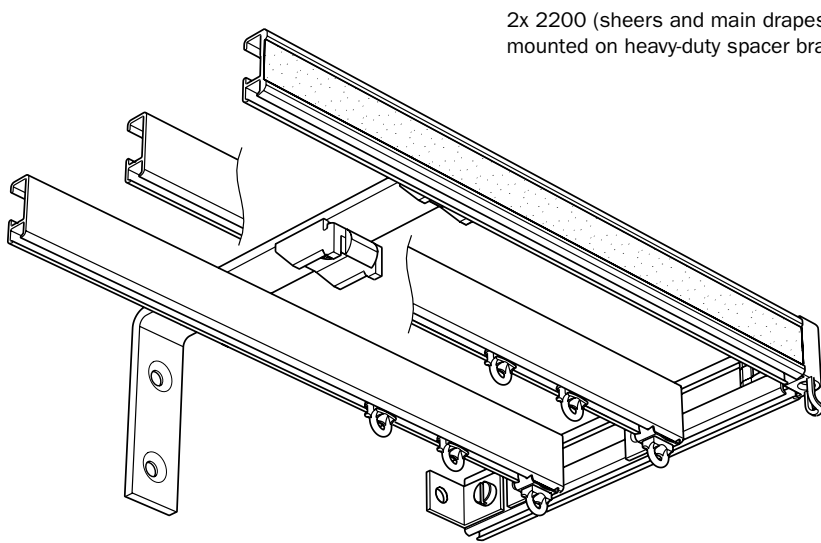

2x 2200 (sheers and main drapes) combined with 7400 (valance), mounted on heavy-duty spacer brackets 2018-15.

Specification guide

Material

- Aluminium EN AW-6060-T66.
- Anodised in accordance with the Qualanod standard.
- Powder coated in accordance with the Qualicoat standard.

Standard parts

Curtain transport



Mounting

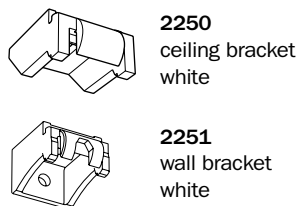

Accessories

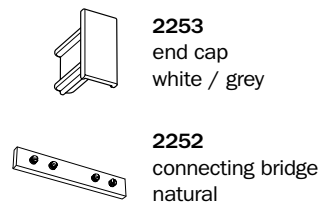

Optional parts

Curtain transport

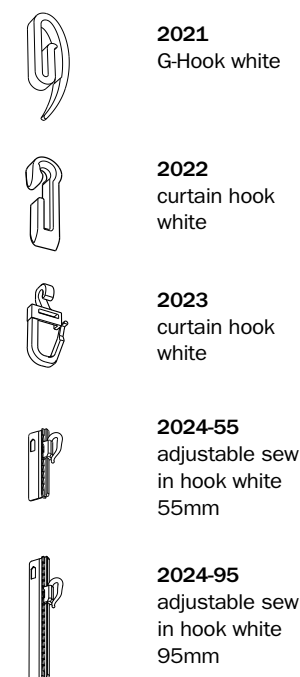
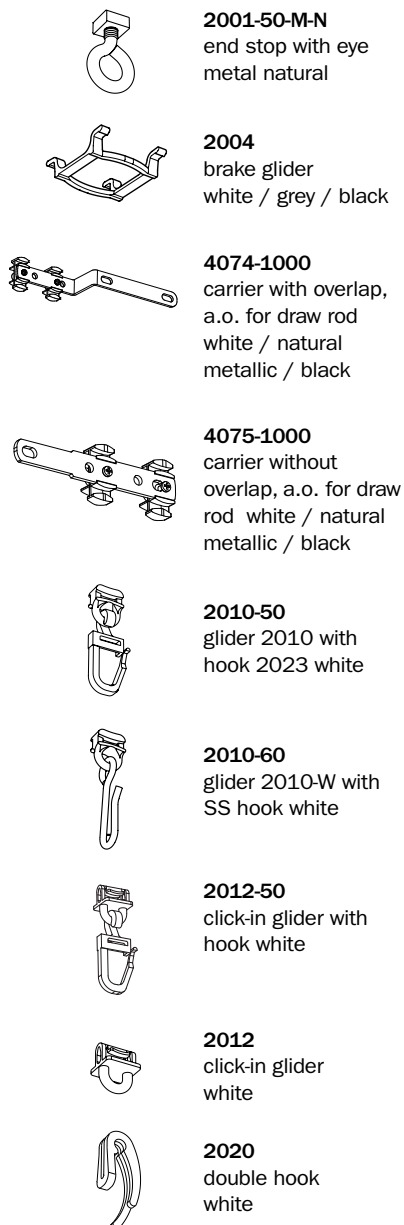

Montage

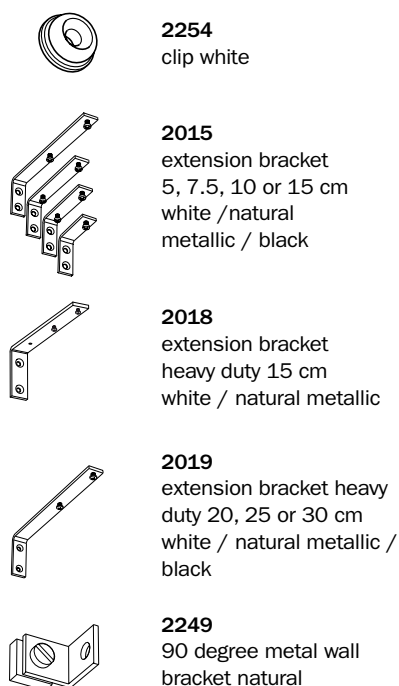
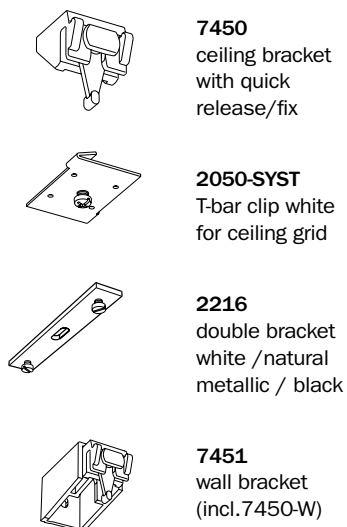

Accessoires

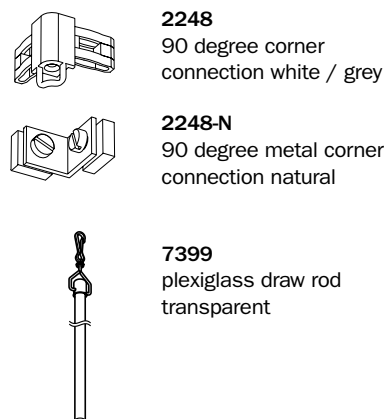



Goelst UK Ltd

Crimple Court | Hornbeam Park | Harrogate | HG2 8PB
Tel 01423 873002 | Fax 01423 874006 | info@goelstuk.com | www.goelst.co.uk