

# Ecophon Solo™ Rectangle on wall

To increase the sound absorption in the room this system gives you the possibility to install Ecophon Solo™ Rectangle on the wall. The systems give design possibilities, working with different layers and overlapping panels to create various patterns.

Two possibilities exist to fix Solo Rectangle on wall, either Connect™ Hook trim or Connect™ Distance hanger. The Solo Rectangle panel is available in size 2400x1200x40 mm with a weight of 11,5 kg. The panel is manufactured from high density glass wool utilizing the 3RD Technology, with Akutex™ FT surface on both sides. The edges are straight cut and painted.



Sweden

## SYSTEM RANGE



|                |               |
|----------------|---------------|
| Size, mm       | 2400x1200     |
| Special Fixing | •             |
| Thickness      | 40            |
| Inst. Diagr.   | M305,<br>M306 |



Solo™ panel



Installation with Connect™ Hook trim and Connect™ Panel hook

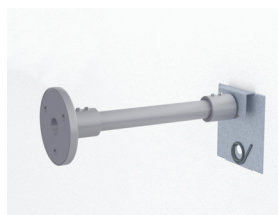

Installation with Connect™ Distance hanger and Connect™ Panel hook



Connect Spiral anchor flat as spacer when Connect™ Hook trim is used



## Acoustic

The values in the diagram refer to a single unit. If the units are arranged in a cluster with distances between units less than 0,5 meters, the Aeq per unit will be slightly reduced.

### Sound Absorption:

Test results according to EN ISO 354.

Aeq, Equivalent absorption area per unit (m² sabin)

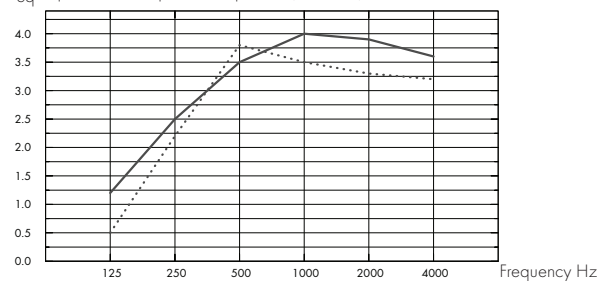

... Solo Rectangle on wall 1200x2400, 55 mm o.d.s.

– Solo Rectangle on wall 1200x2400, 165 mm o.d.s.

o.d.s = overall depth of system

| THK<br>mm | o.d.s.<br>mm | Aeq, Equivalent absorption area per unit (m² sabin) |        |        |         |         |         |
|-----------|--------------|---|--------|--------|---------|---------|---------|
|           |              | 125 Hz  | 250 Hz | 500 Hz | 1000 Hz | 2000 Hz | 4000 Hz |
| 40        | 55           | 0,50  | 2,20   | 3,80   | 3,50    | 3,30    | 3,20    |
| 40        | 165          | 1,20  | 2,50   | 3,50   | 4,00    | 3,90    | 3,60    |



## Accessibility

The tiles are demountable.



## Cleanability

Daily dusting and vacuum cleaning. Weekly wet wiping.



## Visual appearance

White Frost, nearest NCS colour sample S 0500-N, 85% light reflectance (of which more than 99% is diffuse reflection). Retro reflection coefficient 63 mcd/(m²lx). Gloss < 1.



## Influence of climate



## Indoor Climate

Certificate / Label

Europe

EN  
13501-1

M1



## Environmental influence

Certificate / Label

Europe

EN  
13501-1



Fully recyclable.



## CO<sub>2</sub>

Kg CO<sub>2</sub> equiv/m<sup>2</sup>

8,1

From EPD in conformity with ISO 14040



## Fire safety

Country

Standard

Class

Europe

EN 13501-1

A2-s1,d0

The glass wool core of the tiles is tested and classified as non-combustible according to EN ISO 1182.



## Mechanical properties

No additional live load is allowed.



## Installation

Installed according to installation diagrams, installation guides and drawing aid. For information regarding minimum overall depth of system see quantity specification.

# INSTALLATION DIAGRAM (M305) FOR ECOPHON SOLO RECTANGLE ON WALL INSTALLED HORIZONTALLY

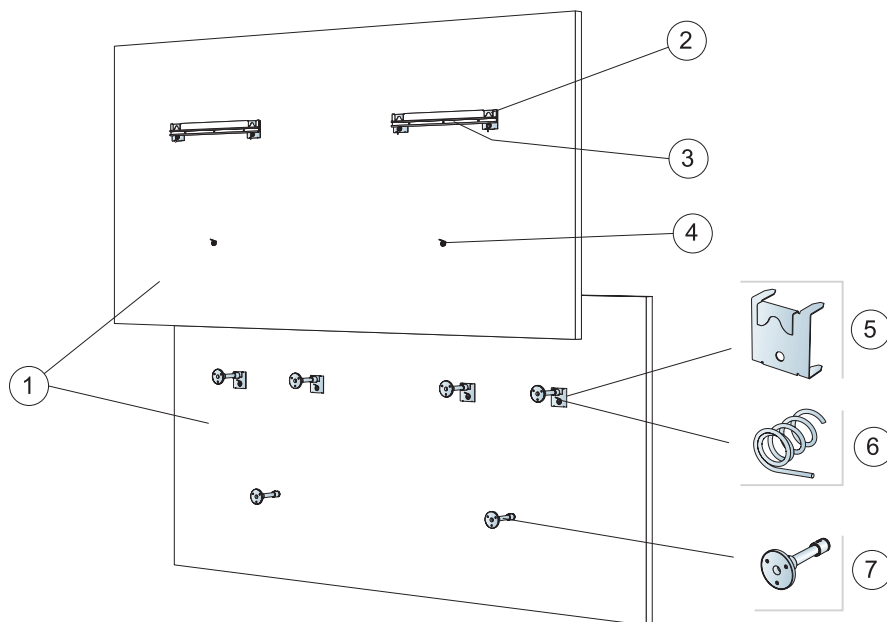

© Ecophon Group

## QUANTITY SPECIFICATION (EXCL. WASTAGE)

|   |  | Size, mm                  |
|---|--|---------------------------|
|   |  | 2400x1200                 |
| 1 | Solo Rectangle   | 2,88m <sup>2</sup> /panel |
| 2 | Alt. 1 Connect Panel hook (Connect Spiral anchor flat incl. in package)  | 4/panel                   |
| 3 | Alt. 1 Connect Hook trim (2pcs Connect Spiral anchor flat incl. in package)                                      | 2/panel                   |
| 4 | Alt. 1 Connect Spiral anchor flat, used as spacer to wall (incl. in Connect Hook trim package)                   | 2/panel                   |
| 5 | Alt. 2 Connect Panel hook (Connect Spiral anchor flat incl. in package)  | 4/panel                   |
| 6 | Alt. 2 Connect Spiral anchor flat, used to fix the panel hook in the panel (incl. in Connect Panel hook package) | 4/panel                   |
| 7 | Alt. 2 Connect Distance hanger   | 6/panel                   |

Δ Min. overall depth of system: Δ1 114 mm / Δ2 55mm

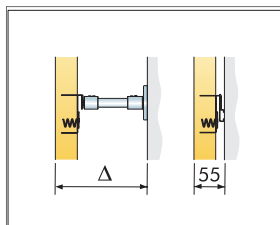

See Quantity specification

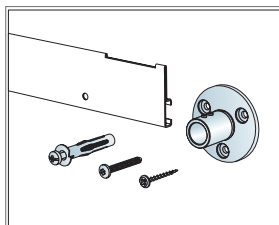

Can be used with common fixing solutions

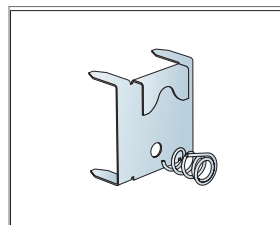

Suspension with Panel hook and Hook trim

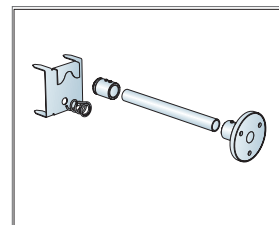

Suspension with Panel hook and Distance hanger

# INSTALLATION DIAGRAM (M306) FOR ECOPHON SOLO RECTANGLE ON WALL INSTALLED VERTICALLY

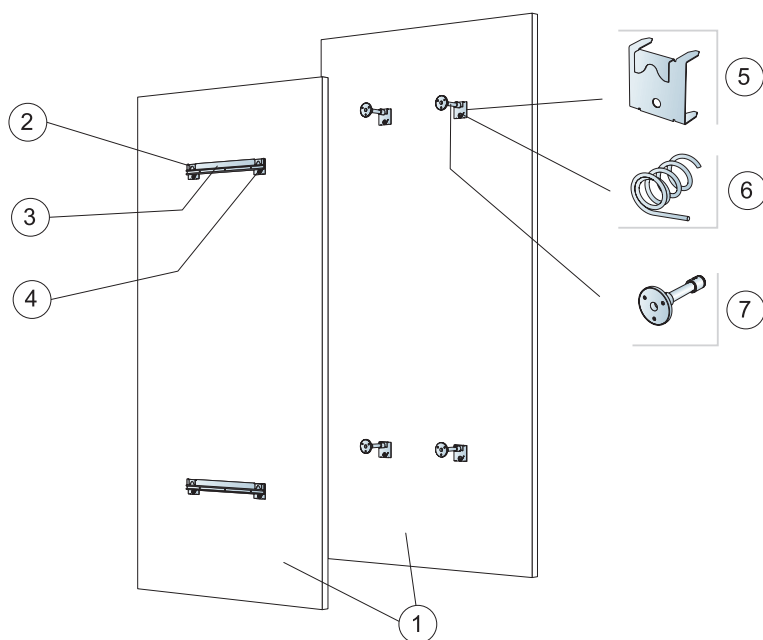

© Ecophon Group

## QUANTITY SPECIFICATION (EXCL. WASTAGE)

|   |  | Size, mm                  |
|---|--|---------------------------|
|   |  | 2400x1200                 |
| 1 | Solo Rectangle   | 2,88m <sup>2</sup> /panel |
| 2 | Alt. 1 Connect Panel hook (Connect Spiral anchor flat incl. in package)  | 4/panel                   |
| 3 | Alt. 1 Connect Hook trim (2pcs Connect Spiral anchor flat incl. in package)                                      | 2/panel                   |
| 4 | Alt. 1 Connect Spiral anchor flat (incl. in Connect Panel hook package)  | 4/panel                   |
| 5 | Alt. 2 Connect Panel hook (Connect Spiral anchor flat incl. in package)  | 4/panel                   |
| 6 | Alt. 2 Connect Spiral anchor flat, used to fix the panel hook in the panel (incl. in Connect Panel hook package) | 4/panel                   |
| 7 | Alt. 2 Connect Distance hanger   | 4/panel                   |

Δ Min. overall depth of system: Δ1 114 mm / Δ2 55mm

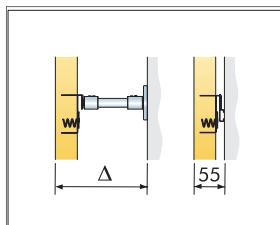

See Quantity specification

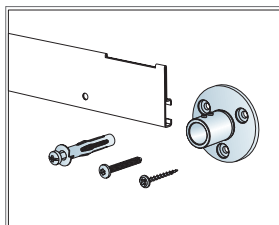

Can be used with common fixing solutions

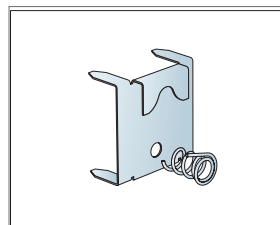

Suspension with Panel hook and Hook trim

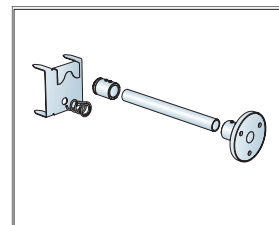

Suspension with Panel hook and Distance hanger