

Ecophon Hygiene Foodtec™ Wall C3

Ecophon Hygiene Foodtec Wall C3 is a sound-absorbing wall panel system intended for use in environments where there is risk of contamination, and where frequent cleaning is required. It is intended for use on walls above the occupied area or where there is no risk for mechanical impact. Examples of applications: the food and beverage industries, restaurants and catering kitchens.

The system consists of Ecophon Hygiene Foodtec Wall panel, which has a core of high density, 3rd generation glass wool and a painted stain protected Akutex HS surface on both sides. The edges are painted. The fixing details Connect Wall fixing C3 are made of stainless steel wire. The panel is positioned with an airgap of 40 mm to the surface

behind allowing for air to circulate and for cleaning. The weight of the system is approximately 3 kg/pcs.



TAYS kitchen, Tampere, Finland

SYSTEM RANGE



Size, mm	1200x600
Special Fixing	•
Thickness	40
Inst. Diag.	M262



Hygiene Foodtec Wall



Hygiene Foodtec Wall C3 system



Connect Wall fixing C3

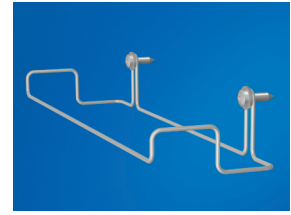

Connect Wall fixing C3



Acoustic

Sound Absorption:

Test results according to EN ISO 354. Classification according to EN ISO 11654.

α_p Practical sound absorption coefficient

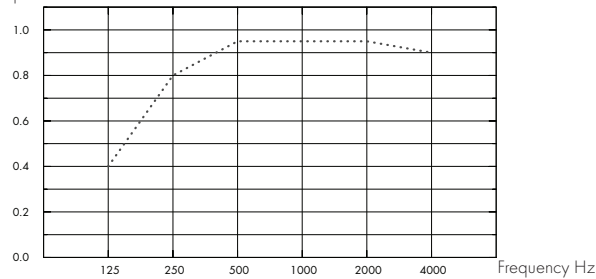

... Hygiene Foodtec Wall, 80 mm o.d.s.

o.d.s = overall depth of system

THK mm	o.d.s. mm	α_p Practical sound absorption coefficient						α_w	Sound absorption class
		125 Hz	250 Hz	500 Hz	1000 Hz	2000 Hz	4000 Hz		
40	80	0,40	0,80	0,95	0,95	0,95	0,90	0,95	A



Accessibility

The tiles are demountable.



Cleanability

Daily dusting and vacuum cleaning. Weekly wet cleaning on all surfaces and high-pressure washing twice a year. Can withstand the use of common disinfecting chemicals.



Visual appearance

White 500, nearest NCS colour sample S 0500-N, 84% light reflectance.



Influence of climate

The tiles withstand a permanent ambient RH up to 95% at 30°C without sagging, warping or delaminating (ISO 4611). A higher temperature/moisture is permissible during washing as stated above. Microbiological growth class 0 according to ASTM G 21-96. The grid and accessories meet the demands of corrosion class C3 according to EN ISO 12944-2.



Indoor Climate

Certificate / Label

Europe

EN
13501-1

Can be used in rooms classified as ISO class 4 according to ISO 14644-1.



Environmental influence

Certificate / Label

Europe

EN
13501-1

Glass wool core utilizing 3RD Technology. In combination with Master Rigid system Extra Bass is granted the Nordic Swan eco-label. Fully recyclable.



Fire safety

Country

Europe

Standard

EN 13501-1

Class

A2-s1,d0

The glass wool core of the tiles is tested and classified as non-combustible according to EN ISO 1182.



Mechanical properties

See table about Max live load and Min load bearing capacity and Functional demands, Mechanical properties at www.ecophon.com.



Installation

Installed according to installation diagrams, installation guides and drawing aid. For information regarding minimum overall depth of system see quantity specification.

INSTALLATION DIAGRAM (M262) FOR ECOPHON HYGIENE FOODTEC WALL C3

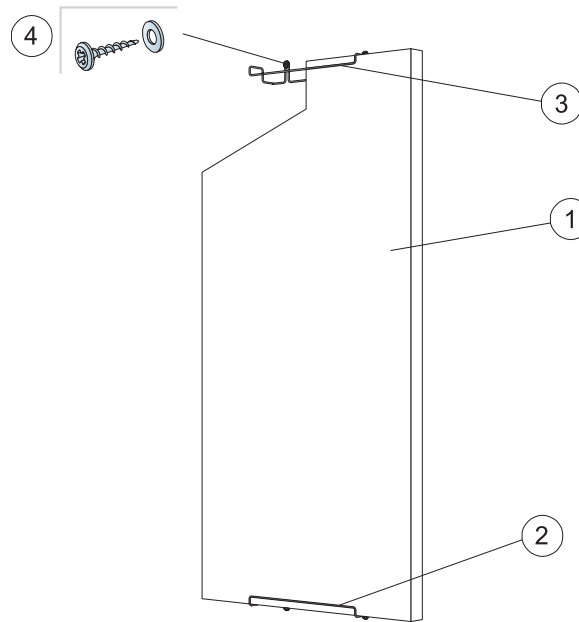

© Ecophon Group

QUANTITY SPECIFICATION (EXCL. WASTAGE)

		Size, mm
		1200x600
1	Hygiene Foodtec Wall	1,4/m ²
2	Connect Wall fixing C3, vertical installation	2/panel
3	Connect Wall fixing C3, horizontal installation	4/panel
4	Wall screw, A2 material (not supplied by Ecophon)	2/wall fixing

Δ Min. overall depth of system: 90 mm

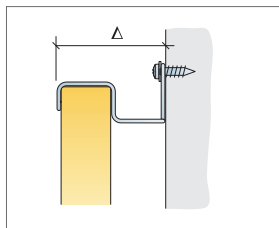

See Quantity specification

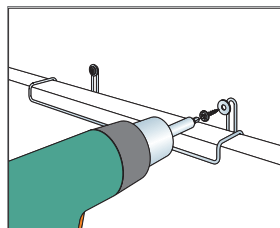

Installation with wall screw in stainless steel (A2) material

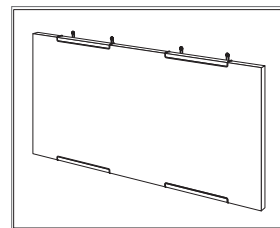

Horizontal installation of Foodtec Wall C3

Size, mm	Max live load (N)	Min load bearing capacity (N)
1200x600	0	-

Live load/load bearing capacity