

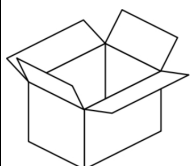

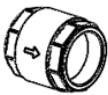

(EN) Check valve	(ES) La válvula de retención	(TR) Emniyet valfi
(DE) Rückschlagventil	(CS) Zpětný ventil	(RU) обратный клапан
(NL) Terugslagklep	(SL) Kontrolni ventil	(HU) Visszacsapó
(FR) Clapet anti-retour	(DA) Kontraventil	(PL) Zawór zwrotny
(IT) Valvola di non ritorno	(EL) βαλβίδα ελέγχου	(RO) Supapă de verificare

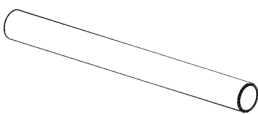

R600 EVO

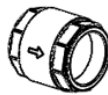
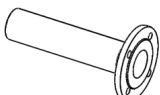

R601, R602 R603 EVO	
	
1X	1X

R605, R606 R607 EVO		
		
1X	2X	1X
		
4X	8X	4X

(EN) Check valve	(ES) La válvula de retención	(TR) Emniyet valfi
(DE) Rückschlagventil	(CS) Zpětný ventil	(RU) обратный клапан
(NL) Terugslagklep	(SL) Kontrolni ventil	(HU) Visszacsapó
(FR) Clapet anti-retour	(DA) Kontraventil	(PL) Zawór zwrotny
(IT) Valvola di non ritorno	(EL) βαλβίδα ελέγχου	(RO) Supapă de verificare

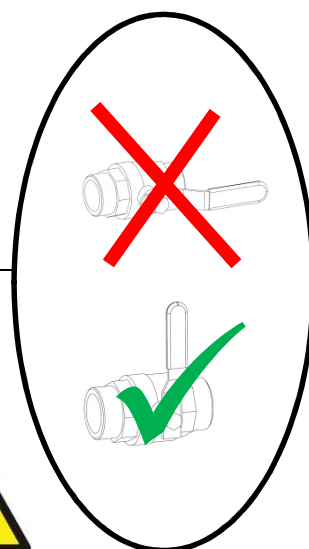
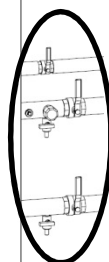
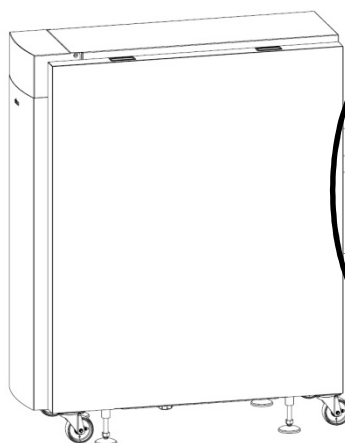

(EN) Check valve	(ES) La válvula de retención	(TR) Emniyet valfi
(DE) Rückschlagventil	(CS) Zpětný ventil	(RU) обратный клапан
(NL) Terugslagklep	(SL) Kontrolni ventil	(HU) Visszacsapó
(FR) Clapet anti-retour	(DA) Kontraventil	(PL) Zawór zwrotny
(IT) Valvola di non ritorno	(EL) βαλβίδα ελέγχου	(RO) Supapă de verificare



R 601, R 602, R 603 EVO

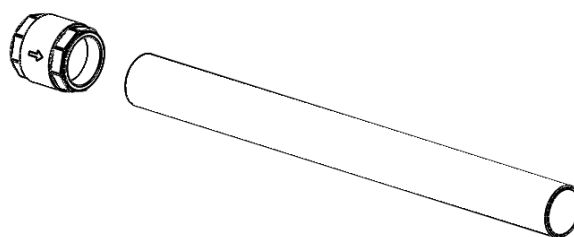
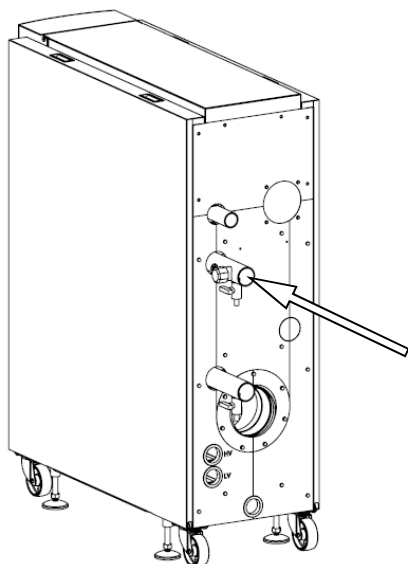

R604, R605, R606, R607 EVO

