

*ASH*

Detailed Photography

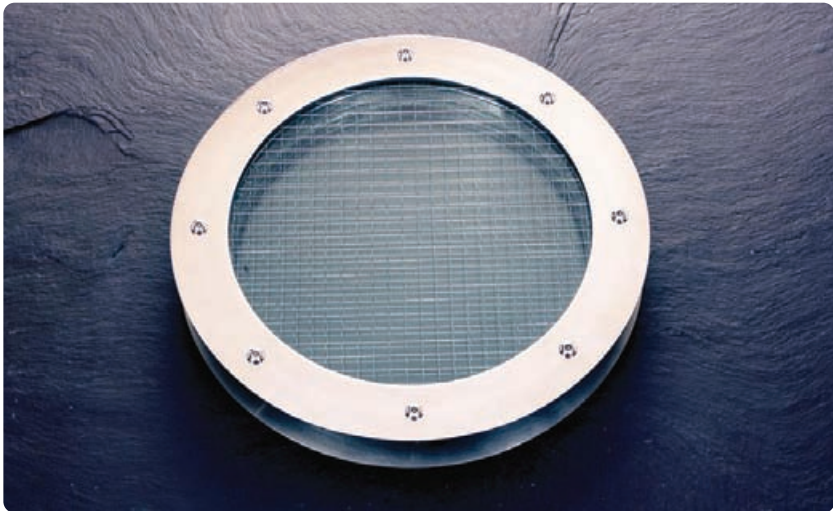

Technical Illustration

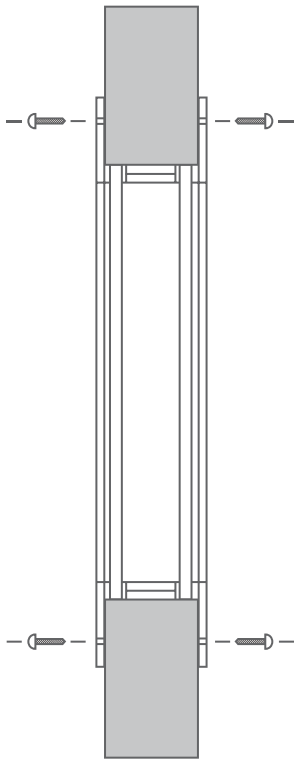
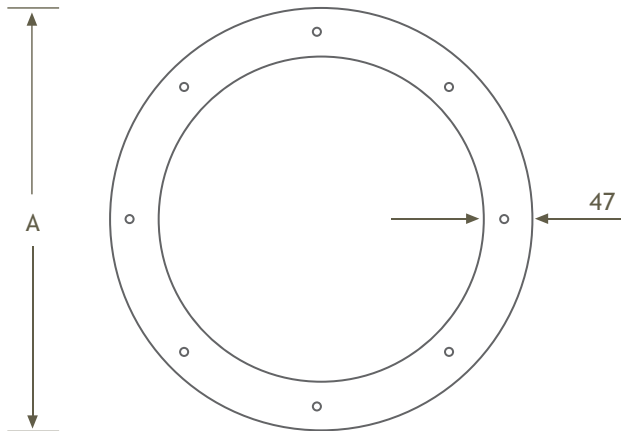

Sizes Available				Fire Protection Available		Finishes Available	
Style	A	B	C	Code	Fire Rating	Finish	Code
ASH 300X	194	NA	NA	30 FR	30 mins fire rated	Polished Copper	PC
ASH 300Y	294	NA	NA	60 FR	60 mins fire rated	Satin Copper	SC
ASH 300Z	394	NA	NA	NFR	Non fire rated	Polished Nickel Silver	PNS
						Satin Nickel Silver	SNS
						Polished Stainless	PS
						Satin Stainless	SS

\*\* Extra fixing points may be required on some sizes.  
Contact our technical department for assistance.

**Ordering Guide**  
Please use the following guide as an example when placing an order.

Style

Fire rating

Finish

ASH300X . PS . 60FR

86 Detailed Photography

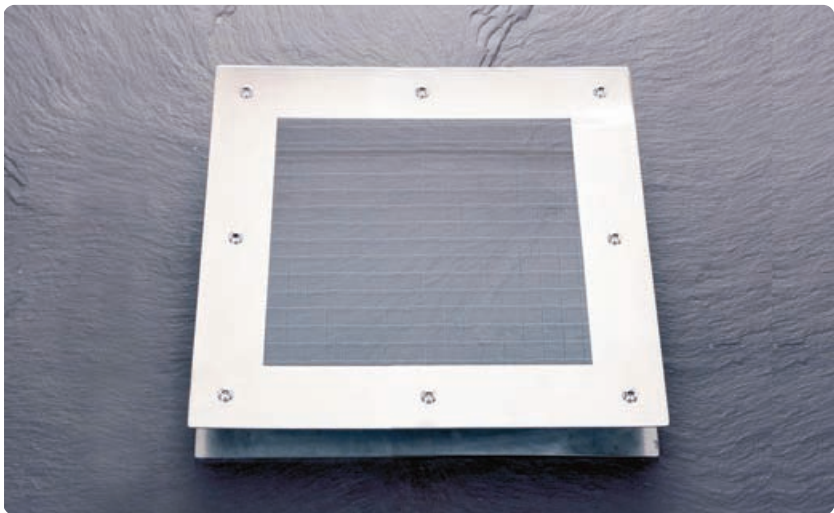

Technical Illustration

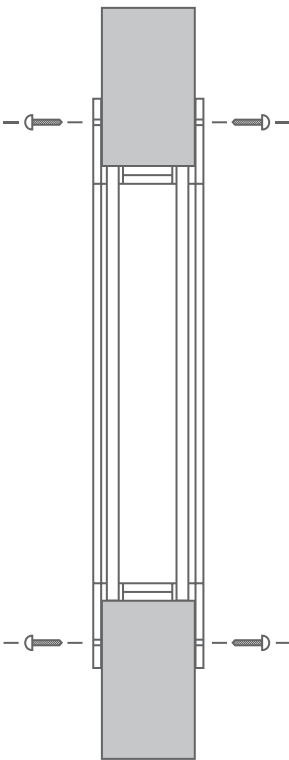
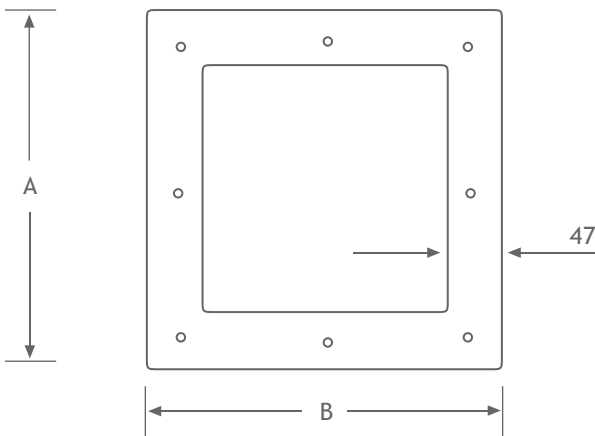

Size Available

Style	A	B	C
ASH 318	300	300	NA

Fire Protection Available

Code	Fire Rating
30 FR	30 mins fire rated
60 FR	60 mins fire rated
NFR	Non fire rated

Finishes Available

Finish	Code
Polished Copper	PC
Satin Copper	SC
Polished Nickel Silver	PNS
Satin Nickel Silver	SNS
Polished Stainless	PS
Satin Stainless	SS

\*\* Extra fixing points may be required on some sizes.  
Contact our technical department for assistance.

Ordering Guide

Please use the following guide as an example when placing an order.

Style

ASH318

.

Finish

SS

.

Fire rating

60FR

Detailed Photography



Technical Illustration

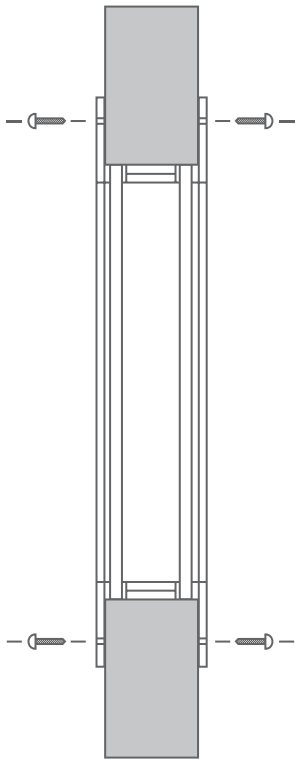
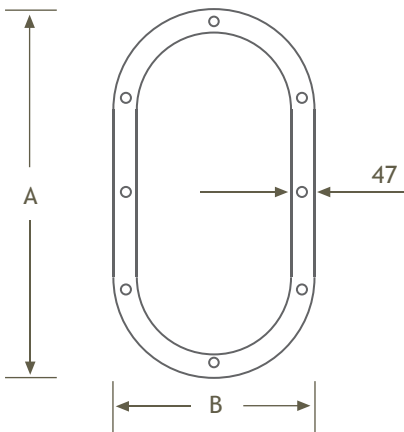

Size Available			
Style	A	B	C
ASH 320	650	280	NA

Fire Protection Available	
Code	Fire Rating
30 FR	30 mins fire rated
60 FR	60 mins fire rated
NFR	Non fire rated

Finishes Available	
Finish	Code
Polished Copper	PC
Satin Copper	SC
Polished Nickel Silver	PNS
Satin Nickel Silver	SNS
Polished Stainless	PS
Satin Stainless	SS

\*\* Extra fixing points may be required on some sizes.  
Contact our technical department for assistance.

**Ordering Guide**  
Please use the following guide as an example when placing an order.

Style

Fire rating

ASH320 . PS . 60FR

Finish



ASH700 Antimicrobial Copper Alloy Range

ASH

Technical Specification

Detailed Photography

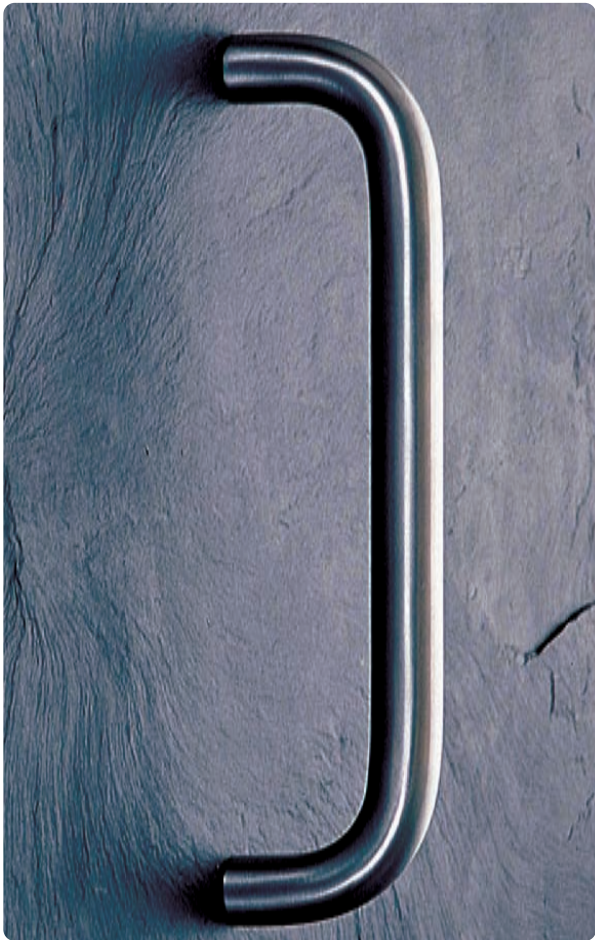

Technical Illustration

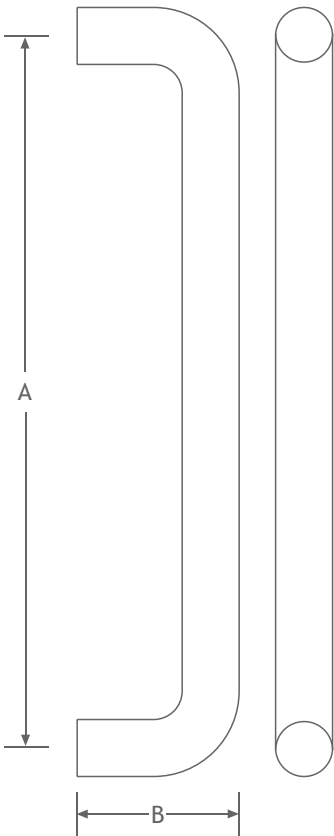

Style	Diameter ø	Centres(A)	Projection(B)	Throw(C)	Overrun(D)	Finish	Code
ASH 700	19	250 - 1250	65	-	-	Polished Copper	PCP
ASH 700	25	250 - 1500	80	-	-	Satin Copper	SCP
ASH700	32	300 - 2000	80	-	-	Polished Nickel Silver	PNS
						Satin Nickel Silver	SNS

\* Denotes not available in SAA or COL  
\*\* Extra fixing points may be required on some sizes.  
Contact our technical department for assistance.

**Ordering Guide**  
Please use the following guide as an example when placing an order.

StyleCentresFixing kit

ASH700 . (32) . 500 . PCP . F2A

DiameterFinish

# ASH703 Antimicrobial Copper Alloy Range

## Technical Specification

### Detailed Photography



### Technical Illustration

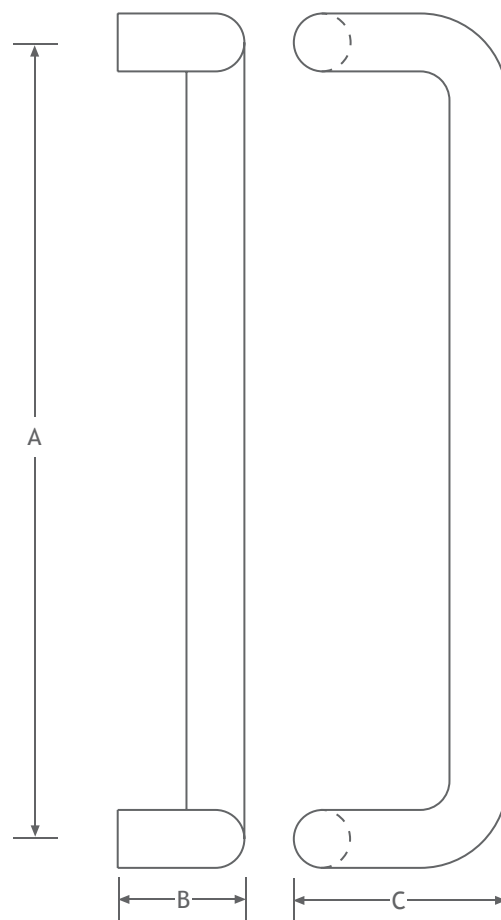

Style	Diameter $\varnothing$	Centres(A)	Projection(B)	Throw(C)	Overrun(D)	Finish	Code
ASH 703	19	250 - 1250	65	75	-	Polished Copper	PCP
ASH 703	25	250 - 1500	80	130	-	Satin Copper	SCP
ASH 703	32	250 - 2000	80	150	-	Polished Nickel Silver	PNS
						Satin Nickel Silver	SNS

\* Denotes not available in SAA or COL

\*\* Extra fixing points may be required on some sizes.  
Contact our technical department for assistance.

### Ordering Guide

Please use the following guide as an example when placing an order.

Style Centres Fixing kit  
ASH703 . (32) . 500 . PCP . F2A  
Diameter Finish

ASH 703

More ordering and fixing information can be found at the back of this catalogue

ASH709 Antimicrobial Copper Alloy Range

ASH

Technical Specification

Detailed Photography



Technical Illustration

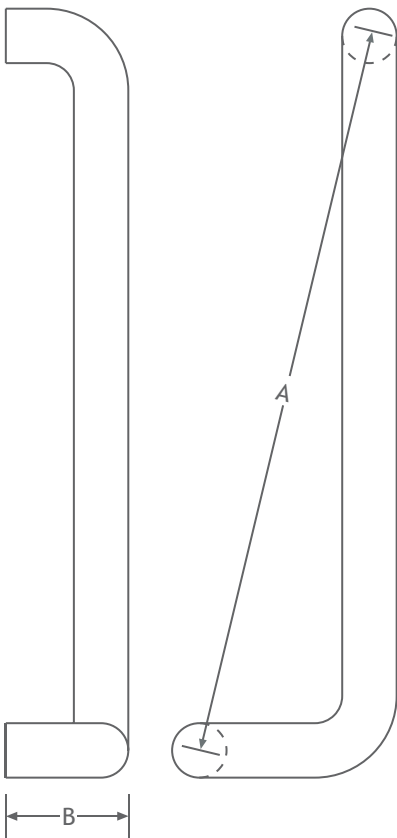

Style	Diameter $\varnothing$	Centres(A)	Projection(B)	Throw(C)	Overrun(D)	Finish	Code
ASH 709	19**	300 - 500	65	NA	NA	Polished Copper	PCP
ASH 709	25**	300 - 500	80	NA	NA	Satin Copper	SCP
ASH 709	32**	300 - 1000	80	NA	NA	Polished Nickel Silver	PNS
						Satin Nickel Silver	SNS

\* Denotes not available in SAA or COL  
\*\* Extra fixing points may be required on some sizes.  
Contact our technical department for assistance.

**Ordering Guide**  
Please use the following guide as an example when placing an order.

StyleCentresFixing kit

ASH709 . (32) . 300 . PCP . F2A

DiameterFinish



# ASH712 Standard Range



## Technical Specification

### Detailed Photography



### Technical Illustration

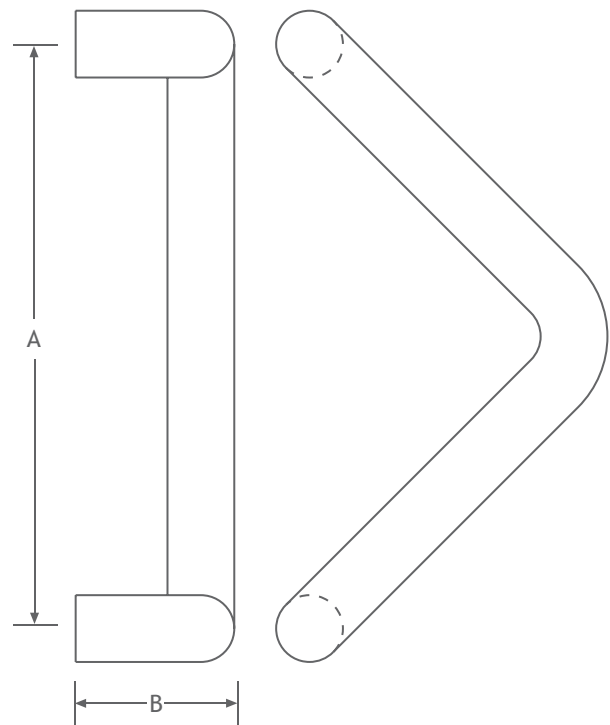

Style	Diameter $\varnothing$	Centres(A)	Projection(B)	Throw(C)	Overrun(D)	Finish	Code
ASH 712	19	250 - 300	65	NA	NA	Polished Copper	PCP
ASH 712	25	250 - 350	80	NA	NA	Satin Copper	SCP
ASH 712	32	250 - 400	80	NA	NA	Polished Nickel Silver	PNS
						Satin Nickel Silver	SNS

\* Denotes not available in SAA or COL

\*\* Extra fixing points may be required on some sizes.  
Contact our technical department for assistance.

### Ordering Guide

Please use the following guide as an example when placing an order.

Style

Centres

Fixing kit

ASH712 . (32) . 300 . PCP . F2A

Diameter

Finish

ASH715 Antimicrobial Copper Alloy Range

ASH

Technical Specification

Detailed Photography



Technical Illustration

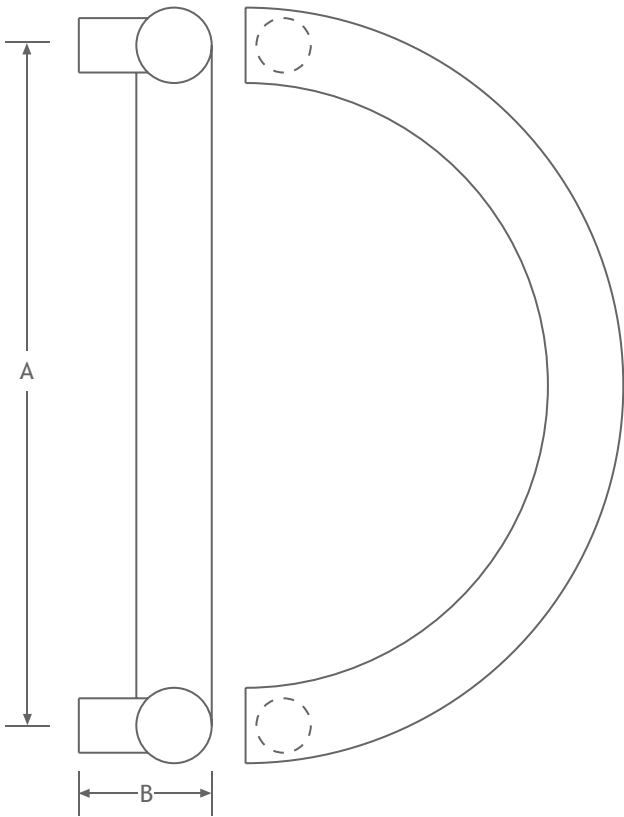

Style	Diameter ø	Centres(A)	Projection(B)	Throw(C)	Overrun(D)	Finish	Code
ASH 715	19	250 - 300	65	NA	NA	Polished Copper	PCP
ASH 715	25	250 - 450	80	NA	NA	Satin Copper	SCP
ASH 715	32	300 - 500	80	NA	NA	Polished Nickel Silver	PNS
						Satin Nickel Silver	SNS

\* Denotes not available in SAA or COL  
\*\* Extra fixing points may be required on some sizes.  
Contact our technical department for assistance.

**Ordering Guide**  
Please use the following guide as an example when placing an order.

StyleCentresFixing kit

ASH715 . (32) . 400 . PCP . F2A

DiameterFinish

# ASH718 Antimicrobial Copper Alloy Range



## Technical Specification

### Detailed Photography

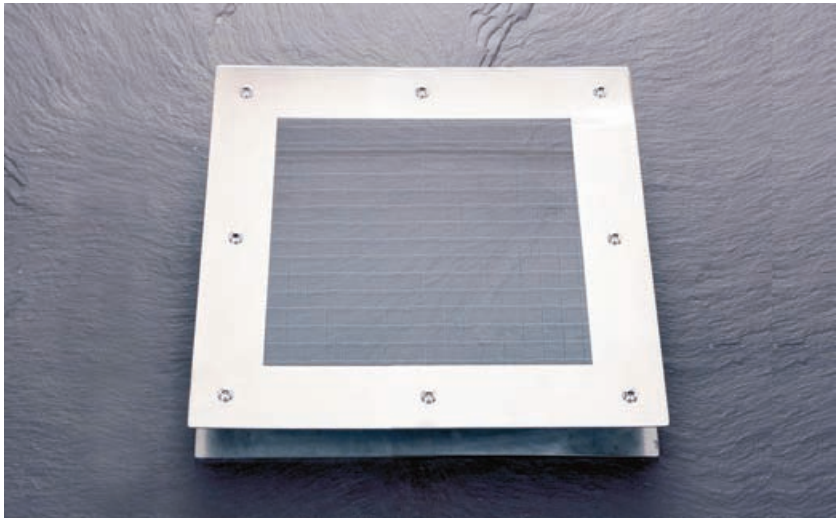

### Technical Illustration

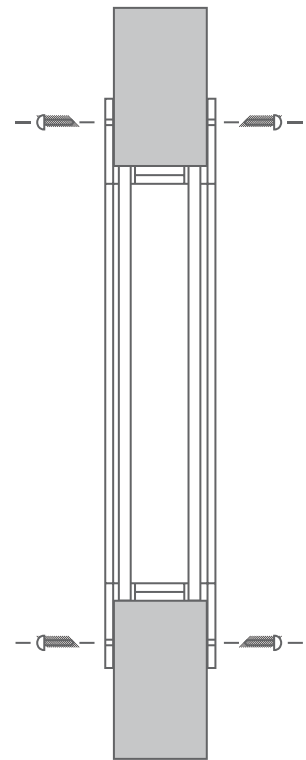
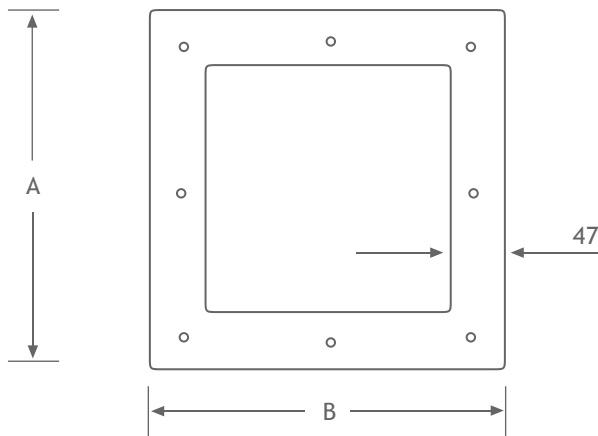

#### Size Available

Style	A	B	C
ASH 718	300	300	NA

#### Fire Protection Available

Code	Fire Rating
30 FR	30 mins fire rated
60 FR	60 mins fire rated
NFR	Non fire rated

#### Finishes Available

Finish	Code
Polished Copper	PCP
Satin Copper	SCP
Polished Nickel Silver	PNS
Satin Nickel Silver	SNS

\*\* Extra fixing points may be required on some sizes.  
Contact our technical department for assistance.

### Ordering Guide

Please use the following guide as an example when placing an order.

Style			Fire rating	
ASH718	.	PCP	.	60FR
				Finish



# ASH721 Standard Range



## Technical Specification

### Detailed Photography



### Technical Illustration

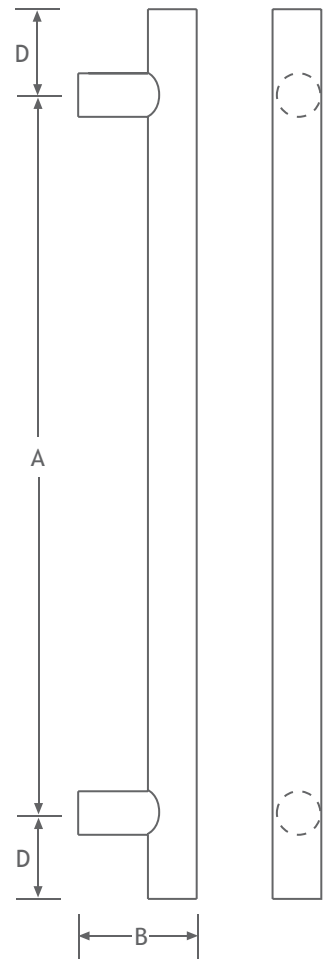

Style	Diameter $\varnothing$	Centres(A)	Projection(B)	Throw(C)	Overrun(D)	Finish	Code
ASH 721	19	up to 1250	65	NA	85	Polished Copper	PCP
ASH 721	25	up to 1500	65	NA	85	Satin Copper	SCP
ASH 721	32	up to 2100	80	NA	85	Polished Nickel Silver	PNS
						Satin Nickel Silver	SNS

\* Denotes not available in SAA or COL  
\*\* Extra fixing points may be required on some sizes.  
Contact our technical department for assistance.

### Ordering Guide

Please use the following guide as an example when placing an order.

Style Centres Fixing kit  
ASH721 . (32) . 1500 . PCP . F2A  
Diameter Finish

ASH 721

More ordering and fixing information can be found at the back of this catalogue

# ASH728 Standard Range



## Technical Specification

### Detailed Photography



### Technical Illustration

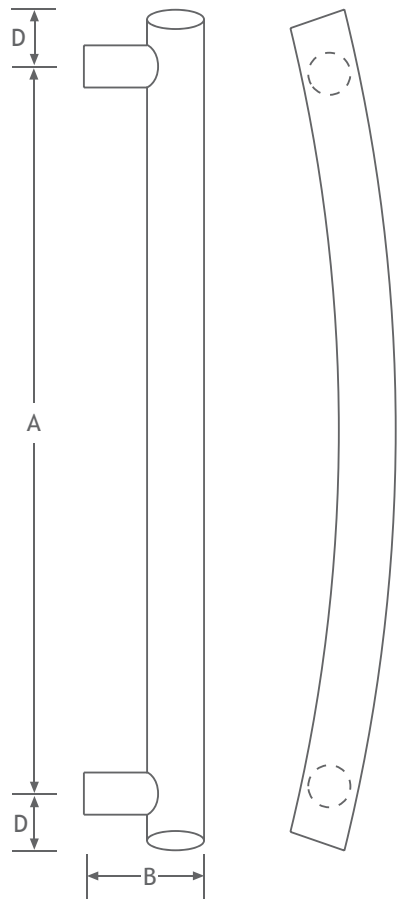

Style	Diameter $\varnothing$	Centres(A)	Projection(B)	Throw(C)	Overrun(D)	Finish	Code
ASH 728	19	250 - 1250	65	NA	20	Polished Copper	PCP
ASH 728	25	250 - 1500	65	NA	20	Satin Copper	SCP
ASH 728	32	250 - 2000	80	NA	20	Polished Nickel Silver	PNS
						Satin Nickel Silver	SNS

\* Denotes not available in SAA or COL  
\*\* Extra fixing points may be required on some sizes.  
Contact our technical department for assistance.

### Ordering Guide

Please use the following guide as an example when placing an order.

Style

Centres

Fixing kit

ASH728 . (32) . 400 . PCP . F2A

Diameter

Finish

More ordering and fixing information can be found at the back of this catalogue

ASH 728