



# 1. Geberit Mepla

<b>1.1</b>	<b>Preliminary remarks.....</b>	<b>6</b>
	Application overview: Geberit Mepla.....	9
<b>1.2</b>	<b>System pipes, drinking water, ML.....</b>	<b>10</b>
<b>1.3</b>	<b>System pipes, heating, ML.....</b>	<b>11</b>
<b>1.4</b>	<b>Fittings .....</b>	<b>13</b>
1.4.1	Couplings .....	13
1.4.2	Reducers.....	14
1.4.3	Elbows .....	15
1.4.4	T-pieces.....	16
1.4.5	Adaptors, permanent.....	18
1.4.6	Adaptors and connections, detachable.....	22
1.4.7	Sealings.....	30
1.4.8	Connections .....	31
1.4.9	Manifolds with threaded connection.....	39
1.4.10	T-pieces for heating .....	41
1.4.11	Connections for heating.....	41
<b>1.5</b>	<b>Accessories.....</b>	<b>46</b>
1.5.1	Insulations for pipes and fittings.....	46
1.5.2	Insulations for connectors.....	47
1.5.3	Caulks for pipes and fittings .....	48
1.5.4	Caulks for connections.....	48
1.5.5	Pipe covers.....	48
1.5.6	Pipe fastenings.....	49
1.5.7	Connector fastenings .....	53
1.5.8	System seals.....	55
1.5.9	Sets of bolts for flange connections .....	56
<b>1.6</b>	<b>Appendix.....</b>	<b>57</b>
1.6.1	Abbreviation .....	57
1.6.2	Sales und delivery conditions .....	58
1.6.3	Index.....	61

## 1.1 Preliminary remarks

### Introduction to Geberit Mepla

The Geberit Mepla multilayer pipe system combines the characteristics of synthetic product materials with those of metals in an extraordinary way.

The multilayer pipe, which consists of a plastic inner pipe, an aluminium pipe and a protective plastic layer on the outside, allows for easy, safe and flexible processing, whilst also complying with high hygiene standards.

The fittings made of PVDF and gunmetal or brass ensure a high degree of safety during processing as well as reliable tightness. These characteristics make Geberit Mepla especially suited to potable water supply and radiator connections.

Thanks to the pressing technology, installations can be carried out reliably and quickly without complex welding and soldering.

### Benefits of Geberit Mepla

#### Quick

Lower labour costs in comparison to conventional connection technology

#### Clean

Clean installation using the Geberit pressing technology.  
No consumables required.

#### Safe

No danger of fire as no welding or soldering necessary  
Unpressed connections are easily identified

#### Economical

No consumables such as oxygen or gas required

#### Simple

Simple connection technology

#### Stable

The aluminium layer ensures a high level of stability and extraordinary mechanical strength

#### Flexible

16 and 20mm pipes can be bent by hand, reducing the number of fittings required

#### Experienced

More than 30 years of practical experience in pressing technology

### Always consider

#### The 4 stage pressing process

- Cut, deburr and calibrate the pipe
- Prepare the fitting
- Insert the fitting into the pipe
- Press with the appropriate jaw or collar

Check you are using the correct material for the required application. See page x for an in depth overview of the applications for Geberit Mepla

Only Geberit Mepla system pipes are suitable to press Geberit Mepla fittings. To adapt to Geberit Mapress pipes, use the Geberit Mepla to Mapress adapter. To adapt to other materials please use a threaded adapter.

#### Use the correct tooling

Always check that you are using the correct tools, this can be checked in the Geberit Tooling Product Guide and Price List.

Make sure that the tools you are using are in a good condition and are calibrated. There should be a sticker on the tool, jaws, collars and adapters to tell you when the tool next needs calibrating. Go to [www.geberit.co.uk/toolservice](http://www.geberit.co.uk/toolservice) to find your nearest tool service agent.

If you require any technical assistance, please contact the technical department on 01926 516800, or email [technical@geberit.co.uk](mailto:technical@geberit.co.uk).





## Application overview: Geberit Mepla

Geberit Great Britain, version: January 2016

Application purposes	Operating temperature	Maximum operating pressure	Pipes	
			Mepla, ML	MeplaTherm, ML, NPW
<b>Liquid media</b>				
For cold and hot potable water	0-70 °C <sup>1)</sup>	10 bar / 1000 kPa	✓	
For cold potable water	0-20 °C <sup>2)</sup>	16 bar / 1600 kPa	✓	
For heating water	0-80 °C <sup>3)</sup>	10 bar / 1000 kPa	✓	✓
For cooling water without antifreeze agent	0-70 °C	10 bar / 1000 kPa	✓	✓
For cooling water with antifreeze agent	-10 – +40 °C	10 bar / 1000 kPa	✓	✓
For service water	0-40 °C	10 bar / 1000 kPa	✓	✓
For ultrapure water (except pharmaceutical water)	0-40 °C	10 bar / 1000 kPa	✓	✓
For rainwater with a pH value of > 6.0	0-40 °C	10 bar / 1000 kPa	✓	✓
For salt water	0-70 °C	10 bar / 1000 kPa	✓	✓
For extinguishing water (wet)	0-70 °C	10 bar / 1000 kPa	✓	✓
For extinguishing water (wet/dry, dry)	0-70 °C	10 bar / 1000 kPa	✓	✓
For chemicals and technical liquids	Upon request	Upon request	✓ <sup>4)</sup>	✓ <sup>4)</sup>
<b>Gaseous media</b>				
For compressed air (oil purity class 0-3)	0-70 °C	10 bar / 1000 kPa	✓	✓
For negative pressure	0-40 °C	Abs. ≥ 0,2 bar / 20 kPa	✓	✓
For inert gases (e.g. nitrogen)	0-40 °C	10 bar / 1000 kPa	✓	✓

✓ Application generally approved if the defined additional requirements are met in accordance with the footnotes

<sup>1)</sup> Malfunction temperature in accordance with EN 806-2: T<sub>mal</sub> = 95 °C, total 100 h over the course of the service life

<sup>2)</sup> Exclusive MeplaFix

<sup>3)</sup> Malfunction temperature in accordance with ISO 10508:2006: T<sub>mal</sub> = 100 °C, total 100 h over the course of the service life

<sup>4)</sup> After Geberit approval

<sup>5)</sup> Only use approved inhibitors

<sup>6)</sup> Only use approved antifreeze agents

<sup>7)</sup> Oil purity class in accordance with ISO 8573-1:2010E; for details on moisture and particles, see technical information "Geberit Piping Systems for Compressed Air Installations"

	Fittings				O-rings	Flat gaskets for screw connections	Flange gaskets
	PVDF	Gunmetal	Brass	Stainless steel	EPDM, black	Centellen® R 3825	Centellen® 3822
	✓	✓	✓	✓	✓	✓	✓
	✓	✓	✓		✓	✓	✓
	✓	✓	✓	✓	✓ <sup>5)</sup>	✓	✓
	✓	✓	✓	✓	✓	✓	✓
	✓	✓	✓	✓	✓ <sup>6)</sup>	✓	✓
	✓	✓		✓	✓ <sup>4)</sup>	✓	✓
	✓			✓	✓	✓	✓
	✓	✓		✓	✓	✓	✓
	✓	✓	✓	✓	✓	✓	✓
	✓	✓	✓	✓	✓	✓	✓
	✓ <sup>4)</sup>	✓ <sup>4)</sup>	✓ <sup>4)</sup>	✓ <sup>4)</sup>	✓ <sup>4)</sup>	✓ <sup>4)</sup>	✓ <sup>4)</sup>
	✓	✓	✓	✓	✓ <sup>7)</sup>	✓	✓
	✓	✓	✓	✓	✓	✓	✓
	✓	✓	✓	✓	✓	✓	✓

## 1.2 System pipes, drinking water, ML

### Geberit Mepla system pipe, ML

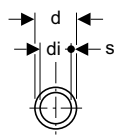
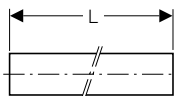

#### Application purposes

- For technical building systems, industry and shipbuilding
- Application overview: Geberit Mepla → p. 9

#### Characteristics

- Inherently stable
- Forms a barrier against diffusion
- Black exterior
- Pipe end with transparent protection plug

#### Technical data

Material	PE-RT II / AI / PE-RT II
Surface roughness	7 µm
Thermal expansion	0.026 mm/(m · K)
Thermal conductivity, pipe	0.43 W/(m · K)

Art. no.	DN	d, Ø [mm]	di, Ø [mm]	s [mm]	L [m]	SU4 [m]	SU3 [m]	SU2 [m]	GBP/m
601.100.00.1	12	16	11.5	2.25	5	4440	120	5	2.68
602.100.00.1	15	20	15	2.5	5	3360	120	5	3.66
603.100.00.1	20	26	20	3	5	2760	120	5	6.07
604.100.00.1	25	32	26	3	5	2000	50	5	8.02
605.100.00.1	32	40	33	3.5	5	1400	50	5	14.30
606.100.00.1	40	50	42	4	5	750	50	5	17.52
607.100.00.1	50	63	54	4.5	5	500	25	5	25.60
608.100.00.1	65	75	65.8	4.7	5	300	25	5	43.99

#### Accessories

- Geberit insulation hose → p. 46

### Geberit Mepla system pipe, ML

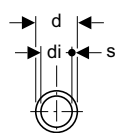
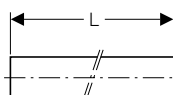

#### Application purposes

- For technical building systems, industry and shipbuilding
- Application overview: Geberit Mepla → p. 9

#### Characteristics

- Inherently stable
- Can be bent by hand
- Forms a barrier against diffusion
- Black exterior
- Pipe end with transparent protection plug

#### Technical data

Material	PE-RT II / AI / PE-RT II
Surface roughness	7 µm
Thermal expansion	0.026 mm/(m · K)
Thermal conductivity, pipe	0.43 W/(m · K)

Art. no.	DN	d, Ø [mm]	di, Ø [mm]	s [mm]	L [m]	SU4 [m]	SU2 [m]	GBP/m
601.130.00.1	12	16	11.5	2.25	50	500	50	2.11

Art. no.	DN	d, Ø [mm]	di, Ø [mm]	s [mm]	L [m]	SU4 [m]	SU2 [m]	GBP/m
601.130.00.2	12	16	11.5	2.25	100	1000	100	2.11
602.130.00.1	15	20	15	2.5	50	500	50	2.87
602.130.00.2	15	20	15	2.5	100	600	100	2.87
603.110.00.1	20	26	20	3	50	250	50	5.00

#### Accessories

- Geberit insulation hose → p. 46

### Geberit Mepla system pipe, ML, in protective tube

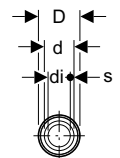
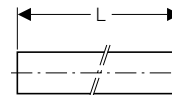

#### Application purposes

- For technical building systems, industry and shipbuilding
- Application overview: Geberit Mepla → p. 9

#### Characteristics

- Inherently stable
- Can be bent by hand
- Media pipe forms a barrier against diffusion
- Media pipe, black exterior
- Pipe end with transparent protection plug

#### Technical data

Material	PE-RT II / AI / PE-RT II
Surface roughness	7 µm
Thermal expansion	0.026 mm/(m · K)
Thermal conductivity, pipe	0.43 W/(m · K)

Art. no.	DN	d, Ø [mm]	di, Ø [mm]	D [cm]	s [mm]	L [m]	SU4 [m]	SU2 [m]	GBP/m
601.131.00.2	12	16	11.5	2.7	2.25	50	500	50	2.56
602.131.00.2	15	20	15	3.1	2.5	50	300	50	3.54

### Geberit Mepla system pipe, ML, with circular pre-insulation

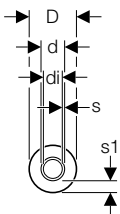
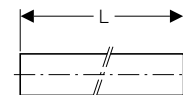

#### Application purposes

- For technical building systems, industry and shipbuilding
- Application overview: Geberit Mepla → p. 9

#### Characteristics

- Inherently stable
- Can be bent by hand
- Media pipe forms a barrier against diffusion
- Media pipe, black exterior
- Closed-cell insulation, blue protective foil
- Pipe end with transparent protection plug

#### Technical data

Material	PE-RT II / AI / PE-RT II
Surface roughness	7 µm
Thermal expansion	0.026 mm/(m · K)
Thermal conductivity, pipe	0.43 W/(m · K)
Material, insulation	PE soft foam
Thermal conductivity, insulation	0.04 W/(m · K)
Water vapour diffusion resistance, outer skin of insulation	7000 µ

Art. no.	DN	d, ø [mm]	di, ø [mm]	D [cm]	s [mm]	s1 [mm]	L [m]	SU4 [m]	SU2 [m]	GBP/m
601.132.00.1	12	16	11.5	2.8	2.25	6	50	250	50	3.27
601.135.00.1	12	16	11.5	3.6	2.25	10	50	200	50	3.62
601.136.00.1	12	16	11.5	4.2	2.25	13	50	200	50	4.58
602.132.00.1	15	20	15	3.2	2.5	6	50	250	50	4.10
602.135.00.1	15	20	15	4	2.5	10	50	200	50	4.62
602.136.00.1	15	20	15	4.6	2.5	13	50	150	50	5.86
603.132.00.1	20	26	20	3.8	3	6	25	125	25	6.86
603.135.00.1	20	26	20	4.6	3	10	25	100	25	7.61
603.136.00.1	20	26	20	5.2	3	13	25	100	25	8.57

#### Geberit Mepla system pipe, ML, with circular pre-insulation

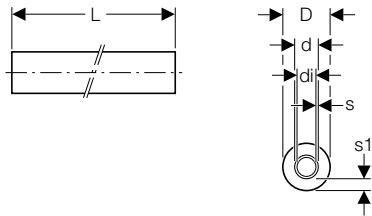

#### Application purposes

- For technical building systems, industry and shipbuilding
- Application overview: Geberit Mepla → p. 9

#### Characteristics

- Inherently stable
- Can be bent by hand
- Media pipe forms a barrier against diffusion
- Media pipe, black exterior
- Closed-cell insulation, red protective foil
- Pipe end with transparent protection plug

#### Technical data

Material	PE-RT II / AI / PE-RT II
Surface roughness	7 µm
Thermal expansion	0.026 mm/(m · K)
Thermal conductivity, pipe	0.43 W/(m · K)
Material, insulation	PE soft foam
Thermal conductivity, insulation	0.04 W/(m · K)
Water vapour diffusion resistance, outer skin of insulation	7000 µ

Art. no.	DN	d, ø [mm]	di, ø [mm]	D [cm]	s [mm]	s1 [mm]	L [m]	SU4 [m]	SU2 [m]	GBP/m
601.134.00.1	12	16	11.5	2.8	2.25	6	50	250	50	3.25
602.134.00.1	15	20	15	3.2	2.5	6	50	250	50	4.09
603.134.00.1	20	26	20	3.8	3	6	25	125	25	7.21

## 1.3 System pipes, heating, ML

### Geberit Mepla system pipe, ML, NPW, MeplaTherm

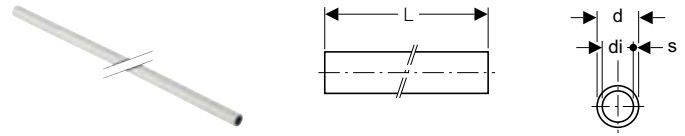

#### Application purposes

- For technical building systems, industry and shipbuilding
- Application overview: Geberit Mepla → p. 9

#### Characteristics

- Inherently stable
- Forms a barrier against diffusion
- White exterior
- Pipe end with transparent protection plug

#### Technical data

Material	PE-RT II / AI / PE-RT II
Surface roughness	7 µm
Thermal expansion	0.026 mm/(m · K)
Thermal conductivity, pipe	0.43 W/(m · K)

Art. no.	DN	d, ø [mm]	di, ø [mm]	s [mm]	L [m]	SU4 [m]	SU3 [m]	SU2 [m]	GBP/m
601.200.00.1	12	16	11.5	2.25	5	4440	120	5	2.19
602.200.00.1	15	20	15	2.5	5	3360	120	5	3.10
603.200.00.1	20	26	20	3	5	2760	120	5	4.24

#### Accessories

- Geberit insulation hose → p. 46

## Geberit Mepla system pipe, ML, NPW, MeplaTherm

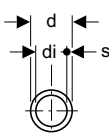
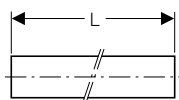

### Application purposes

- For technical building systems, industry and shipbuilding
- Application overview: Geberit Mepla → p. 9

### Characteristics

- Inherently stable
- Can be bent by hand
- Forms a barrier against diffusion
- White exterior
- Pipe end with transparent protection plug

### Technical data

Material	PE-RT II / Al / PE-RT II
Surface roughness	7 µm
Thermal expansion	0.026 mm/(m · K)
Thermal conductivity, pipe	0.43 W/(m · K)

Art. no.	DN	d, ø [mm]	di, ø [mm]	s [mm]	L [m]	SU4 [m]	SU2 [m]	GBP/m
601.230.00.1	12	16	11.5	2.25	100	1000	100	1.77
601.230.00.2	12	16	11.5	2.25	200	1200	200	1.85
602.230.00.1	15	20	15	2.5	100	600	100	2.41
603.230.00.1	20	26	20	3	50	250	50	3.19

## Geberit Mepla system pipe, ML, NPW, MeplaTherm, in protective tube

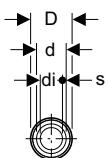
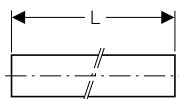

### Application purposes

- For technical building systems, industry and shipbuilding
- Application overview: Geberit Mepla → p. 9

### Characteristics

- Inherently stable
- Can be bent by hand
- Media pipe forms a barrier against diffusion
- Media pipe, white exterior
- Ice blue protective tube
- Pipe end with transparent protection plug

### Technical data

Material	PE-RT II / Al / PE-RT II
Surface roughness	7 µm
Thermal expansion	0.026 mm/(m · K)
Thermal conductivity, pipe	0.43 W/(m · K)

Art. no.	DN	d, ø [mm]	di, ø [mm]	D [cm]	s [mm]	L [m]	SU4 [m]	SU2 [m]	GBP/m
601.231.00.2	12	16	11.5	2.7	2.25	50	500	50	1.92
602.231.00.2	15	20	15	3.1	2.5	50	300	50	2.56

## Geberit Mepla system pipe, ML, NPW, MeplaTherm, with circular pre-insulation

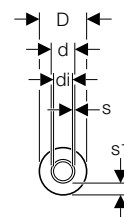
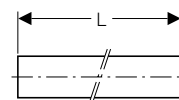

### Application purposes

- For technical building systems, industry and shipbuilding
- Application overview: Geberit Mepla → p. 9

### Characteristics

- Inherently stable
- Can be bent by hand
- Media pipe forms a barrier against diffusion
- Media pipe, white exterior
- Closed-cell insulation, red protective foil
- Pipe end with transparent protection plug

### Technical data

Material	PE-RT II / Al / PE-RT II
Surface roughness	7 µm
Thermal expansion	0.026 mm/(m · K)
Thermal conductivity, pipe	0.43 W/(m · K)
Material, insulation	PE soft foam
Thermal conductivity, insulation	0.04 W/(m · K)
Water vapour diffusion resistance, outer skin of insulation	7000 µ

Art. no.	DN	d, ø [mm]	di, ø [mm]	D [cm]	s [mm]	s1 [mm]	L [m]	SU4 [m]	SU2 [m]	GBP/m
601.232.00.1	12	16	11.5	2.8	2.25	6	50	250	50	2.56
601.235.00.1	12	16	11.5	3.6	2.25	10	50	200	50	3.09
602.232.00.1	15	20	15	3.2	2.5	6	50	250	50	3.62
602.235.00.1	15	20	15	4	2.5	10	50	200	50	4.25
603.232.00.1	20	26	20	3.8	3	6	25	125	25	6.50
603.235.00.1	20	26	20	4.6	3	10	25	100	25	7.11

## 1.4 Fittings

### 1.4.1 Couplings

#### Geberit Mepla coupling

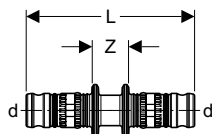

##### Application purposes

- For technical building systems, industry and shipbuilding
- Application overview: Geberit Mepla → p. 9

##### Characteristics

- Leaky if unpressed
- O-ring made of EPDM
- Pressing nipple with transparent protective cap

##### Technical data

Material		PVDF							
Art. no.	DN	d, ø [mm]	L [cm]	Z [cm]	SU4 [pc.]	SU3 [pc.]	SU2 [pc.]	SU1 [pc.]	GBP/ pc.
621.505.00.5	12	16	6.8	1.6		140	10	1	2.59
622.505.00.5	15	20	7.3	1.6	6400	100	10		3.48
623.505.00.5	20	26	7.9	1.4		70	10		5.41
624.505.00.5	25	32	9	1.4	2560	40	10		7.88
625.505.00.5	32	40	10.4	1.7		20	5		14.67
626.505.00.5	40	50	11.7	1.8		15	5		18.85
627.505.00.5	50	63	15.6	2	640	10		1	37.72
628.505.00.5	65	75	19.5	2.1	256	4		1	62.88

#### Geberit Mepla long coupling

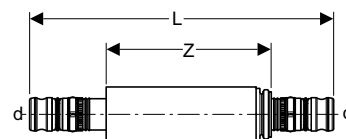

##### Application purposes

- For creating additional connections in existing pipelines
- For connecting prefabricated pipe sections with length compensation
- For technical building systems, industry and shipbuilding
- For repairing damaged Geberit Mepla system pipes, ML
- Application overview: Geberit Mepla → p. 9

##### Characteristics

- Leaky if unpressed
- O-ring made of EPDM
- Pressing nipple with transparent protective cap

##### Technical data

Material		Gunmetal (CuSn5Zn5Pb2-C)							
Art. no.	DN	d, ø [mm]	L [cm]	Z [cm]	SU3 [pc.]	SU2 [pc.]	SU1 [pc.]	GBP/pc.	
601.575.00.5	12	16	12.3	6.6	25	5	1	25.16	
602.575.00.5	15	20	13.4	7.3	25	5	1	27.35	
603.575.00.5	20	26	15.3	8.2	25	5	1	29.38	
604.575.00.5	25	32	14.2	7.5	20	5	1	36.13	
605.575.00.5	32	40	16.8	8.7	10	5	1	50.35	
606.575.00.5	40	50	18.8	9.3	10		1	71.94	

## 1.4.2 Reducers

### Geberit Mepla reducer

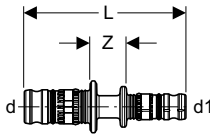

#### Application purposes

- For technical building systems, industry and shipbuilding
- Application overview: Geberit Mepla → p. 9

#### Characteristics

- Leaky if unpressed
- O-ring made of EPDM
- Pressing nipple with transparent protective cap

#### Technical data

Material						PVDF				
Art. no.	DN	d, $\varnothing$ [mm]	d1, $\varnothing$ [mm]	L [cm]	Z [cm]	SU4 [pc.]	SU3 [pc.]	SU2 [pc.]	SU1 [pc.]	GBP/pc.
622.650.00.5	15 / 12	20	16	7.1	1.6		100	10		3.36
623.650.00.5	20 / 12	26	16	7.5	1.6		70	10		5.23
623.651.00.5	20 / 15	26	20	7.8	1.6		80	10		5.23
624.651.00.5	25 / 15	32	20	8.5	1.8	3200	50	10		8.39
624.652.00.5	25 / 20	32	26	8.5	1.4		50	10		8.39
625.651.00.5	32 / 15	40	20	9	1.8		40	5		14.67
625.652.00.5	32 / 20	40	26	9.2	1.5		40	5		14.67
625.653.00.5	32 / 25	40	32	9.7	1.5		30	5		14.67
626.652.00.5	40 / 25	50	32	10.3	1.5		20	5		16.78
626.653.00.5	40 / 32	50	40	11.1	1.7		20	5		16.78
627.653.00.5	50 / 32	63	40	13.1	1.9	640	10		1	34.57
627.654.00.5	50 / 40	63	50	13.7	2	640	10		1	34.57
628.653.00.5	65 / 32	75	40	15.2	2.1	384	6		1	48.20
628.654.00.5	65 / 40	75	50	15.8	2.1	384	6		1	48.20
628.655.00.5	65 / 50	75	63	17.6	2.1	384	6		1	48.20

### 1.4.3 Elbows

#### Geberit Mepla elbow 45°

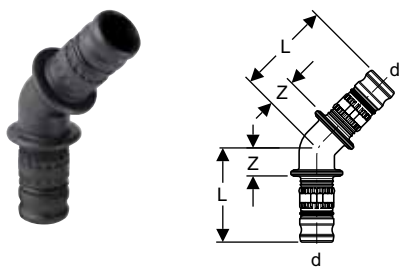

**Application purposes**

- For technical building systems, industry and shipbuilding
- Application overview: Geberit Mepla → p. 9

**Characteristics**

- Leaky if unpressed
- O-ring made of EPDM
- Pressing nipple with transparent protective cap

**Technical data**

Material										PVDF
Art. no.	DN	d, ø [mm]	L [cm]	Z [cm]	SU4 [pc.]	SU3 [pc.]	SU2 [pc.]	SU1 [pc.]	GBP/pc.	
623.245.00.5	20	26	4.8	1.5		50	10		8.89	
624.245.00.5	25	32	5.5	1.8		30	10		10.45	
625.245.00.5	32	40	6.5	2.2		20	5		20.42	
626.245.00.5	40	50	7.4	2.5		35	5		24.09	
627.245.00.5	50	63	9.5	2.8	360	15		1	51.35	
628.245.00.5	65	75	11.6	2.9	192	8		1	76.51	

#### Geberit Mepla elbow 90°

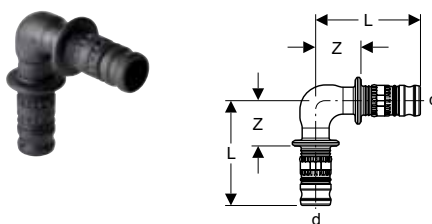

**Application purposes**

- For technical building systems, industry and shipbuilding
- Application overview: Geberit Mepla → p. 9

**Characteristics**

- Leaky if unpressed
- O-ring made of EPDM
- Pressing nipple with transparent protective cap

**Technical data**

Material		PVDF								
Art. no.	DN	d, ø [mm]	L [cm]	Z [cm]	SU4 [pc.]	SU3 [pc.]	SU2 [pc.]	SU1 [pc.]	GBP/pc.	
621.271.00.5	12	16	4.4	1.8		100	10		3.36	
622.271.00.5	15	20	5.1	2.2	6400	100	10		3.87	
623.271.00.5	20	26	5.5	2.2	3200	50	10		5.55	
624.271.00.5	25	32	6.4	2.6	2400	100	10		8.39	
625.271.00.5	32	40	7.6	3.2		50	10		17.80	
626.271.00.5	40	50	8.8	3.8	720	30	5		23.06	
627.271.00.5	50	63	12	4.8	360	15		1	41.93	
628.271.00.5	65	75	14.6	5.9	256	4		1	66.02	

## 1.4.4 T-pieces

### Geberit Mepla T-piece, equal

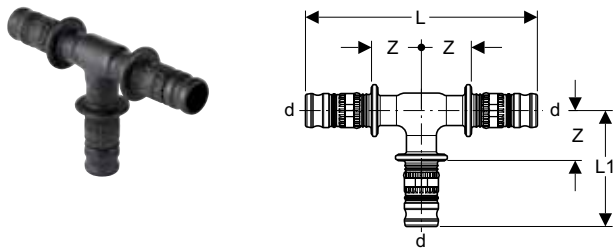

#### Application purposes

- For technical building systems, industry and shipbuilding
- Application overview: Geberit Mepla → p. 9

#### Characteristics

- Leaky if unpressed
- O-ring made of EPDM
- Pressing nipple with transparent protective cap

#### Technical data

Material						PVDF				
Art. no.	DN	d, $\varnothing$ [mm]	L [cm]	L1 [cm]	Z [cm]	SU4 [pc.]	SU3 [pc.]	SU2 [pc.]	SU1 [pc.]	GBP/pc.
621.310.00.5	12	16	9.6	4.8	2.2	4480	70	10		5.90
622.310.00.5	15	20	10.1	5.1	2.2	3200	50	10		6.18
623.310.00.5	20	26	11	5.5	2.2	2560	40	10		9.95
624.310.00.5	25	32	12.8	6.4	2.6		60	10		15.71
625.310.00.5	32	40	15.2	7.6	3.2	720	30	5		25.15
626.310.00.5	40	50	17.6	8.8	3.8	480	20	5		30.37
627.310.00.5	50	63	23.2	11.6	4.8	240	10		1	49.26
628.310.00.5	65	75	29.3	14.6	5.9	144	6		1	94.32

## Geberit Mepla T-piece, reduced

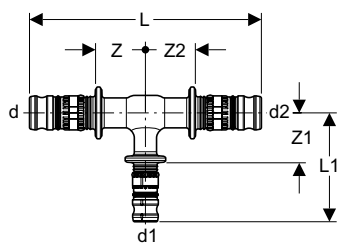

### Application purposes

- For technical building systems, industry and shipbuilding
- Application overview: Geberit Mepla → p. 9

### Characteristics

- Leaky if unpressed
- O-ring made of EPDM
- Pressing nipple with transparent protective cap

### Technical data

Material	PVDF
----------	------

Art. no.	DN	d, ø [mm]	d1, ø [mm]	d2, ø [mm]	L [cm]	L1 [cm]	Z [cm]	Z1 [cm]	Z2 [cm]	SU4 [pc.]	SU3 [pc.]	SU2 [pc.]	SU1 [pc.]	GBP/pc.
622.313.00.5	12 / 15 / 12	16	20	16	9.6	5.1	2.2	2.2	2.2		70	10		6.44
622.314.00.5	15 / 12 / 12	20	16	16	9.9	4.8	2.2	2.2	2.2	5120	80	10		6.18
622.311.00.5	15 / 12 / 15	20	16	20	10.1	4.8	2.2	2.2	2.2		50	10		6.18
622.312.00.5	15 / 15 / 12	20	20	16	9.9	5.1	2.2	2.2	2.2		70	10		6.18
623.318.00.5	15 / 20 / 15	20	26	20	11.3	5.5	2.8	2.2	2.8	2560	40	10		6.18
623.311.00.5	20 / 12 / 20	26	16	26	10	5.2	1.7	2.6	1.7	3200	50	10		7.88
623.317.00.5	20 / 15 / 15	26	20	20	10.9	5.7	2.2	2.8	2.5	2560	40	10		7.88
623.315.00.5	20 / 15 / 20	26	20	26	11	5.7	2.2	2.8	2.2	2560	40	10		7.88
623.316.00.5	20 / 20 / 15	26	26	20	11.5	5.8	2.2	2.2	2.8	2560	40	10		7.88
624.311.00.5	25 / 12 / 25	32	16	32	11.6	5.5	2	2.9	2		30	10		12.97
624.314.00.5	25 / 15 / 20	32	20	26	11.5	6	2.2	3.1	2.2		30	10		12.97
624.317.00.5	25 / 15 / 25	32	20	32	11.6	6	2	3.1	2		30	10		12.97
624.316.00.5	25 / 20 / 20	32	26	26	11.7	5.9	2.3	2.6	2.3		30	10		12.97
624.319.00.5	25 / 20 / 25	32	26	32	12.2	5.9	2.3	2.6	2.3	1280	20	10		12.97
625.317.00.5	32 / 15 / 32	40	20	40	13.2	6.4	2.2	3.5	2.2	960	15	5		23.71
625.319.00.5	32 / 20 / 32	40	26	40	13.8	6.5	2.5	3.2	2.5	960	40	5		23.71
625.321.00.5	32 / 25 / 32	40	32	40	14.4	7.2	2.8	3.2	2.8	840	35	5		23.71
626.317.00.5	40 / 20 / 40	50	26	50	15.4	7.1	2.7	3.8	2.7	600	25	5		25.96
626.319.00.5	40 / 25 / 40	50	32	50	16	7.6	3	3.8	3	480	20	5		25.96
626.320.00.5	40 / 32 / 32	50	40	40	16.2	8.2	3.4	3.8	3.4	480	20	5		25.96
626.321.00.5	40 / 32 / 40	50	40	50	16.8	8.2	3.4	3.8	3.4	320	20	5		25.96
627.316.00.5	50 / 20 / 50	63	26	63	19.2	7.9	2.8	4.6	2.8	320	5		1	43.86
627.320.00.5	50 / 25 / 50	63	32	63	19.8	8.6	3.1	4.8	3.1	320	5		1	43.86
627.321.00.5	50 / 32 / 50	63	40	63	20.8	9.2	3.6	4.8	3.6	320	5		1	43.86
627.322.00.5	50 / 40 / 50	63	50	63	22	9.8	4.2	4.8	4.2	360	15		1	43.86
628.316.00.5	65 / 20 / 65	75	26	75	23.5	8.9	3.1	5.5	3.1	144	6		1	89.74
628.320.00.5	65 / 25 / 65	75	32	75	24	8.8	3.3	5	3.3	144	6		1	89.74
628.321.00.5	65 / 32 / 65	75	40	75	24.9	9.9	3.7	5.5	3.7	144	6		1	89.74
628.322.00.5	65 / 40 / 65	75	50	75	25.9	10.8	4.2	5.8	4.2	144	6		1	89.74
628.323.00.5	65 / 50 / 65	75	63	75	27.7	12.7	5.2	6	5.2	144	6		1	89.74

## Geberit Mepla T-piece with female thread

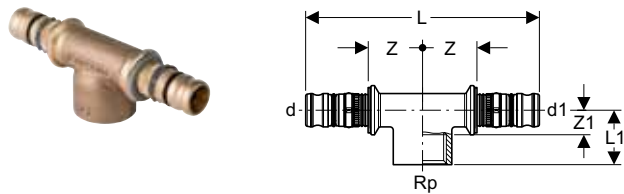

### Application purposes

- For technical building systems, industry and shipbuilding
- Application overview: Geberit Mepla → p. 9

### Characteristics

- Leaky if unpressed
- O-ring made of EPDM
- Pressing nipple with transparent protective cap

### Technical data

Material	Gunmetal (CuSn5Zn5Pb2-C)
----------	--------------------------

Art. no.	DN	d, ø [mm]	Rp [°]	d1, ø [mm]	L [cm]	L1 [cm]	Z [cm]	Z1 [cm]	SU4 [pc.]	SU3 [pc.]	SU2 [pc.]	SU1 [pc.]	GBP/pc.
601.360.00.5	12 / 1/2 / 12	16	1/2	16	9.8	2.4	2.4	0.9	1600	50	10	1	15.67
602.360.00.5	15 / 1/2 / 15	20	1/2	20	10.3	2.4	2.4	1.1		50	10		15.80
603.360.00.5	20 / 1/2 / 20	26	1/2	26	11.2	2.6	2.4	1.3		25	5		16.71
603.362.00.5	20 / 3/4 / 20	26	3/4	26	11.8	2.8	2.7	1.4		25	5		16.71
604.360.00.5	25 / 1/2 / 25	32	1/2	32	10.6	3	2.5	1.7		25	5		22.32
604.362.00.5	25 / 3/4 / 25	32	3/4	32	11.2	3.1	2.8	1.7		25	5		22.32
604.363.00.5	25 / 1 / 25	32	1	32	12	3.5	3.2	1.8		25	5		22.32
605.360.00.5	32 / 1/2 / 32	40	1/2	40	12	3.2	2.6	1.7		25	5		22.40
605.363.00.5	32 / 1 / 32	40	1	40	13.2	3.8	3.2	2.1		25	5		22.40
605.364.00.5	32 / 1 1/4 / 32	40	1 1/4	40	14.4	4	3.8	2.1			5	1	22.40
606.361.00.5	40 / 1/2 / 40	50	1/2	50	13.2	3.8	2.8	2.3		10		1	37.32
606.363.00.5	40 / 1 / 40	50	1	50	14.6	4.4	3.5	2.5	180	10	2		37.32
606.360.00.5	40 / 1 1/2 / 40	50	1 1/2	50	16.6	4.5	4.5	2.6	180	10	2		37.32
607.360.00.5	50 / 1/2 / 50	63	1/2	63	19.2	4.2	2.9	2.7			5	1	104.48
607.363.00.5	50 / 1 / 50	63	1	63	20.6	4.8	3.6	2.9	90		5	1	104.48
607.366.00.5	50 / 2 / 50	63	2	63	23.8	5.7	5.2	3.1	90		5	1	104.48
608.363.00.5	65 / 1 / 65	75	1	75	26.1	5.1	4.4	2.9	144			1	159.74

## 1.4.5 Adaptors, permanent

### Geberit adaptor MeplaFix with male thread



### Application purposes

- For technical building systems, industry and shipbuilding
- Application overview: Geberit Mepla → p. 9

### Characteristics

- Male thread for connection of Geberit MeplaFix adaptor
- MeplaFix connection with blue protective cap

### Technical data

Material	Gunmetal (CuSn5Zn5Pb2-C)
----------	--------------------------

Art. no.	DN	R [°]	R1 [°]	H [cm]	SU2 [pc.]	SU1 [pc.]	GBP/pc.
632.007.00.1	15	1/2	MF 1/2	4.2	10	1	7.50
632.008.00.1	15 / 20	3/4	MF 1/2	4.2	10	1	10.24

N: New, available as of April 2016

### Geberit adaptor MeplaFix with male thread



### Application purposes

- For technical building systems, industry and shipbuilding
- Application overview: Geberit Mepla → p. 9

### Characteristics

- Male thread for connection of Geberit MeplaFix adaptor
- MeplaFix connection with blue protective cap

### Technical data

Material	CrNiMo steel 1.4401 (EN 10088)
----------	--------------------------------

Art. no.	DN	R [°]	R1 [°]	H [cm]	SU1 [pc.]	GBP/pc.
632.005.00.1	15	1/2	MF 1/2	4.2	1	20.31

## Geberit adaptor MeplaFix with male thread

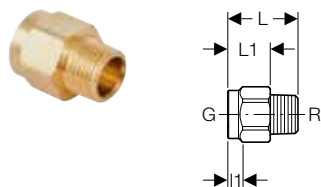

### Application purposes

- For technical building systems, industry and shipbuilding
- Application overview: Geberit Mepla → p. 9

### Characteristics

- Male thread for connection of Geberit MeplaFix adaptor
- MeplaFix connection with blue protective cap
- Flat gasket made of Centellen® R 3825

### Technical data

Material		Gunmetal (CuSn5Zn5Pb2-C)								
Art. no.	DN	R	G	L	L1	I1	SU3	SU2	GBP/pc.	
		["]	["]	[cm]	[cm]	[cm]	[pc.]	[pc.]	[pc.]	[pc.]
632.006.00.1	15	MF 1/2	1/2	3.8	2.3	0.8	50	10	5.09	

## Geberit Mepla adaptor to Geberit Mapress, with plain end

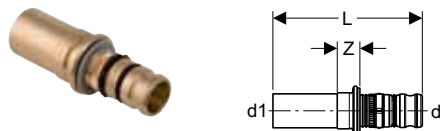

### Application purposes

- Suitable exclusively for pressing in Geberit Mapress pressing sockets
- For technical building systems, industry and shipbuilding
- Application overview: Geberit Mepla → p. 9

### Characteristics

- Leaky if unpressed
- O-ring made of EPDM
- Pressing nipple with transparent protective cap

### Technical data

Material		Gunmetal (CuSn5Zn5Pb2-C)								
Art. no.	DN	d, ø	d1, ø	L	Z	SU4	SU3	SU2	SU1	GBP/pc.
		[mm]	[mm]	[cm]	[cm]	[pc.]	[pc.]	[pc.]	[pc.]	[pc.]
601.508.00.5	12	16	15	5.9	1.2		50	10		7.34
602.507.00.5	15	20	15	6.1	1.1		50	10	1	7.34
602.508.00.5	15	20	18	6.1	1.2		50	10		7.34
602.509.00.5	15	20	22	6.2	1.2		50	10	1	7.34
603.508.00.5	20	26	22	6.7	1.2		25	5		11.43
604.508.00.5	25	32	28	6.6	1.3		25	5		12.95
605.508.00.5	32	40	35	7.5	1.3		25	5		16.18
606.508.00.5	40	50	42	10.1	3.1	480	10	2		31.97
607.508.00.5	50	63	54	13.6	3.2	180	10		1	49.24

## Geberit Mepla adaptor with male thread

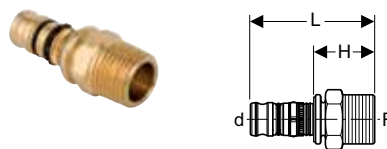

### Application purposes

- For technical building systems, industry and shipbuilding
- Application overview: Geberit Mepla → p. 9

### Characteristics

- Leaky if unpressed
- O-ring made of EPDM
- Pressing nipple with transparent protective cap

### Technical data

Material		Gunmetal (CuSn5Zn5Pb2-C)								
Art. no.	DN	d, ø	R	H	L	SU4	SU3	SU2	SU1	GBP/pc.
		[mm]	["]	[cm]	[cm]	[pc.]	[pc.]	[pc.]	[pc.]	[pc.]
601.535.00.5	12	16	1/2	2.8	5.4		50	10		5.09
601.536.00.5	12	16	3/4	3.1	5.7		50	10		5.09
602.535.00.5	15	20	1/2	3	5.7		50	10		5.98
602.536.00.5	15	20	3/4	3.1	5.9		50	10		5.98
603.535.00.5	20	26	1/2	3.1	6.3	1600	25	5		8.83
603.536.00.5	20	26	3/4	3.2	6.4		50	5		8.83
603.537.00.5	20	26	1	3.5	6.7		25	5		8.83
604.537.00.5	25	32	1	3.6	6.4		25	5		11.81
604.538.00.5	25	32	1 1/4	3.9	6.6	1200	25	5		11.81
605.537.00.5	32	40	1	3.7	7.1		25	5		12.98
605.538.00.5	32	40	1 1/4	4	7.4	800	25	5		12.98
605.539.00.5	32	40	1 1/2	4.1	7.5	600	25	5		12.98
606.537.00.5	40	50	1 1/2	4.2	8		20	2		27.16
606.540.00.5	40	50	2	4.7	8.4	360	20	2		27.16
607.539.00.5	50	63	2	5	11.7	180	10	2		41.79
607.541.00.5	50	63	2 1/2	5.8	12.5		10	2		41.79
608.541.00.5	65	75	2 1/2	6	14.7	126			1	79.62

New

### Geberit Mepla adaptor with male thread, NPW

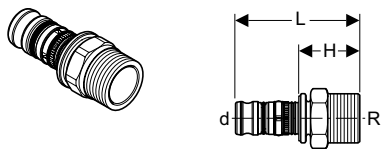

#### Application purposes

- For industry
- Application overview: Geberit Mepla → p. 9

#### Characteristics

- Leaky if unpressed
- O-ring made of EPDM
- Pressing nipple with transparent protective cap

#### Technical data

Operating temperature	0-40 °C
Material	PVDF

Art. no.	DN	d, ø [mm]	R ["]	H [cm]	L [cm]	SU1 [pc.]	GBP/pc.
622.535.00.5	15	20	1/2	3	5.7	1	88.50
623.536.00.5	20	26	3/4	3.2	6.4	1	103.50
624.537.00.5	25	32	1	3.6	6.4	1	136.75
625.538.00.5	32	40	1 1/4	4	7.4	1	195.75
626.537.00.5	40	50	1 1/2	4.2	8	1	226.75
627.539.00.5	50	63	2	5	11.7	1	258.00
628.541.00.5	65	75	2 1/2	6	14.7	1	292.25

Available as of April 2016

### Geberit Mepla adaptor with female thread

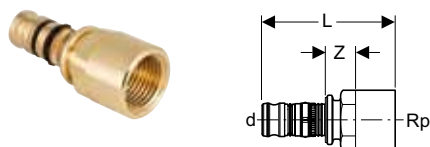

#### Application purposes

- For technical building systems, industry and shipbuilding
- Application overview: Geberit Mepla → p. 9

#### Characteristics

- Leaky if unpressed
- O-ring made of EPDM
- Pressing nipple with transparent protective cap

#### Technical data

Material	Gunmetal (CuSn5Zn5Pb2-C)
----------	--------------------------

Art. no.	DN	d, ø [mm]	Rp ["]	L [cm]	Z [cm]	SU4 [pc.]	SU3 [pc.]	SU2 [pc.]	SU1 [pc.]	GBP/pc.
601.555.00.5	12	16	1/2	5.6	1.8		50	10		5.09
601.556.00.5	12	16	3/4	5.9	1.7		50	10		5.09
602.555.00.5	15	20	1/2	5.9	1.8	3200	50	10		5.98
602.556.00.5	15	20	3/4	6.1	1.9		50	10		5.98
603.556.00.5	20	26	3/4	6.6	1.9	1600	25	5		8.83
603.557.00.5	20	26	1	7.1	2.2		25	5		8.83
604.557.00.5	25	32	1	6.7	2.2		25	5		11.81
604.558.00.5	25	32	1 1/4	7.4	2.3	1200	25	5		11.81
605.557.00.5	32	40	1	7.5	2.4		25	5		12.98

Art. no.	DN	d, ø [mm]	Rp ["]	L [cm]	Z [cm]	SU4 [pc.]	SU3 [pc.]	SU2 [pc.]	SU1 [pc.]	GBP/pc.
605.558.00.5	32	40	1 1/4	7.7	2.4		25	5		12.98
605.559.00.5	32	40	1 1/2	8.4	2.5	600	25	5		12.98
606.559.00.5	40	50	1 1/2	8.8	2.7	360	20	2		27.16
606.560.00.5	40	50	2	9.7	3.2		16	2		27.16
607.560.00.5	50	63	2	12.7	3.3	180	10		1	41.79
607.561.00.5	50	63	2 1/2	13.3	3.5		8		1	41.79
608.561.00.5	65	75	2 1/2	14.7	2.9	240			1	79.62

### Geberit Mepla elbow adaptor 90° with female thread

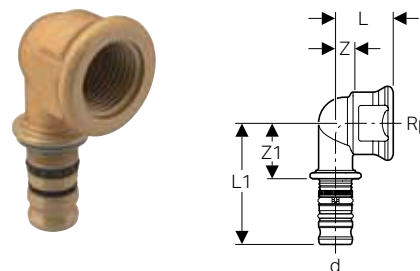

#### Application purposes

- For technical building systems, industry and shipbuilding
- Application overview: Geberit Mepla → p. 9

#### Characteristics

- Leaky if unpressed
- O-ring made of EPDM
- Pressing nipple with transparent protective cap

#### Technical data

Material	Brass CW617N
----------	--------------

Art. no.	DN	d, ø [mm]	Rp ["]	L [cm]	L1 [cm]	Z [cm]	Z1 [cm]	SU3 [pc.]	SU2 [pc.]	GBP/ pc.
612.256.00.5	15	20	1/2	2.5	5.3	1.2	2.5	50	10	#NV

## Geberit Mepla bend adaptor 90° with male thread

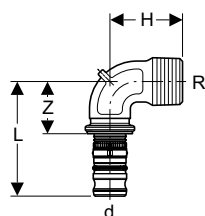

### Application purposes

- For technical building systems, industry and shipbuilding
- Application overview: Geberit Mepla → p. 9

### Characteristics

- Leaky if unpressed
- O-ring made of EPDM
- Pressing nipple with transparent protective cap

### Technical data

Material	Gunmetal (CuSn5Zn5Pb2-C)
----------	--------------------------

Art. no.	DN	d, ø [mm]	R ["]	H [cm]	L [cm]	Z [cm]	SU4 [pc.]	SU3 [pc.]	SU2 [pc.]	SU1 [pc.]	GBP/pc.
601.252.00.5	12	16	1/2	3	4.8	2.3		50	10		8.58
602.252.00.5	15	20	1/2	3.2	5.1	2.3		50	10		10.28
602.253.00.5	15	20	3/4	3.4	5.3	2.5		50	10		10.28
603.253.00.5	20	26	3/4	4	5.7	2.5		25	5		14.91
603.254.00.5	20	26	1	4.3	5.9	2.7	1200	25	5		14.91
604.254.00.5	25	32	1	4.6	5.9	3.1		25	5		20.17
605.255.00.5	32	40	1 1/4	5.3	7	3.6		25	5		24.02
606.255.00.5	40	50	1 1/2	6	7.7	3.9		10	2		36.07
607.255.00.5	50	63	2	7.5	11.6	4.9	120		5	1	77.13

## Geberit Mepla bend adaptor 90° with female thread

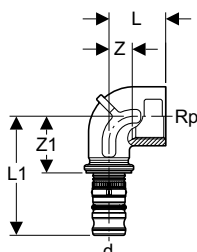

### Application purposes

- For technical building systems, industry and shipbuilding
- Application overview: Geberit Mepla → p. 9

### Characteristics

- Leaky if unpressed
- O-ring made of EPDM
- Pressing nipple with transparent protective cap

### Technical data

Material	Gunmetal (CuSn5Zn5Pb2-C)
----------	--------------------------

Art. no.	DN	d, ø [mm]	Rp ["]	L [cm]	L1 [cm]	Z [cm]	Z1 [cm]	SU4 [pc.]	SU3 [pc.]	SU2 [pc.]	SU1 [pc.]	GBP/pc.
601.256.00.5	12	16	1/2	2.2	5	0.9	2.4		50	10		8.58
602.256.00.5	15	20	1/2	2.5	5.3	1.2	2.5		50	10		10.28
602.257.00.5	15	20	3/4	3.5	5.3	2	2.5	1600	50	10		10.28
603.257.00.5	20	26	3/4	3	6.1	1.5	2.9	1200	25	5		14.91
603.258.00.5	20	26	1	3.4	6.5	1.5	3.3		50	10		14.91
604.258.00.5	25	32	1	3.6	6.2	1.9	3.4		25	5		20.17
605.259.00.5	32	40	1 1/4	4.3	7.3	2.2	3.9		10	2		24.02
606.256.00.5	40	50	1 1/2	4.8	8.1	2.8	4.3		10	2		36.07
607.256.00.5	50	63	2	5.7	11.9	3.1	5.2			5	1	77.13

## 1.4.6 Adaptors and connections, detachable

### Geberit Mepla adaptor to MeplaFix

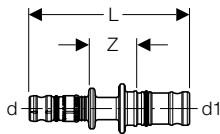

#### Application purposes

- For tool-free connection to elements, mounting plates and connections compatible with MeplaFix
- For technical building systems, industry and shipbuilding
- Application overview: Geberit Mepla → p. 9

#### Characteristics

- Leaky if unpressed
- O-ring made of EPDM
- Pressing nipple with transparent protective cap
- MeplaFix plug-in nipple with blue protective sleeve

#### Technical data

Material	PVDF
----------	------

Art. no.	DN	d, $\varnothing$ [mm]	d1, $\varnothing$ [mm]	L [cm]	Z [cm]	SU3 [pc.]	SU2 [pc.]	SU1 [pc.]	GBP/pc.
621.562.00.5	12 / 15	16	MF20	7.1	2.2	50	10	1	2.99
622.562.00.5	15	20	MF20	7.3	2.2	50	10	1	2.99

### Geberit Mepla elbow adaptor 90° to MeplaFix

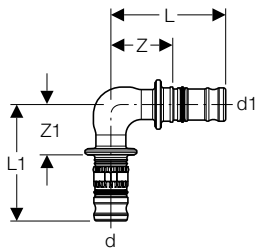

#### Application purposes

- For tool-free connection to elements, mounting plates and connections compatible with MeplaFix
- For technical building systems, industry and shipbuilding
- Application overview: Geberit Mepla → p. 9

#### Characteristics

- Leaky if unpressed
- O-ring made of EPDM
- Pressing nipple with transparent protective cap
- MeplaFix plug-in nipple with blue protective sleeve

#### Technical data

Material	PVDF
----------	------

Art. no.	DN	d, $\varnothing$ [mm]	d1, $\varnothing$ [mm]	L [cm]	L1 [cm]	Z [cm]	Z1 [cm]	SU3 [pc.]	SU2 [pc.]	SU1 [pc.]	GBP/pc.
621.272.00.5	15 / 12	16	MF20	4.7	4.8	2.4	2.2	50	10	1	4.13
622.272.00.5	15 / 15	20	MF20	4.7	5.1	2.4	2.2	50	10	1	4.13

### Geberit Mepla adaptor T-piece to MeplaFix

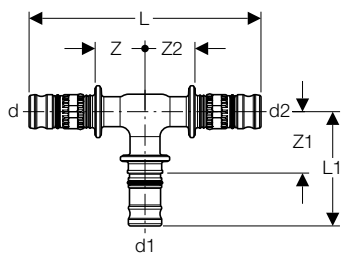

#### Application purposes

- For tool-free connection to elements, mounting plates and connections compatible with MeplaFix
- For technical building systems, industry and shipbuilding
- Application overview: Geberit Mepla → p. 9

#### Characteristics

- Leaky if unpressed
- O-ring made of EPDM
- Pressing nipple with transparent protective cap
- MeplaFix plug-in nipple with blue protective sleeve

#### Technical data

Material	PVDF
----------	------

Art. no.	DN	d, ø [mm]	d1, ø [mm]	d2, ø [mm]	L [cm]	L1 [cm]	Z [cm]	Z1 [cm]	Z2 [cm]	SU3 [pc.]	SU2 [pc.]	SU1 [pc.]	GBP/pc.
621.372.00.5	12 / 15 / 12	16	MF20	16	9.6	4.7	2.2	2.4	2.2	50	10	1	6.63
622.374.00.5	15 / 15 / 12	20	MF20	16	9.9	4.7	2.2	2.4	2.2	50	10	1	7.79
622.373.00.5	15	20	MF20	20	10.1	4.7	2.2	2.4	2.2	50	10	1	7.79
623.372.00.5	20 / 15 / 15	26	MF20	20	10.6	4.7	2.2	2.4	2.2	40	10	1	8.47

### Geberit Mepla adaptor T-piece to MeplaFix

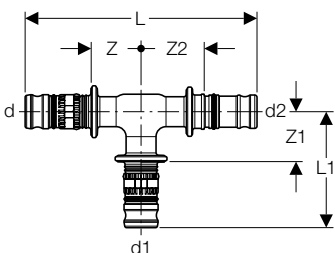

#### Application purposes

- For tool-free connection to elements, mounting plates and connections compatible with MeplaFix
- For technical building systems, industry and shipbuilding
- Application overview: Geberit Mepla → p. 9

#### Characteristics

- Leaky if unpressed
- O-ring made of EPDM
- Pressing nipple with transparent protective cap
- MeplaFix plug-in nipple with blue protective sleeve

#### Technical data

Material	PVDF
----------	------

Art. no.	DN	d, ø [mm]	d1, ø [mm]	d2, ø [mm]	L [cm]	L1 [cm]	Z [cm]	Z1 [cm]	Z2 [cm]	SU3 [pc.]	SU2 [pc.]	SU1 [pc.]	GBP/pc.
622.375.00.5	12 / 12 / 15	16	16	MF20	9.5	4.8	2.2	2.2	2.4	50	10	1	6.63
622.376.00.5	15	20	20	MF20	9.7	5.1	2.2	2.2	2.4	50	10	1	7.79

## Geberit Mepla adaptor with MeplaFix adaptor

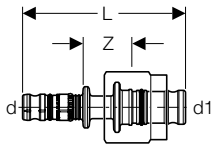

### Application purposes

- For tool-free connection to elements, mounting plates and connections compatible with MeplaFix
- For technical building systems, industry and shipbuilding
- Application overview: Geberit Mepla → p. 9

### Characteristics

- Leaky if unpressed
- O-ring made of EPDM
- Pressing nipple with transparent protective cap
- MeplaFix with blue protective sleeve

### Technical data

Material						PVDF			
Art. no.	DN	d, $\emptyset$ [mm]	d1, $\emptyset$ [mm]	L [cm]	Z [cm]	SU3 [pc.]	SU2 [pc.]	SU1 [pc.]	GBP/pc.
631.562.00.6	12 / 15	16	MF20	7.3	2.2	50	10	1	5.50
632.562.00.6	15	20	MF20	7.3	2.2	50	10	1	5.50

## Geberit Mepla elbow adaptor 90° with MeplaFix adaptor

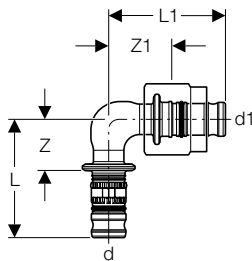

### Application purposes

- For tool-free connection to elements, mounting plates and connections compatible with MeplaFix
- For technical building systems, industry and shipbuilding
- Application overview: Geberit Mepla → p. 9

### Characteristics

- Leaky if unpressed
- O-ring made of EPDM
- Pressing nipple with transparent protective cap
- MeplaFix with blue protective sleeve

### Technical data

Material						PVDF					
Art. no.	DN	d, $\emptyset$ [mm]	d1, $\emptyset$ [mm]	L [cm]	L1 [cm]	Z [cm]	Z1 [cm]	SU3 [pc.]	SU2 [pc.]	SU1 [pc.]	GBP/pc.
631.272.00.6	12 / 15	16	MF20	4.8	4.7	2.2	2.4	50	10	1	6.22
632.272.00.6	15	20	MF20	5.1	4.7	2.2	2.4	50	10	1	6.23

## Geberit Mepla adaptor T-piece with MeplaFix adaptor

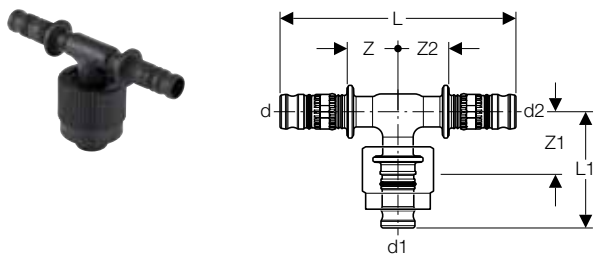

### Application purposes

- For tool-free connection to elements, mounting plates and connections compatible with MeplaFix
- For technical building systems, industry and shipbuilding
- Application overview: Geberit Mepla → p. 9

### Characteristics

- Leaky if unpressed
- O-ring made of EPDM
- Pressing nipple with transparent protective cap
- MeplaFix with blue protective sleeve

### Technical data

Material		PVDF											
Art. no.	DN	d, ø [mm]	d1, ø [mm]	d2, ø [mm]	L [cm]	L1 [cm]	Z [cm]	Z1 [cm]	Z2 [cm]	SU3 [pc.]	SU2 [pc.]	SU1 [pc.]	GBP/pc.
631.372.00.6	12 / 15 / 12	16	MF20	16	9.6	4.7	2.2	2.4	2.2	30	10	1	8.39
632.374.00.6	15 / 15 / 12	20	MF20	16	9.9	4.7	2.2	2.4	2.2	30	10	1	8.99
632.373.00.6	15	20	MF20	20	10.1	4.7	2.2	2.4	2.2	50	10	1	9.00
633.372.00.6	20 / 15 / 15	26	MF20	20	10.6	4.7	2.2	2.4	2.2	30	10	1	9.80

## Geberit Mepla adaptor T-piece with MeplaFix adaptor

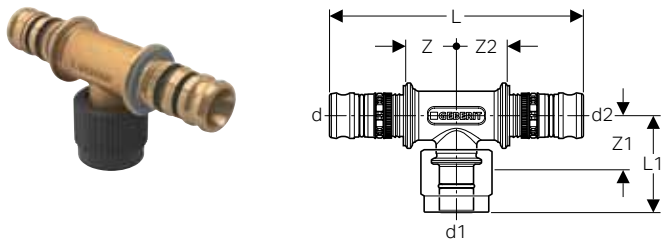

### Application purposes

- For tool-free connection to elements, mounting plates and connections compatible with MeplaFix
- For technical building systems, industry and shipbuilding
- Application overview: Geberit Mepla → p. 9

### Characteristics

- Leaky if unpressed
- O-ring made of EPDM
- Pressing nipple with transparent protective cap
- MeplaFix with blue protective sleeve

### Technical data

Material		Gunmetal (CuSn5Zn5Pb2-C)										
Art. no.	DN	d, ø [mm]	d1, ø [mm]	d2, ø [mm]	L [cm]	L1 [cm]	Z [cm]	Z1 [cm]	Z2 [cm]	SU3 [pc.]	SU2 [pc.]	GBP/pc.
633.373.00.5	20 / 15 / 20	26	MF20	26	11	4.2	2.2	2.2	2.2	25	5	22.32

## Geberit Mepla adaptor T-piece with MeplaFix adaptor

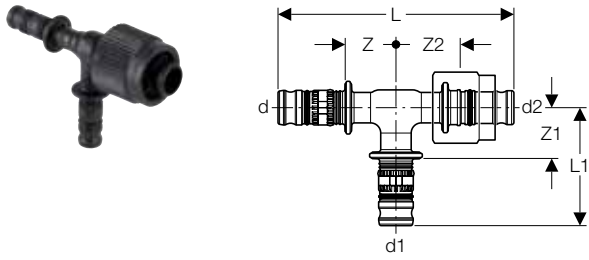

### Application purposes

- For tool-free connection to elements, mounting plates and connections compatible with MeplaFix
- For technical building systems, industry and shipbuilding
- Application overview: Geberit Mepla → p. 9

### Characteristics

- Leaky if unpressed
- O-ring made of EPDM
- Pressing nipple with transparent protective cap
- MeplaFix with blue protective sleeve

### Technical data

Material	PVDF
----------	------

Art. no.	DN	d, ø [mm]	d1, ø [mm]	d2, ø [mm]	L [cm]	L1 [cm]	Z [cm]	Z1 [cm]	Z2 [cm]	SU3 [pc.]	SU2 [pc.]	SU1 [pc.]	GBP/pc.
632.375.00.6	12 / 12 / 15	16	16	MF20	9.5	4.8	2.2	2.2	2.4	30	10	1	8.39
632.376.00.6	15	20	20	MF20	9.7	5.1	2.2	2.2	2.4	30	10	1	9.00

## Geberit MeplaFix adaptor



### Application purposes

- For Geberit fittings with male thread MeplaFix

### Technical data

Material	Brass CW617N
----------	--------------

Art. no.	DN	d, ø [mm]	Rp ["]	L [cm]	SU3 [pc.]	SU2 [pc.]	SU1 [pc.]	GBP/pc.
632.001.00.1	15	MF20	1/2	2.6	100	10	1	2.86

## Geberit Mepla union

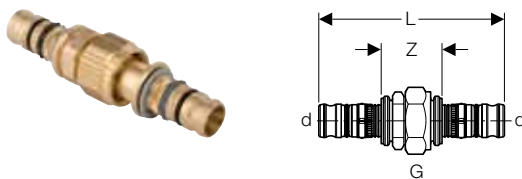

### Application purposes

- For technical building systems, industry and shipbuilding
- Application overview: Geberit Mepla → p. 9

- O-ring made of EPDM
- Pressing nipple with transparent protective cap
- Flat gasket made of Centellen® R 3825

### Characteristics

- Leaky if unpressed
- Union nut made of brass

### Technical data

Material	Gunmetal (CuSn5Zn5Pb2-C)
----------	--------------------------

Art. no.	DN	d, ø [mm]	G ["]	L [cm]	Z [cm]	SU4 [pc.]	SU3 [pc.]	SU2 [pc.]	SU1 [pc.]	GBP/pc.
601.571.00.5	12	16	1/2	9.1	4.1			5	1	13.06
602.571.00.5	15	20	1/2	9.9	4.4		50	5		14.68
603.571.00.5	20	26	3/4	11	4.6			5	1	17.18
604.571.00.5	25	32	1	11.5	5.8		10		1	22.40
605.571.00.5	32	40	1 1/4	13.1	6.3		10		1	27.99
606.571.00.5	40	50	1 1/2	14.3	6.7		10		1	55.97
607.571.00.5	50	63	2	20.8	7.4	192	6		1	116.95

## Geberit Mepla adaptor union with male thread

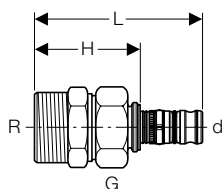

### Application purposes

- For technical building systems, industry and shipbuilding
- Application overview: Geberit Mepla → p. 9

- O-ring made of EPDM
- Pressing nipple with transparent protective cap
- Flat gasket made of Centellen® R 3825

### Characteristics

- Leaky if unpressed
- Union nut made of brass

### Technical data

Material	Gunmetal (CuSn5Zn5Pb2-C)
----------	--------------------------

Art. no.	DN	d, ø [mm]	R ["]	G ["]	H [cm]	L [cm]	SU4 [pc.]	SU3 [pc.]	SU2 [pc.]	SU1 [pc.]	GBP/pc.
601.590.00.5	12	16	1/2	3/4	4.7	7.2		50	10	1	12.21
602.590.00.5	15	20	1/2	3/4	4.7	7.4	2400	50	10		12.55
602.591.00.5	15	20	3/4	3/4	4.7	7.4		50	5	1	12.55
603.590.00.5	20	26	3/4	1	5.1	8.3		25	5		16.18
604.590.00.5	25	32	1	1 1/4	5.9	8.7		25	5		22.40
604.591.00.5	25	32	1 1/4	1 1/4	6.1	9		10	2		22.40
605.590.00.5	32	40	1 1/4	1 1/2	6.2	9.6		20	5	1	29.20
605.591.00.5	32	40	1 1/2	1 1/2	6.5	10		10	2		29.20
606.590.00.5	40	50	1 1/2	1 3/4	8.3	12.1	320	10		1	55.73
606.591.00.5	40	50	2	2	7.6	11.4		10		1	55.73
607.590.00.5	50	63	2	2 3/4	8.1	14.8	234	6	2		80.42
607.591.00.5	50	63	2 1/2	2 3/4	8.5	15.2		4		1	80.42

## Geberit Mepla adaptor union with female thread

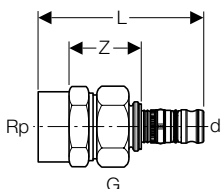

### Application purposes

- For technical building systems, industry and shipbuilding
- Application overview: Geberit Mepla → p. 9

- O-ring made of EPDM
- Pressing nipple with transparent protective cap
- Flat gasket made of Centellen® R 3825

### Characteristics

- Leaky if unpressed
- Union nut made of brass

### Technical data

Material	Gunmetal (CuSn5Zn5Pb2-C)
----------	--------------------------

Art. no.	DN	d, ø [mm]	Rp ["]	G ["]	L [cm]	Z [cm]	SU4 [pc.]	SU3 [pc.]	SU2 [pc.]	SU1 [pc.]	GBP/pc.	
601.595.00.5	12	16	1/2	3/4	6.6	2.8		50	10	1	12.21	
602.595.00.5	15	20	1/2	3/4	6.8	2.8		50	10	1	12.55	
603.595.00.5	20	26	3/4	1	7.6	3		25	5		16.18	
604.595.00.5	25	32	1	1 1/4	7	2.5		25	5		22.40	
604.596.00.5	25	32	1 1/4	1 1/4	8.6	3.8				5	1	22.40
605.595.00.5	32	40	1 1/4	1 1/2	9	3.7		25	5		29.20	
605.596.00.5	32	40	1 1/2	1 1/2	9.4	4.1		10		1	29.20	
606.595.00.5	40	50	1 1/2	1 3/4	11.2	5.5	320	10		1	55.73	
606.596.00.5	40	50	2	2	10.9	4.8		10		1	55.73	
607.595.00.5	50	63	2	2 3/4	12.4	3.4		6		1	80.42	

## Geberit Mepla adaptor with union nut

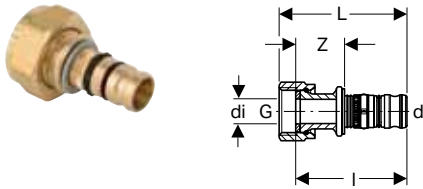

### Application purposes

- Suitable exclusively for threads with an inner diameter of  $\leq d_i$
- For technical building systems, industry and shipbuilding
- Application overview: Geberit Mepla → p. 9

### Characteristics

- Leaky if unpressed
- Union nut made of brass
- O-ring made of EPDM
- Pressing nipple with transparent protective cap
- Flat gasket made of Centellen® R 3825

### Technical data

Material		Gunmetal (CuSn5Zn5Pb2-C)										
Art. no.	DN	d, $\varnothing$ [mm]	G ["]	d <sub>i</sub> , $\varnothing$ [mm]	L [cm]	l [cm]	Z [cm]	SU4 [pc.]	SU3 [pc.]	SU2 [pc.]	SU1 [pc.]	GBP/pc.
601.582.00.5	12	16	1/2	11	5.2	4.4	1.9	1200	25	5		8.19
601.583.00.5	12	16	3/4	17	4.9	3.9	1.4	3200	50	5		8.19
601.584.00.5	12	16	1	21	5.2	4	1.4		50	10	1	8.19
601.581.00.5	12	16	1 1/8	24	5.2	4	1.4			5	1	8.19
602.582.00.5	15	20	1/2	11	5.6	4.9	2.2		50	5		8.35
602.583.00.5	15	20	3/4	17	5.2	4.3	1.3		25	5		8.35
602.584.00.5	15	20	1	21	5.6	4.1	1.5		50	10	1	8.35
602.581.00.5	15	20	1 1/8	24	5.5	4.3	1.5			5	1	8.35
602.586.00.5	15	20	1 1/4	27	5.5	4.4	1.7		50	5		8.35
602.585.00.5	15	20	1 1/2	32	5.7	4.4	1.7		50	5		8.35
603.582.00.5	20	26	1/2	11	6.3	5.5	2.4		25	5		10.96
603.583.00.5	20	26	3/4	17	6.2	5.4	2.3		25	5		10.96
603.584.00.5	20	26	1	21	5.6	4.8	1.5		25	5		10.16
603.586.00.5	20	26	1 1/4	27	6	4.9	1.8		25	5		10.96
603.585.00.5	20	26	1 1/2	32	6.2	4.9	1.7	800	25	5		10.96
603.587.00.5	20	26	2	42	6.3	5	1.8			5	1	10.96
604.583.00.5	25	32	3/4	17	6.1	5.3	2.5		25	5	1	15.92
604.584.00.5	25	32	1	21	6.7	4.8	2.9		25	5		15.92
604.586.00.5	25	32	1 1/4	27	5.9	4.5	1.6		25	5		15.92
604.585.00.5	25	32	1 1/2	32	5.8	4.6	1.7	600	25	5		15.92
604.581.00.5	25	32	2	42	6	4.6	1.8			5	1	15.92
605.589.00.5	32	40	1 1/4	27	7.6	6.5	3.1		10	2		19.78
605.585.00.5	32	40	1 1/2	32	6.5	5.2	1.8	600	25	5		19.78
605.581.00.5	32	40	2	42	6.6	5.2	1.9		10	2		19.78
605.582.00.5	32	40	2 1/4	42	6.7	5.2	1.9		10	2		19.78
606.585.00.5	40	50	1 1/2	32	8.2	7.1	3.3		10	2		28.60
606.580.00.5	40	50	1 3/4	36	8.1	7.3	3.4		10		1	28.60
606.581.00.5	40	50	2	42	6.8	6	2.1		10		1	28.60
606.582.00.5	40	50	2 1/4	42	7.3	5.9	2.1		10	2		28.60
606.583.00.5	40	50	2 3/8	52	7.4	5.9	2.1	240	10	2		28.60
606.584.00.5	40	50	2 3/4	63	7.5	6.8	2.1		10	2		28.60
607.581.00.5	50	63	2	42	11.5	10.3	3.6	240	10		1	51.41
607.583.00.5	50	63	2 3/8	52	11.5	10.3	3.6	180	10		1	51.41
607.587.00.5	50	63	2 1/2	54	11.5	10.3	3.6		10		1	51.41
607.584.00.5	50	63	2 3/4	63	10.6	9	2.3		10		1	51.41

### Geberit Mepla adaptor to copper pipe clamping ring union

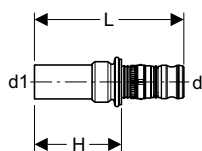

#### Application purposes

- Suitable exclusively for clamping ring unions
- For technical building systems, industry and shipbuilding
- Application overview: Geberit Mepla → p. 9

- O-ring made of EPDM
- Pressing nipple with transparent protective cap

#### Technical data

Material	Brass / copper
----------	----------------

#### Characteristics

- Leaky if unpressed
- Tin-plated

Art. no.	DN	d, ø [mm]	d1, ø [mm]	H [cm]	L [cm]	SU4 [pc.]	SU3 [pc.]	SU2 [pc.]	SU1 [pc.]	GBP/pc.
611.512.24.5	12	16	15	3.9	6.4		25	5	1	9.58
612.512.24.5	15	20	15	3.8	6.5		25	5	1	10.79
613.513.24.5	20	26	22	4.4	7.6	1500	25	5	1	12.98

New

### Geberit Mepla adaper with screw connection to PE-X pipe

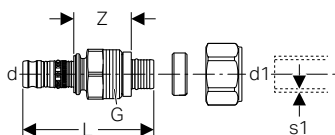

#### Application purposes

- For technical building systems
- Application overview: Geberit Mepla → p. 9

#### Technical data

Material	Brass CW617N
----------	--------------

#### Characteristics

- Leaky if unpressed
- O-ring made of EPDM
- Pressing nipple with transparent protective cap

#### Scope of delivery

- Clamping ring union

Art. no.	DN	d, ø [mm]	G [""]	d1, ø [mm]	s1 [mm]	L [cm]	Z [cm]	PN [bar]	SU3 [pc.]	SU2 [pc.]	SU1 [pc.]	GBP/pc.
611.565.00.5	12	16	3/4	16	1.5	6.8	2.8	6	25	5	1	11.75
612.566.00.5	15	20	3/4	20	1.9	7.2	3	6	25	5	1	13.00
613.567.00.5	20	26	1	25	2.3	8	3.3	6	25	5	1	12.50

Available as of April 2016

### Geberit Mepla flanged stub with pressing nipple, for Geberit Mepla loose flanges PN 6 and PN 10/16

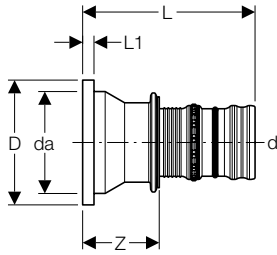

**Application purposes**

- For technical building systems, industry and shipbuilding
- Application overview: Geberit Mepla → p. 9

**Characteristics**

- Leaky if unpressed
- O-ring made of EPDM
- Pressing nipple with transparent protective cap

**Technical data**

Material	Gunmetal (CuSn5Zn5Pb2-C)									
Art. no.	DN	d, $\varnothing$ [mm]	da [mm]	D [cm]	L [cm]	L1 [cm]	Z [cm]	SU4 [pc.]	SU1 [pc.]	GBP/pc.
608.520.00.5	65	75	95	11.5	15.2	0.6	6.6	120	1	106.86

**To order additionally**

- Loose flange

**Accessories**

- Geberit flange gasket PN 6 → p. 56
- Geberit flange gasket PN 10/16 → p. 56
- Geberit bolt set for flange connection, made of CrNi steel → p. 56
- Geberit bolt set for flange connection, made of steel zinc-plated → p. 56

### Geberit Mepla loose flange PN 6

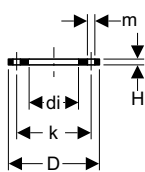

**Application purposes**

- For Geberit Mepla flanged stub with pressing nipple

**Characteristics**

- Zinc-plated

**Technical data**

Material	Non-alloy steel 1.0034 E195 (EN 10305)									
Art. no.	DN	d, $\varnothing$ [mm]	D [cm]	k [cm]	m [cm]	H [cm]	n [pc.]	PN [bar]	SU1 [pc.]	GBP/pc.
23799	65	97	16	13	1.4	1.6	4	6	1	40.67

**Accessories**

- Geberit flange gasket PN 6 → p. 56
- Geberit bolt set for flange connection, made of steel zinc-plated → p. 56

### Geberit Mepla loose flange PN 10/16

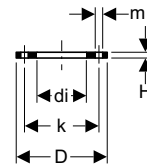

**Application purposes**

- For Geberit Mepla flanged stub with pressing nipple

**Technical data**

Material	Brass CW617N									
Art. no.	DN	d, $\varnothing$ [mm]	D [cm]	k [cm]	m [cm]	H [cm]	n [pc.]	PN [bar]	SU1 [pc.]	GBP/pc.
63789	65	97	18.5	14.5	1.8	1.6	4	10/16	1	62.36

**Accessories**

- Geberit flange gasket PN 10/16 → p. 56
- Geberit bolt set for flange connection, made of CrNi steel → p. 56

## 1.4.7 Sealings

### Geberit Mepla pipe end plug

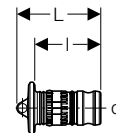

**Application purposes**

- For technical building systems, industry and shipbuilding
- For permanent termination of pipe ends
- Application overview: Geberit Mepla → p. 9

**Characteristics**

- Leaky if unpressed
- O-ring made of EPDM
- Pressing nipple with transparent protective cap

**Technical data**

Material	PVDF									
Art. no.	DN	d, $\varnothing$ [mm]	L [cm]	l [cm]	SU3 [pc.]	SU2 [pc.]	GBP/pc.			
621.000.00.5	12	16	3.4	2.6	50	10	2.30			
622.000.00.5	15	20	3.7	2.9	50	10	2.30			
623.000.00.5	20	26	4.2	3.3	50	10	2.30			

## 1.4.8 Connections

### Geberit tap connector, straight, for MeplaFix

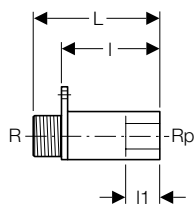

#### Application purposes

- For technical building systems, industry and shipbuilding
- Application overview: Geberit Mepla → p. 9

#### Characteristics

- Male thread
- Male thread for connection of Geberit MeplaFix adaptor
- Three fastening points
- MeplaFix connection with blue protective cap

#### Technical data

Material	Gunmetal (CuSn5Zn5Pb2-C)
----------	--------------------------

Art. no.	DN	R ["]	Rp ["]	L [cm]	I [cm]	I1 [cm]	SU3 [pc.]	SU2 [pc.]	SU1 [pc.]	GBP/pc.
602.283.00.1	15	MF 1/2	1/2	7.9	5.7	2.7	50	10	1	10.79

#### Accessories

- Geberit sound insulation base for tap connector, straight → p. 47

### Geberit Mepla elbow tap connector 90°

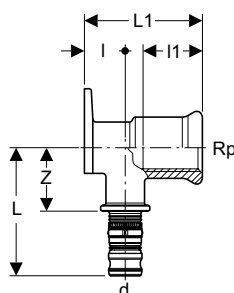

#### Application purposes

- For technical building systems, industry and shipbuilding
- Application overview: Geberit Mepla → p. 9

#### Characteristics

- Leaky if unpressed
- Three fastening points
- O-ring made of EPDM
- Pressing nipple with transparent protective cap

#### Technical data

Material	Brass CW617N
----------	--------------

Art. no.	DN	d, ø [mm]	Rp ["]	L [cm]	L1 [cm]	I [cm]	I1 [cm]	Z [cm]	SU3 [pc.]	SU2 [pc.]	GBP/pc.
611.289.00.5	12	16	1/2	5	3.6	1.8	1.3	2.5	50	10	7.10
612.289.00.5	15	20	1/2	5.5	3.6	1.8	1.3	2.7	50	10	7.77
612.293.00.5	15	20	1/2	5.5	5.2	1.8	2.6	2.9	50	10	10.90

## Geberit Mepla elbow tap connector 90°

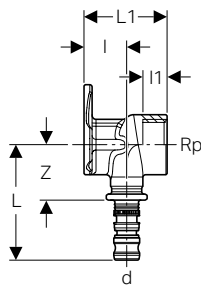

### Application purposes

- For technical building systems, industry and shipbuilding
- Application overview: Geberit Mepla → p. 9

### Characteristics

- Leaky if unpressed
- Three fastening points
- O-ring made of EPDM
- Pressing nipple with transparent protective cap

### Technical data

Material	Gunmetal (CuSn5Zn5Pb2-C)
----------	--------------------------

Art. no.	DN	d, ø [mm]	Rp ["]	L [cm]	L1 [cm]	I [cm]	I1 [cm]	Z [cm]	SU4 [pc.]	SU3 [pc.]	SU2 [pc.]	SU1 [pc.]	GBP/pc.
601.289.00.5	12	16	1/2	5	3.6	1.8	1.3	2.5		50	10		9.14
601.293.00.5	12	16	1/2	5	5.2	1.8	2.6	2.5		50	10		8.81
601.296.00.5	12	16	1/2	6.5	7.8	1.8	3	4		50	10		13.86
602.289.00.5	15	20	1/2	5.5	3.6	1.8	1.3	2.7		50	10		11.05
602.293.00.5	15	20	1/2	5.5	5.2	1.8	2.6	2.7		50	10		9.81
602.296.00.5	15	20	1/2	7	7.8	1.8	3	4.2	2700	50	10		13.86
602.294.00.5	15	20	3/4	5.5	5.2	1.8	1.9	2.7	1000	50	10	1	9.81
603.294.00.5	20	26	3/4	5.9	5.2	2.1	1.9	2.7	1200	25	5		13.68

## Geberit elbow tap connector 90° for MeplaFix

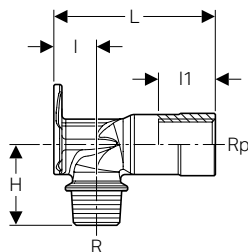

### Application purposes

- For technical building systems, industry and shipbuilding
- Application overview: Geberit Mepla → p. 9

### Characteristics

- Male thread
- Male thread for connection of Geberit MeplaFix adaptor
- Three fastening points
- MeplaFix connection with blue protective cap

### Technical data

Material	Gunmetal (CuSn5Zn5Pb2-C)
----------	--------------------------

Art. no.	DN	R ["]	Rp ["]	H [cm]	L [cm]	I [cm]	I1 [cm]	SU4 [pc.]	SU3 [pc.]	SU2 [pc.]	GBP/pc.
602.285.00.1	15	MF 1/2	1/2	3.5	5.7	1.8	3	2500	50	10	8.15
602.287.00.1	15	MF 1/2	1/2	3.5	7	1.8	3		50	10	9.95

## Geberit Mepla double elbow tap connector 90°

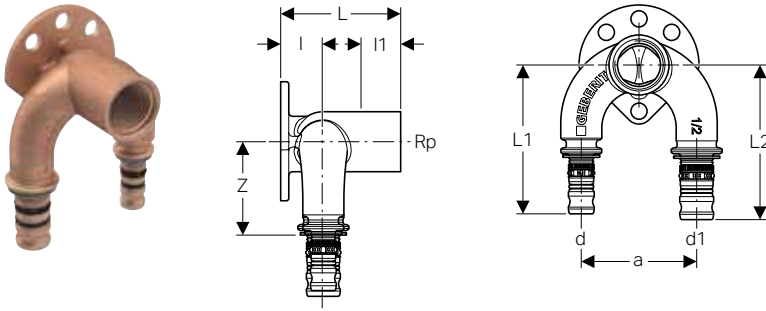

### Application purposes

- For technical building systems, industry and shipbuilding
- Application overview: Geberit Mepla → p. 9

### Characteristics

- Leaky if unpressed
- Four fastening points
- O-ring made of EPDM
- Pressing nipple with transparent protective cap

### Technical data

Material		Gunmetal (CuSn5Zn5Pb2-C)												
Art. no.	DN	d, ø [mm]	Rp ["]	d1, ø [mm]	a [cm]	L [cm]	L1 [cm]	L2 [cm]	l [cm]	l1 [cm]	Z [cm]	SU3 [pc.]	SU2 [pc.]	GBP/pc.
601.273.00.5	12	16	1/2	16	5	5.2	6.5	6.5	1.9	2.4	3.6	25	5	33.28
602.274.00.5	12 / 15	16	1/2	20	5	5.2	6.5	6.7	1.9	2.4	3.6	25	5	35.45
602.275.00.5	15 / 12	20	1/2	16	5	5.2	6.7	6.5	1.9	2.4	3.6	25	5	35.45
602.273.00.5	15	20	1/2	20	5	5.2	6.7	6.7	1.9	2.4	3.6	25	5	35.45

## Geberit tap connector set, straight, pre-mounted, for MeplaFix, drywall construction

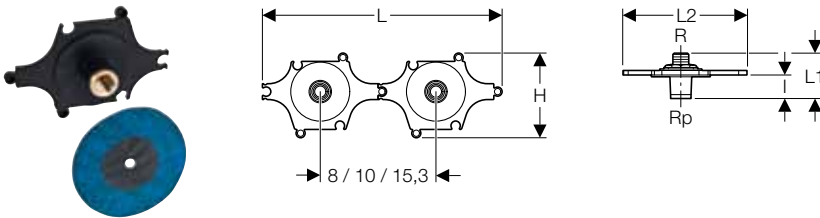

### Application purposes

- For panelling thicknesses of 18–25 mm
- For technical building systems, industry and shipbuilding
- Application overview: Geberit Mepla → p. 9

### Characteristics

- Sound-absorbing
- Male thread
- Male thread for connection of Geberit MeplaFix adaptor
- MeplaFix connection with blue protective cap

### Technical data

Material	Gunmetal (CuSn5Zn5Pb2-C)
----------	--------------------------

### Scope of delivery

- Insulating sleeve
- Drilling template
- Sealing washer
- Fastening material

Art. no.	DN	R ["]	Rp ["]	H [cm]	L [cm]	L1 [cm]	L2 [cm]	l [cm]	SU3 [pc.]	SU2 [pc.]	GBP/pc.
602.295.00.1	15	MF 1/2	1/2	11	31.6	6	16.5	3.1	20	2	17.51

### Accessories

- Geberit mounting aid set for straight connector, for drywall construction → p. 54

### Geberit elbow tap connector 90° for MeplaFix

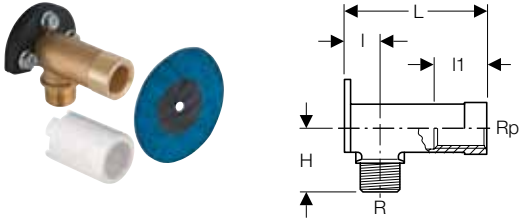

**Application purposes**

- For drywall construction
- For technical building systems, industry and shipbuilding
- Application overview: Geberit Mepla → p. 9

**Characteristics**

- Self-adhesive sealing washer, fleece-laminated
- Sound-absorbing
- Male thread
- Male thread for connection of Geberit MeplaFix adaptor
- Three fastening points
- MeplaFix connection with blue protective cap
- Protection plug for pressure test with cold water up to max. 15 bar / 1500 kPa

**Technical data**

Material	Gunmetal (CuSn5Zn5Pb2-C)
----------	--------------------------

**Scope of delivery**

- Insulating sleeve
- Sound insulation base
- Sealing washer
- Protection plug
- Fastening material

Art. no.	DN	R	Rp	H	L	I	I1	SU3	SU2	SU1	GBP/pc.
		["]	["]	[cm]	[cm]	[cm]	[cm]	[pc.]	[pc.]	[pc.]	
465.034.00.1	15	MF 1/2	1/2	3.5	7	1.8	3	50	10	1	15.38

### Geberit set tap connector 90° with male thread and soldering socket

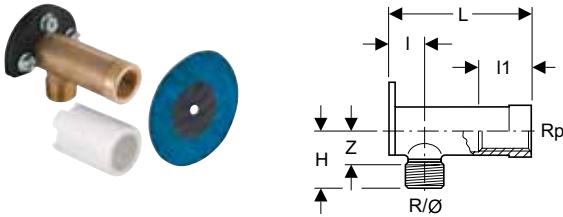

**Application purposes**

- For drywall construction
- For technical building systems, industry and shipbuilding
- Application overview: Geberit Mepla → p. 9

**Characteristics**

- Sound-absorbing
- Three fastening points

**Technical data**

Material	Gunmetal (CuSn5Zn5Pb2-C)
----------	--------------------------

**Scope of delivery**

- Insulating sleeve
- Sound insulation base
- Sealing washer
- Fastening material

Art. no.	DN	d, ø	R	Rp	H	L	I	I1	Z	SU2	SU1	GBP/pc.
		[mm]	["]	["]	[cm]	[cm]	[cm]	[cm]	[cm]	[pc.]	[pc.]	
465.038.00.1	12	15	1/2	1/2	3	7.8	2	3	1.7	10	1	14.77

### Geberit Mepla elbow tap connector 90° pre-mounted, single



#### Application purposes

- For technical building systems, industry and shipbuilding
- Application overview: Geberit Mepla → p. 9

#### Characteristics

- Leaky if unpressed
- Sound-absorbing
- O-ring made of EPDM
- Pressing nipple with transparent protective cap
- Protection plug for pressure test with cold water up to max. 15 bar / 1500 kPa

#### Technical data

Material	Gunmetal (CuSn5Zn5Pb2-C)
----------	--------------------------

#### Scope of delivery

- Protection plug
- Fastening material

Art. no.	DN	d, ø [mm]	Rp ["]	L [cm]	L1 [cm]	I [cm]	I1 [cm]	SU4 [pc.]	SU2 [pc.]	SU1 [pc.]	GBP/pc.
601.785.00.5	12	16	1/2	46	5.2	10	4	140	5	1	24.95
602.785.00.5	15	20	1/2	46	5.2	10	4	140	5	1	23.76

### Geberit Mepla elbow tap connector 90° pre-mounted, double

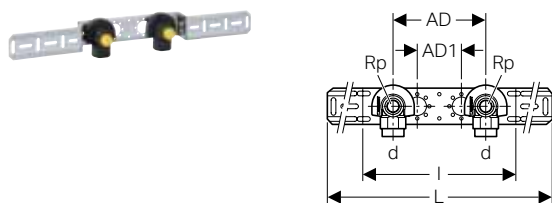

#### Application purposes

- For technical building systems, industry and shipbuilding
- Application overview: Geberit Mepla → p. 9

#### Characteristics

- Leaky if unpressed
- Sound-absorbing
- O-ring made of EPDM
- Pressing nipple with transparent protective cap
- Protection plug for pressure test with cold water up to max. 15 bar / 1500 kPa
- Connecting distance AD can be changed to AD1

#### Technical data

Material	Gunmetal (CuSn5Zn5Pb2-C)
----------	--------------------------

#### Scope of delivery

- 2 protection plugs
- Fastening material

Art. no.	DN	d, ø [mm]	Rp ["]	AD [cm]	AD1 [cm]	L [cm]	L1 [cm]	I [cm]	I1 [cm]	SU4 [pc.]	SU2 [pc.]	SU1 [pc.]	GBP/pc.
601.781.00.5	12	16	1/2	15.3	7.3	59.7	5.2	25.3	4	140	5	1	40.28
602.782.00.5	15	20	1/2	10	12	56.4	5.2	25.3	4	140	5	1	40.28
602.781.00.5	15	20	1/2	15.3	7.3	59.7	5.2	25.3	4	140	5	1	40.28

#### Accessories

- Drain pipe bracket for Geberit mounting plates → p. 54

### Geberit Mepla elbow tap connector 90° pre-mounted, double

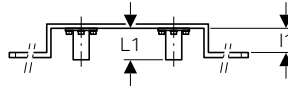
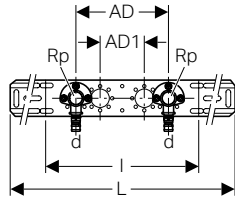

**Application purposes**

- For technical building systems, industry and shipbuilding
- Application overview: Geberit Mepla → p. 9

**Characteristics**

- Leaky if unpressed
- O-ring made of EPDM
- Pressing nipple with transparent protective cap
- Protection plug for pressure test with cold water up to max. 15 bar / 1500 kPa
- Connecting distance AD can be changed to AD1

**Technical data**

Material	Gunmetal (CuSn5Zn5Pb2-C)
----------	--------------------------

**Scope of delivery**

- 2 protection plugs
- Fastening material

Art. no.	DN	d, ø [mm]	Rp ["]	AD [cm]	AD1 [cm]	L [cm]	L1 [cm]	I [cm]	I1 [cm]	SU4 [pc.]	SU2 [pc.]	SU1 [pc.]	GBP/pc.
602.780.00.5	15	20	1/2	15.3	7.3	59.7	5.2	25.3	4	140	5	1	34.82

**Accessories**

- Drain pipe bracket for Geberit mounting plates → p. 54

### Geberit Mepla elbow tap connector 90° pre-mounted, double

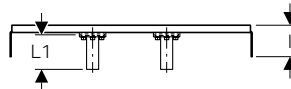
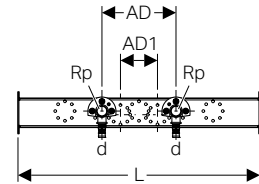
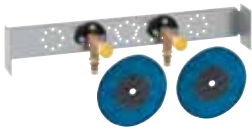

**Application purposes**

- For drywall construction
- For technical building systems, industry and shipbuilding
- Application overview: Geberit Mepla → p. 9

**Characteristics**

- Leaky if unpressed
- Sound-absorbing
- O-ring made of EPDM
- Pressing nipple with transparent protective cap
- Protection plug for pressure test with cold water up to max. 15 bar / 1500 kPa
- Connecting distance AD can be changed to AD1

**Technical data**

Material	Gunmetal (CuSn5Zn5Pb2-C)
----------	--------------------------

**Scope of delivery**

- 2 sealing washers
- 2 protection plugs
- Fastening material

Art. no.	DN	d, ø [mm]	Rp ["]	AD [cm]	AD1 [cm]	L [cm]	L1 [cm]	I [cm]	SU4 [pc.]	SU2 [pc.]	SU1 [pc.]	GBP/pc.
602.784.00.5	15	20	1/2	15.3	7.7	50	7.8	6.6	140	5	1	61.62

**Accessories**

- Drain pipe bracket for Geberit mounting plates → p. 54

### Geberit Mepla elbow tap connector 90°, pre-mounted, double, with drain pipe bracket and connection bend

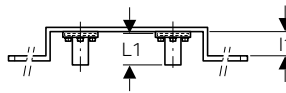
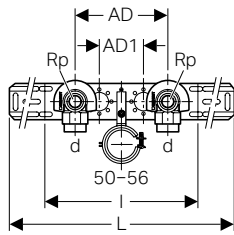

**Application purposes**

- For technical building systems, industry and shipbuilding
- Application overview: Geberit Mepla → p. 9

**Characteristics**

- Leaky if unpressed
- Sound-absorbing
- O-ring made of EPDM
- Pressing nipple with transparent protective cap
- Protection plug for pressure test with cold water up to max. 15 bar / 1500 kPa
- Connecting distance AD can be changed to AD1

**Technical data**

Material	Gunmetal (CuSn5Zn5Pb2-C)
----------	--------------------------

**Scope of delivery**

- Pipe bracket for outlet bend
- Connection bend 90° made of PE-HD, ø 50 mm
- 2 protection plugs
- Fastening material

Art. no.	DN	d, ø [mm]	Rp [""]	AD [cm]	AD1 [cm]	L [cm]	L1 [cm]	I [cm]	I1 [cm]	SU4 [pc.]	SU2 [pc.]	SU1 [pc.]	GBP/pc.
602.783.00.5	15	20	1/2	15.3	7.3	59.7	5.2	25.3	4	60	5	1	39.95

### Geberit elbow tap connector 90°, pre-mounted, single, for MeplaFix

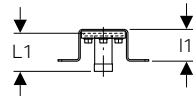
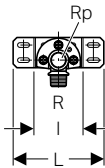

**Application purposes**

- For timber construction
- For technical building systems, industry and shipbuilding
- Application overview: Geberit Mepla → p. 9

- Male thread for connection of Geberit MeplaFix adaptor
- MeplaFix connection with blue protective cap
- Protection plug for pressure test with cold water up to max. 15 bar / 1500 kPa

**Characteristics**

- Self-adhesive sealing washer, fleece-laminated
- Sound-absorbing
- Male thread

**Technical data**

Material	Gunmetal (CuSn5Zn5Pb2-C)
----------	--------------------------

**Scope of delivery**

- Sealing washer
- Protection plug
- Fastening material

Art. no.	DN	R [""]	Rp [""]	L [cm]	L1 [cm]	I [cm]	I1 [cm]	SU2 [pc.]	SU1 [pc.]	GBP/pc.
632.856.00.1	15	MF 1/2	1/2	12	5.7	6.5	4	10	1	26.43

## Geberit elbow tap connector 90°, pre-mounted, double, for MeplaFix

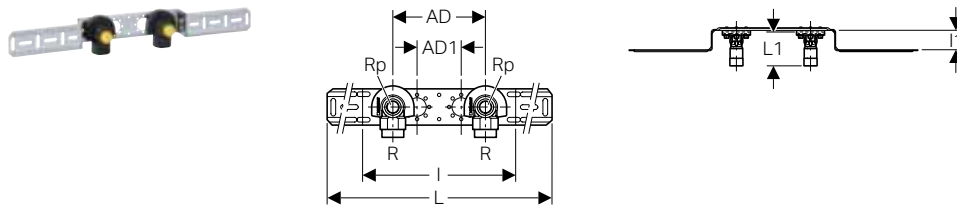

### Application purposes

- For technical building systems, industry and shipbuilding
- Application overview: Geberit Mepla → p. 9

### Characteristics

- Sound-absorbing
- Male thread
- Male thread for connection of Geberit MeplaFix adaptor
- MeplaFix connection with blue protective cap
- Protection plug for pressure test with cold water up to max. 15 bar / 1500 kPa
- Connecting distance AD can be changed to AD1

### Technical data

Material	Gunmetal (CuSn5Zn5Pb2-C)
----------	--------------------------

### Scope of delivery

- 2 protection plugs
- Fastening material

Art. no.	DN	R ["]	Rp ["]	AD [cm]	AD1 [cm]	L [cm]	L1 [cm]	I [cm]	I1 [cm]	SU4 [pc.]	SU2 [pc.]	SU1 [pc.]	GBP/pc.
632.859.00.1	15	MF 1/2	1/2	15.3	7.3	59.7	5.2	25.3	4	140	5	1	43.92

### Accessories

- Drain pipe bracket for Geberit mounting plates → p. 54

**New**

## Geberit Mepla elbow tap connector 90° for concealed cistern

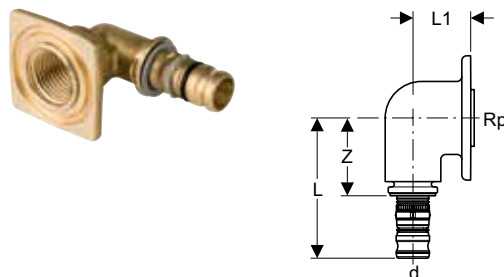

### Application purposes

- For potable water
- For technical building systems, industry and shipbuilding
- Application overview: Geberit Mepla → p. 9

### Characteristics

- Leaky if unpressed
- Fastening flange for Geberit Sigma concealed cistern 8 cm
- O-ring made of EPDM
- Pressing nipple with transparent protective cap

### Technical data

Material	Brass CW617N
----------	--------------

Art. no.	DN	d, ø [mm]	Rp ["]	L [cm]	I [cm]	Z [cm]	SU3 [pc.]	SU2 [pc.]	GBP/pc.
611.277.00.6	12	16	1/2	5.8	2.8	3.2	25	5	12.00
612.277.00.6	15	20	1/2	6.1	2.8	3.2	25	5	12.00

Available as of April 2016

## Geberit Mepla elbow tap connector 90° for concealed cistern

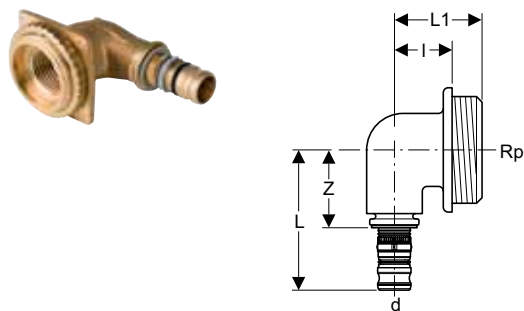

### Application purposes

- For potable water
- For technical building systems, industry and shipbuilding
- Application overview: Geberit Mepla → p. 9

### Characteristics

- Leaky if unpressed
- Fastening flange for Geberit Twinline concealed cistern 8 cm
- O-ring made of EPDM
- Pressing nipple with transparent protective cap

### Technical data

Material	Gunmetal (CuSn5Zn5Pb2-C)
----------	--------------------------

### Scope of delivery

- Knurled nut M35 x 1.5

Art. no.	DN	d, ø [mm]	Rp ["]	L [cm]	L1 [cm]	I [cm]	Z [cm]	SU4 [pc.]	SU3 [pc.]	SU2 [pc.]	SU1 [pc.]	GBP/pc.
601.276.00.5	12	16	1/2	5.8	3.8	2.8	3.2	1600	50	10	1	14.96
602.276.00.5	15	20	1/2	6.1	3.8	2.8	3.2		50	10	1	14.96

## 1.4.9 Manifolds with threaded connection

### Geberit Mepla union connector, for Euro cone

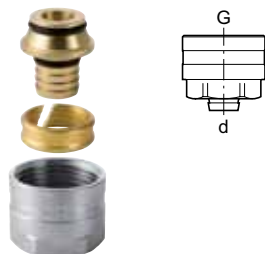

### Application purposes

- For Geberit Mepla system pipes, ML
- Exclusively suitable for heating and cooling
- Application overview: Geberit Mepla → p. 9

### Characteristics

- Clamping ring union
- Union nut made of brass, nickel-plated
- O-ring made of EPDM

### Technical data

Material	Brass CW617N
----------	--------------

Art. no.	DN	d, ø [mm]	G ["]	SW [mm]	SU4 [pc.]	SU3 [pc.]	SU2 [pc.]	GBP/pc.
641.534.22.2	12	16	3/4	27	50	10	2	2.82
642.534.22.2	15	20	3/4	27	50	10	2	2.82

## Geberit manifold with threaded connection

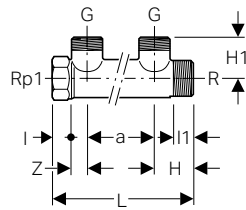

### Application purposes

- For technical building systems, industry and shipbuilding
- Application overview: Geberit Mepla → p. 9

### Characteristics

- Connection nipple for manifold, with Euro cone G 3/4

### Technical data

Material	Gunmetal (CuSn5Zn5Pb2-C)
----------	--------------------------

Art. no.	DN	R ["]	G ["]	Rp1 ["]	a [cm]	H [cm]	H1 [cm]	L [cm]	I [cm]	l1 [cm]	Z [cm]	Number of outlets	SU2 [pc.]	SU1 [pc.]	GBP/pc.
602.422.00.1	20 / 15 / 20	3/4	3/4	3/4	5	3.2	3.2	10.9	1.5	1.5	1.3	2	5	1	27.23
602.423.00.1	20 / 15 / 20	3/4	3/4	3/4	5	3.2	3.2	16	1.5	1.5	1.3	3	5	1	36.84

## Geberit plug with male thread

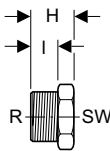

### Application purposes

- For technical building systems, industry and shipbuilding
- For permanently closing Geberit manifolds with threaded connection
- Application overview: Geberit Mepla → p. 9

### Technical data

Material	Gunmetal (CuSn5Zn5Pb2-C)
----------	--------------------------

Art. no.	DN	R ["]	H [cm]	I [cm]	SW [mm]	SU2 [pc.]	GBP/pc.
602.480.00.1	20	3/4	2.6	1.5	27	5	4.97

## Geberit cap with female thread

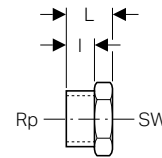

### Application purposes

- For technical building systems, industry and shipbuilding
- For permanently closing Geberit manifolds with threaded connection
- Application overview: Geberit Mepla → p. 9

### Technical data

Material	Gunmetal (CuSn5Zn5Pb2-C)
----------	--------------------------

Art. no.	DN	Rp ["]	L [cm]	I [cm]	SW [mm]	SU3 [pc.]	SU2 [pc.]	GBP/pc.
602.482.00.1	20	3/4	2.1	1.5	34	25	5	4.61

## 1.4.10 T-pieces for heating

### Geberit Mepla T-piece crossing with insulation box

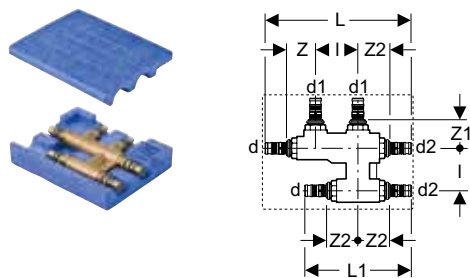

#### Application purposes

- For connecting to two parallel pipes without intersecting
- Exclusively suitable for heating and cooling
- Application overview: Geberit Mepla → p. 9

#### Characteristics

- Leaky if unpressed
- O-ring made of EPDM
- Pressing nipple with transparent protective cap

#### Technical data

Material	Brass CW617N
Material, insulation	EPP
Insulation thickness	8.5 mm
Thermal conductivity, insulation	0.038 W/(m · K)

Art. no.	DN	d, ø [mm]	d1, ø [mm]	d2, ø [mm]	H [cm]	L [cm]	L1 [cm]	I [cm]	Z [cm]	Z1 [cm]	Z2 [cm]	SU4 [pc.]	SU2 [pc.]	SU1 [pc.]	GBP/pc.
611.319.00.5	12 / 12 / 12	16	16	16	5	17.1	12.5	5	3.3	3.3	3.7	200	10	1	34.42
612.316.00.5	15 / 12 / 12	20	16	16	5	17.3	12.7	5	3.3	3.3	3.7	200	10	1	34.42
612.315.00.5	15 / 12 / 15	20	16	20	5	17.5	12.9	5	3.3	3.3	3.7	200	10	1	34.42
612.319.00.5	15 / 15 / 15	20	20	20	5	17.8	13.2	5	3.3	3.3	3.7	200	10	1	34.42
613.312.00.5	20 / 12 / 15	26	16	20	5	18.2	13.2	5	3.6	3.3	3.6		10	1	38.77
613.314.00.5	20 / 12 / 20	26	16	26	5	18.6	13.6	5	3.6	3.3	3.6	200	10	1	38.77
613.313.00.5	20 / 15 / 20	26	20	26	5	18.6	13.6	5	3.6	3.3	3.6	200	10	1	38.77

## 1.4.11 Connections for heating

### Geberit Mepla connector box type C

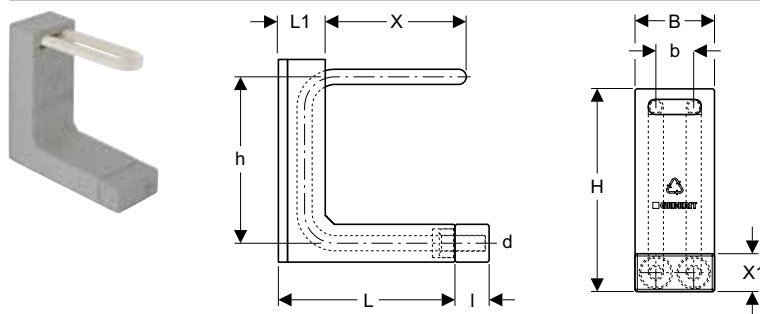

#### Application purposes

- Exclusively suitable for heating and cooling
- Application overview: Geberit Mepla → p. 9

#### Characteristics

- System pipe forms a barrier against diffusion
- System pipe, white exterior
- For pressure test without radiator

#### Technical data

Material	PE-Xb / Al / PE-HD
Material, insulation	EPS
Insulation thickness	13 mm
Thermal conductivity, insulation	0.031 W/(m · K)

Art. no.	DN	d, ø [mm]	B [cm]	b [cm]	H [cm]	h [cm]	L [cm]	L1 [cm]	I [cm]	X [cm]	X1 [cm]	SU4 [pc.]	SU2 [pc.]	SU1 [pc.]	GBP/pc.
611.260.00.1	12	16	10.5	5	27	22	21	5	4.5	19	5	80	10	1	18.63
612.260.00.1	15	20	10.5	5	27	22	22.3	6.3	4.5	18.5	5	80	10	1	19.77

#### Accessories

- Geberit Mepla union connector for Euro cone → p. 45

### Geberit Mepla connector box type L

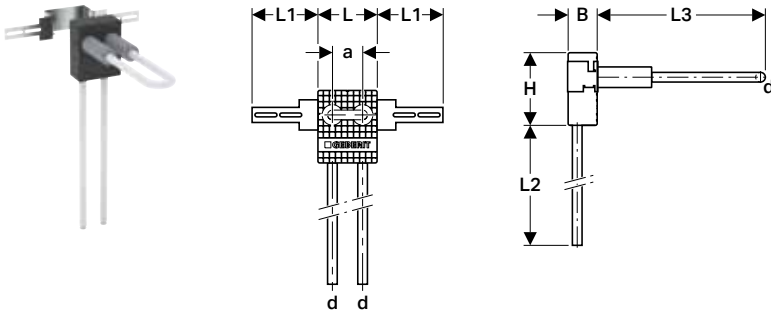

**Application purposes**

- Exclusively suitable for heating and cooling
- Application overview: Geberit Mepla → p. 9

**Characteristics**

- System pipe forms a barrier against diffusion
- System pipe, white exterior
- For pressure test without radiator

**Technical data**

Material	PE-Xb / AI / PE-HD
Material, insulation	PUR
Insulation thickness	7 mm
Thermal conductivity, insulation	0.038 W/(m · K)

**Scope of delivery**

- Installation sheet

Art. no.	DN	d, ø [mm]	a [cm]	B [cm]	H [cm]	L [cm]	L1 [cm]	L2 [cm]	L3 [cm]	SU2 [pc.]	SU1 [pc.]	GBP/pc.
611.263.00.1	12	16	5	5	12	10	11	35	25	10	1	22.41

**Accessories**

- Geberit Mepla union connector for Euro cone → p. 45

### Geberit Mepla connector box type T

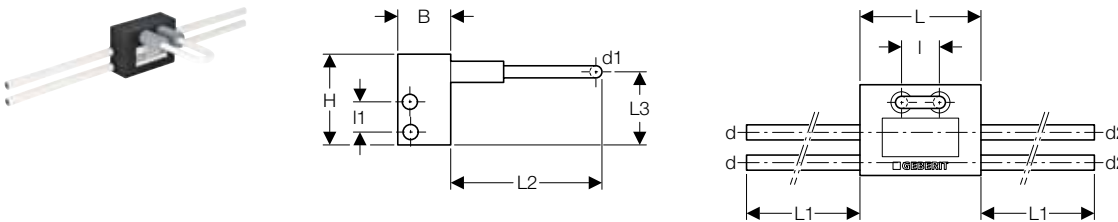

**Application purposes**

- Exclusively suitable for heating and cooling
- Application overview: Geberit Mepla → p. 9

**Characteristics**

- System pipe forms a barrier against diffusion
- System pipe, white exterior
- For pressure test without radiator

**Technical data**

Material	PE-Xb / AI / PE-HD
Material, insulation	PUR
Insulation thickness	6 mm
Thermal conductivity, insulation	0.03 W/(m · K)

Art. no.	DN	d, ø [mm]	d1, ø [mm]	d2, ø [mm]	B [cm]	H [cm]	L [cm]	L1 [cm]	L2 [cm]	L3 [cm]	I [cm]	I1 [cm]	SU4 [pc.]	SU2 [pc.]	GBP/pc.
612.265.00.1	15 / 12 / 15	20	16	20	7	12	16	30	20	8	5	4	80	10	100.75

**Accessories**

- Geberit Mepla union connector for Euro cone → p. 45

## Geberit Mepla metal pipe connector bend 90° with union connector for Euro cone

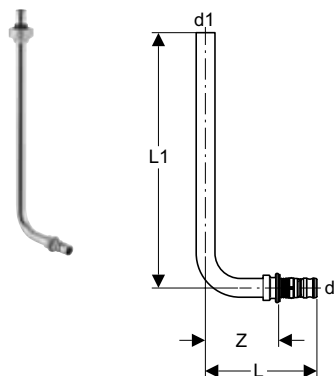

### Application purposes

- For connecting radiator valves
- Exclusively suitable for heating and cooling
- Application overview: Geberit Mepla → p. 9

### Characteristics

- Leaky if unpressed
- Nickel-plated
- O-ring made of EPDM
- Pressing nipple with transparent protective cap

### Technical data

Material	Brass / copper
----------	----------------

### Scope of delivery

- Union connector for Euro cone G 3/4

Art. no.	DN	d, ø [mm]	d1, ø [mm]	L [cm]	L1 [cm]	Z [cm]	SU4 [pc.]	SU3 [pc.]	SU2 [pc.]	GBP/pc.
611.250.22.5	12	16	15	9.1	30	6.6	1200	20	2	13.24
612.250.22.5	15	20	15	9.3	30	6.6		20	2	14.45
612.251.22.5	15	20	15	9.3	100	6.6			2	23.05

### Accessories

- Geberit insulation box for metal pipe connector bend and connector T-pieces → p. 47

## Geberit Mepla metal pipe connector T-piece with union connector for Euro cone

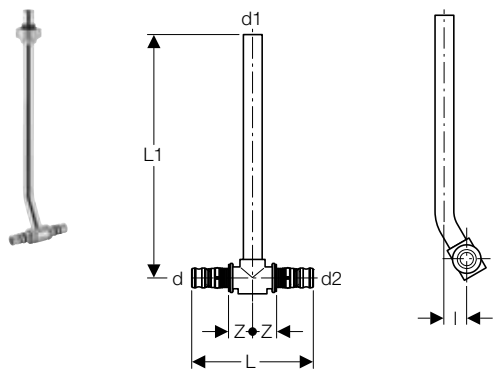

### Application purposes

- For connecting radiator valves
- Exclusively suitable for heating and cooling
- Application overview: Geberit Mepla → p. 9

### Characteristics

- Leaky if unpressed
- Nickel-plated
- O-ring made of EPDM
- Pressing nipple with transparent protective cap

### Technical data

Material	Brass / copper
----------	----------------

### Scope of delivery

- Union connector for Euro cone G 3/4

Art. no.	DN	d, ø [mm]	d1, ø [mm]	d2, ø [mm]	L [cm]	L1 [cm]	l [cm]	Z [cm]	SU3 [pc.]	SU2 [pc.]	GBP/pc.
612.362.22.5	15	20	15	20	8.4	30	2.5	1.7	20	2	17.46

### Accessories

- Geberit insulation box for metal pipe connector bend and connector T-pieces → p. 47

New

**Geberit Mepla connector T-piece set for inlet and return flow, with union connector for Euro cone**

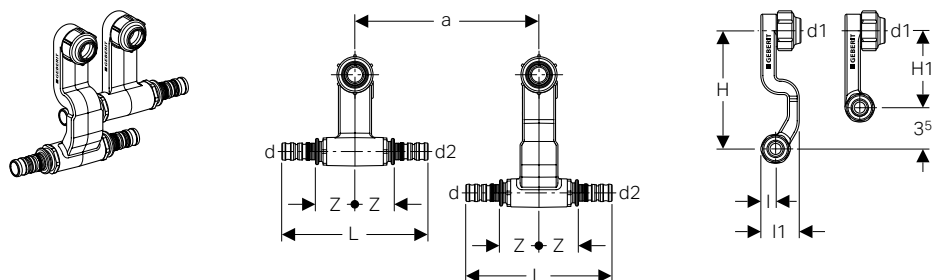

**Application purposes**

- For skirting board systems
- Exclusively suitable for heating and cooling
- Application overview: Geberit Mepla → p. 9

**Characteristics**

- Leaky if unpressed
- Inlet and return flow exchangeable
- Nickel-plated
- O-ring made of EPDM
- Pressing nipple with transparent protective cap
- Installation completely in front of the wall

**Technical data**

Material	Brass CW617N
----------	--------------

**Scope of delivery**

- Connector T-piece with short connection
- Connector T-piece with long connection
- 2 union connectors for Euro cone G 3/4

Art. no.	DN	d, ø [mm]	d1, ø [mm]	d2, ø [mm]	a [cm]	H [cm]	H1 [cm]	L [cm]	I [cm]	I1 [cm]	Z [cm]	SU2 [pc.]	SU1 [pc.]	GBP/pc.
611.361.22.6	12	16	15	16	5	10	6.5	11.9	1.3	3.3	3.4	10	1	26.75
612.361.22.6	15	20	15	20	5	10	6.5	12.4	1.3	3.3	3.4	10	1	28.00

Available as of April 2016

### Geberit metal pipe elbow 90°, lockable, with union connector for Euro cone

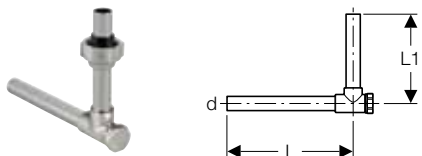

#### Application purposes

- For connecting radiator valves
- Exclusively suitable for heating and cooling
- Application overview: Geberit Mepla → p. 9

#### Characteristics

- Nickel-plated

#### Technical data

Material	Brass / copper
----------	----------------

#### Scope of delivery

- Union connector for Euro cone G 3/4

Art. no.	DN	d, ø [mm]	L [cm]	L1 [cm]	SU4 [pc.]	SU3 [pc.]	SU2 [pc.]	GBP/pc.
611.603.22.2	12	15	12.5	10	50	10	2	8.77

### Geberit Mepla union connector for Euro cone

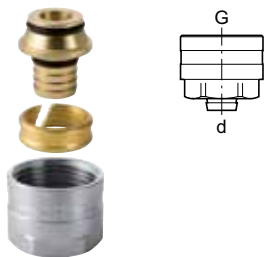

#### Application purposes

- For Geberit Mepla system pipes, ML
- Exclusively suitable for heating and cooling
- Application overview: Geberit Mepla → p. 9

#### Characteristics

- Clamping ring union
- Union nut made of brass, nickel-plated
- O-ring made of EPDM

#### Technical data

Material	Brass CW617N
----------	--------------

Art. no.	DN	d, ø [mm]	G ["]	SW [mm]	SU4 [pc.]	SU3 [pc.]	SU2 [pc.]	GBP/pc.
641.534.22.2	12	16	3/4	27	50	10	2	2.82
642.534.22.2	15	20	3/4	27	50	10	2	2.82

### Geberit Mepla union connector with male thread

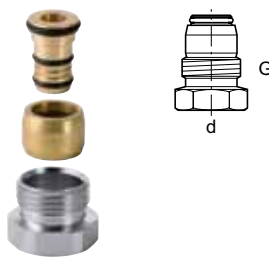

#### Application purposes

- For Geberit Mepla system pipes, ML
- For connecting to radiator valves Danfoss with female thread G 1/2
- Exclusively suitable for heating and cooling
- Application overview: Geberit Mepla → p. 9

#### Characteristics

- Clamping ring union
- Threaded nipple made of brass, nickel-plated
- O-ring made of EPDM

#### Technical data

Material	Brass CW617N
----------	--------------

Art. no.	DN	d, ø [mm]	G ["]	SW [mm]	SU4 [pc.]	SU3 [pc.]	SU2 [pc.]	GBP/pc.
641.513.00.1	12	16	1/2	22	50	10	2	2.88

### Geberit Mepla union connector with male thread

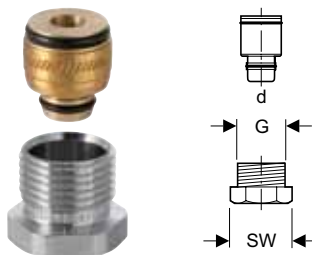

#### Application purposes

- For Geberit Mepla system pipes, ML
- For connecting to radiator valves Heimeier with female thread G 1/2
- Exclusively suitable for heating and cooling
- Application overview: Geberit Mepla → p. 9

#### Characteristics

- Clamping ring union
- Threaded nipple made of brass, nickel-plated
- O-ring made of EPDM

#### Technical data

Material	Brass CW617N
----------	--------------

Art. no.	DN	d, ø [mm]	G ["]	SW [mm]	SU4 [pc.]	SU3 [pc.]	SU2 [pc.]	GBP/pc.
641.515.00.1	12	16	1/2	22	50	10	2	3.03

## Geberit Mepla union connector with male thread

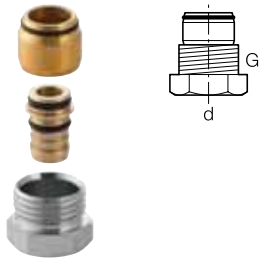

### Application purposes

- For Geberit Mepla system pipes, ML
- For connecting to radiator valves Herz with female thread G 1/2 in accordance with EN 215, construction dimension series D
- Exclusively suitable for heating and cooling
- Application overview: Geberit Mepla → p. 9

### Characteristics

- Clamping ring union
- Threaded nipple made of brass, nickel-plated
- O-ring made of EPDM

### Technical data

Material	Brass CW617N						
Art. no.	DN	d, ø [mm]	G ["]	SW [mm]	SU3 [pc.]	SU2 [pc.]	GBP/pc.
641.516.22.1	12	16	1/2	22	10	2	2.88

## Geberit Mepla union connector with female thread

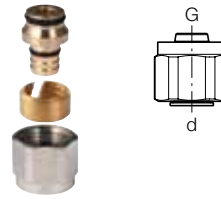

### Application purposes

- For Geberit Mepla system pipes, ML
- For connecting to manifolds and radiator valves with clamping ring union G 1/2
- Exclusively suitable for heating and cooling
- Application overview: Geberit Mepla → p. 9

### Characteristics

- Clamping ring union
- Union nut made of brass, nickel-plated
- O-ring made of EPDM

### Technical data

Material	Brass CW614N					
Art. no.	DN	d, ø [mm]	G ["]	SU3 [pc.]	SU2 [pc.]	GBP/pc.
641.517.22.1	12	16	1/2	10	2	6.14

## Geberit Mepla union connector with female thread

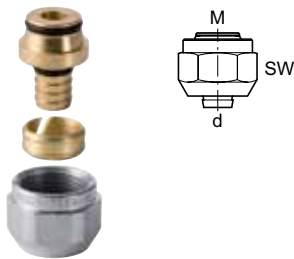

### Application purposes

- For Geberit Mepla system pipes, ML
- For connecting to radiator valves Herz with male thread M22 x 1.5
- Exclusively suitable for heating and cooling
- Application overview: Geberit Mepla → p. 9

### Characteristics

- Clamping ring union
- Union nut made of brass, nickel-plated
- O-ring made of EPDM

### Technical data

Material	Brass CW617N							
Art. no.	DN	d, ø [mm]	M [mm]	SW [mm]	SU4 [pc.]	SU3 [pc.]	SU2 [pc.]	GBP/pc.
641.514.00.1	12	16	22 x 1.5	27	50	10	2	2.88

## 1.5 Accessories

### 1.5.1 Insulations for pipes and fittings

#### Geberit insulation hose

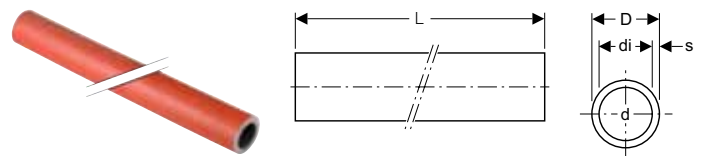

### Application purposes

- For protecting pipes against the formation of condensation, heat loss and sound transmission

### Characteristics

- Closed-cell insulation, red protective foil

### Technical data

Material, insulation	PE soft foam							
Thermal conductivity, insulation	0.04 W/(m · K)							
Art. no.	d, ø [mm]	di, ø [mm]	D [cm]	s [mm]	L [m]	SU3 [m]	SU2 [m]	GBP/m
601.800.00.1	16	18	3	6	2	160	2	2.75
602.800.00.1	20	22	3.4	6	2	120	2	3.04
603.800.00.1	26	28	4	6	2	100	2	3.19

## 1.5.2 Insulations for connectors

### Geberit sound insulation set for single elbow tap connector 90°

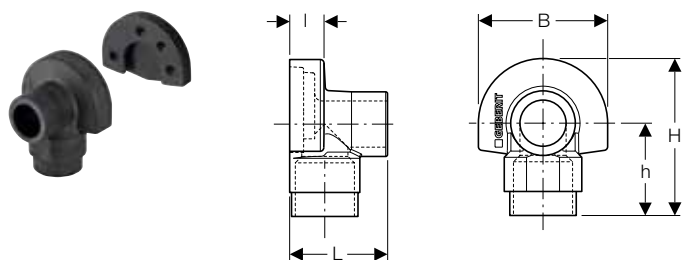

#### Application purposes

- For Geberit elbow tap connector with female thread Rp 1/2

#### Characteristics

- Black

#### Technical data

Noise reduction at 3 bar flow pressure	12 dB(A)
Material	EPDM

#### Scope of delivery

- Sound insulation cap
- Sound insulation base

Art. no.	B	H	h	L	I	SU3	SU2	SU1	GBP/pc.
	[cm]	[cm]	[cm]	[cm]	[cm]	[pc.]	[pc.]	[pc.]	
601.801.00.1	7	8.5	5	5.3	1.9	50	10	1	2.66

### Geberit sound insulation set for double elbow tap connector 90°

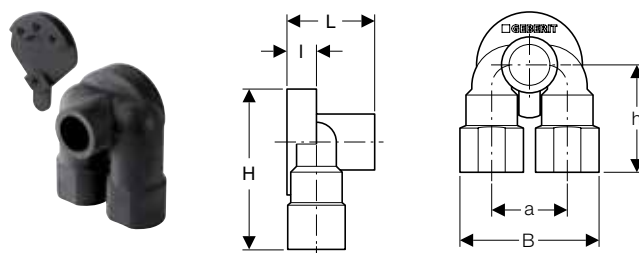

#### Application purposes

- For Geberit double elbow tap connector with female thread Rp 1/2

#### Characteristics

- Black

#### Technical data

Noise reduction at 3 bar flow pressure	12 dB(A)
Material	EPDM

#### Scope of delivery

- Sound insulation cap
- Sound insulation base

Art. no.	a	B	H	h	L	I	SU3	SU2	SU1	GBP/pc.
	[cm]	[cm]	[cm]	[cm]	[cm]	[cm]	[pc.]	[pc.]	[pc.]	
601.805.00.1	5	9.2	10.6	7.1	5.3	2	50	10	1	9.57

### Geberit sound insulation base for tap connector, straight



#### Application purposes

- For Geberit tap connector, straight, with female thread Rp 1/2

#### Characteristics

- Black

#### Technical data

Material	EPDM		
Art. no.	SU3	SU2	GBP/pc.
	[pc.]	[pc.]	
601.802.00.1	100	10	0.71

### Geberit insulation box for metal pipe connector bend and connector T-pieces

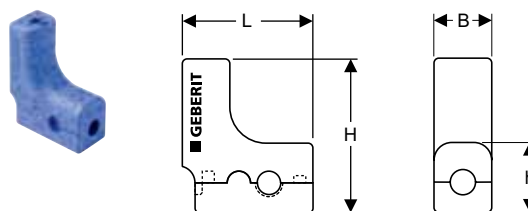

#### Characteristics

- Blue
- Two-piece

#### Technical data

Material, insulation	EPP
Insulation thickness	7.5 mm
Thermal conductivity, insulation	0.04 W/(m · K)

Art. no.	B	H	h	L	SU4	SU3	SU2	GBP/pc.
	[cm]	[cm]	[cm]	[cm]	[pc.]	[pc.]	[pc.]	
601.720.00.1	5	13	6	11	480	20	2	2.43

### 1.5.3 Caulks for pipes and fittings

#### Geberit sealing tape

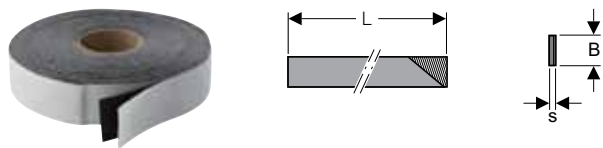

##### Application purposes

- For protecting Geberit Mapress system pipes and fittings against external corrosion factors
- For protecting the pipe cross-sections of Geberit Mepla against external corrosion factors
- For protecting Geberit PushFit fittings against external corrosion factors

##### Characteristics

- Black

##### Technical data

Installation temperature	-10 - +50 °C
Temperature resistance	-60 - +100 °C
Material	IIR

Art. no.	s [mm]	B [cm]	L [m]	SU3 [pc.]	SU1 [pc.]	GBP/pc.
601.813.00.1	1	3	12.5	6	1	28.00
601.815.00.1	1	5	12.5	5	1	46.62

#### Geberit Mepla sleeve



##### Application purposes

- For protecting the pipe cross-sections of Geberit Mepla against external corrosion factors

##### Characteristics

- Black

##### Technical data

Material	EPDM
----------	------

Art. no.	da [mm]	di, ø [mm]	L [cm]	SU3 [pc.]	SU2 [pc.]	GBP/pc.
601.811.00.1	19	16	2	100	10	1.94
602.811.00.1	23	20	2.1	100	10	0.37
603.811.00.1	29	26	2.3	100	10	2.37

### 1.5.4 Caulks for connections

#### Geberit sealing washer for connections

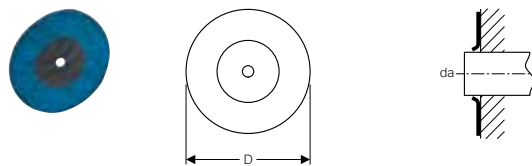

##### Application purposes

- For sealing Geberit connections in drywall construction
- For later mounting on connections with smooth surface

##### Characteristics

- Self-adhesive
- Fleece-laminated
- Sealing diaphragm made of PUR

Art. no.	da [mm]	D [cm]	SU3 [pc.]	SU2 [pc.]	SU1 [pc.]	GBP/pc.
601.812.00.1	12-35	12	100	10	1	1.78

### 1.5.5 Pipe covers

#### Geberit pipe sleeve, slit



##### Application purposes

- For cladding visible pipes

##### Characteristics

- Pure white RAL 9010

##### Technical data

Material	PP
----------	----

Art. no.	di, ø [mm]	L [m]	SU2 [m]	GBP/m
611.605.BM.1	15-20	1	5	2.02

#### Geberit double collar



##### Application purposes

- For covering pipe feed-throughs

##### Characteristics

- Two-piece
- Pure white RAL 9010

##### Technical data

Material	PS
----------	----

Art. no.	a [cm]	di, ø [mm]	B [cm]	L [cm]	SU3 [pc.]	SU2 [pc.]	GBP/pc.
611.610.BM.1	5	14 / 15 / 16 / 18 / 20	5	10	100	10	1.01

## 1.5.6 Pipe fastenings

### Geberit single pipe clip

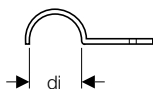

#### Application purposes

- For fastening Geberit system pipes

#### Characteristics

- Zinc-plated

#### Technical data

Material	Steel
----------	-------

Art. no.	di, $\emptyset$ [mm]	SU2 [pc.]	GBP/pc.
601.763.00.1	16	100	0.23
602.763.00.1	20	100	0.31
601.761.00.1	22	100	0.18
602.761.00.1	28	100	0.30

### Geberit pipe clamp with hammer fixing, single



#### Application purposes

- For fastening Geberit system pipes

#### Characteristics

- Nail made of steel, zinc-plated

#### Technical data

Material	Plastic
----------	---------

Art. no.	di, $\emptyset$ [mm]	SU3 [pc.]	GBP/pc.
601.710.00.1	15-16	100	1.08
602.710.00.1	20-22	100	1.19
603.710.00.1	25-28	100	1.37

### Geberit double pipe-clip

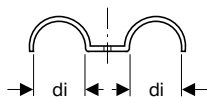

#### Application purposes

- For fastening Geberit system pipes

#### Characteristics

- Zinc-plated

#### Technical data

Material	Non-alloy steel 1.0215 E220 (EN 10305)
----------	--

Art. no.	di, $\emptyset$ [mm]	SU2 [pc.]	GBP/pc.
602.762.26.1	28	50	0.46

**New**

## Geberit pipe bracket, insulated, with threaded socket M8 / M10

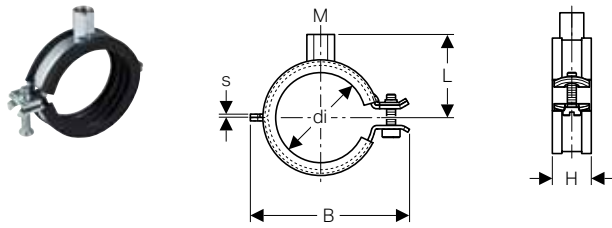

### Application purposes

- For fastening Geberit Mepla system pipes, ML
- For fastening Geberit PushFit system pipes, ML
- For fastening Geberit Mapress system pipes

### Characteristics

- Quick-lock
- Screw with slotted head and crosshead
- Threaded socket four-times welded
- Sound insulation in accordance with DIN 4109
- Zinc-plated

### Technical data

Material		Steel								
Art. no.	Colour / Surface	M [mm]	di, $\varnothing$ [mm]	s [mm]	B [cm]	H [cm]	L [cm]	SU2 [pc.]	GBP/pc.	
601.851.26.1	galvanized	8 / 10	15-19	1.5	5.2	2.3	3.1	50	1.29	
601.852.26.1	galvanized	8 / 10	20-24	1.5	5.6	2.3	3.4	50	1.29	
601.853.26.1	galvanized	8 / 10	25-30	1.5	6.3	2.3	3.6	50	1.40	
601.854.26.1	galvanized	8 / 10	32-37	1.5	6.8	2.3	3.9	50	1.50	
601.855.26.1	galvanized	8 / 10	40-46	2	7.6	2.3	4.3	50	1.61	
601.856.26.1	galvanized	8 / 10	48-53	2	8.2	2.3	4.5	50	1.72	
601.858.26.1	galvanized	8 / 10	63-67	2	10	2.3	5.5	50	2.58	
601.859.26.1	galvanized	8 / 10	74-80	2	11.9	2.3	6.4	50	2.68	
601.860.26.1	galvanized	8 / 10	83-91	2	13	2.3	6.8	50	2.79	

Available as of M20 2016

## Geberit Mepla pipe bracket lining shell

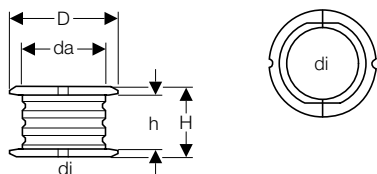

### Application purposes

- For anchor point or sliding bracket fastening of Geberit Mepla system pipes, ML

### Characteristics

- Two-piece
- Black

### Technical data

Material		PP-C						
Art. no.	da [mm]	di, ø [mm]	D [cm]	H [cm]	h [cm]	SU2 [pc.]	SU1 [pc.]	GBP/pc.
603.702.00.1	32	26	3.4	3.2	2.5	10		1.76
604.702.00.1	40	32	4.9	3.2	2.5	10		1.76
605.702.00.1	50	40	5.7	3.3	2.5	10		2.43
606.702.00.1	63	50	7.6	3.4	2.5	10		2.89
607.702.00.1	75	63	9.1	4.8	3		1	4.56
608.702.00.1	90	75	10.7	5	3	2		17.07

## Geberit support shell, zinc-plated and coated

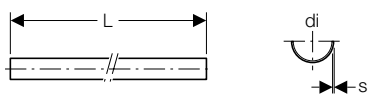

### Application purposes

- For sanitary, heating and industrial installations
- For fastening pipes
- For stabilising Geberit fastening systems

### Characteristics

- Coated
- Steel, black coated exterior
- Zinc-plated

### Technical data

Material		Steel						
Art. no.	DN	di, ø [mm]	s [mm]	L [m]	SU4 [m]	SU3 [m]	SU2 [m]	GBP/m
360.850.00.1	40	40	0.75	3		30	3	20.38
361.850.00.1	50	50	0.75	3	3630	30	3	22.78
364.850.00.1	60	63	0.75	3	2550	30	3	30.70
365.850.00.1	70	75	0.75	3	2400	30	3	31.00

## Geberit double nipple

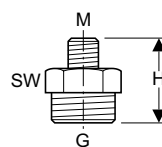

### Application purposes

- For building drainage

### Characteristics

- Reduced
- Zinc-plated

### Technical data

Material		Steel					
Art. no.	Colour / Surface	G ["]	M [mm]	H [cm]	SW [mm]	SU1 [pc.]	GBP/pc.
362.856.26.1	galvanized	1/2	10	2.8	22	1	1.65

## Geberit threaded pipe

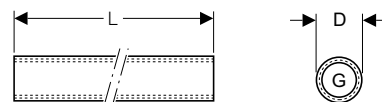
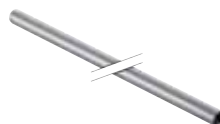

### Application purposes

- For fastening Geberit pipe brackets to base plates
- For building drainage
- For anchor point and sliding bracket fastenings

### Characteristics

- Female thread continuously threaded
- Zinc-plated

### Technical data

Material		Steel					
Art. no.	G ["]	D [cm]	L [m]	SU2 [pc.]	SU1 [pc.]	GBP/pc.	
362.857.26.1	1/2	2.5	1	2	1	21.24	

## Geberit base plate, square, two-hole, with threaded socket M8 / M10

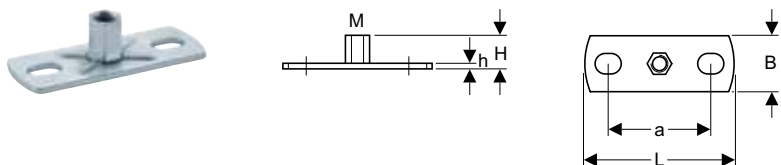

### Application purposes

- For building drainage
- For fastening pipe brackets to the building structure
- For fastening pipes to ceilings and walls
- For fastening support rails to the building structure
- For sliding bracket fastening of pipes

### Characteristics

- Female thread
- Zinc-plated
- Two fastening points

### Technical data

Material							Steel			
Art. no.	M	a	B	H	h	L	SU3	SU1	GBP/pc.	
	[mm]	[cm]	[cm]	[cm]	[cm]	[cm]	[pc.]	[pc.]		
362.848.26.1	8 / 10	5.4	3	1.9	0.3	8	50	1	2.64	

## Geberit base plate, square, two-hole, with threaded socket M10 / G 1/2

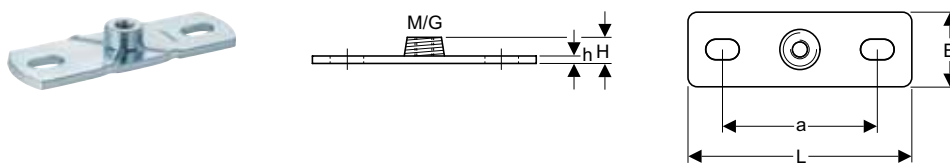

### Application purposes

- For fastening pipe brackets to the building structure
- For fastening pipes to ceilings and walls
- For anchor point and sliding bracket fastenings

### Characteristics

- Male thread
- Female thread
- Zinc-plated
- Two fastening points

### Technical data

Material							Steel			
Art. no.	G	M	a	B	H	h	L	SU3	SU1	GBP/pc.
	["]	[mm]	[cm]	[cm]	[cm]	[cm]	[cm]	[pc.]	[pc.]	
362.851.26.1	1/2	10	8.5	4	1.5	0.5	12	50	1	2.37



- Fastening material not included in the scope of delivery

## 1.5.7 Connector fastenings

### Geberit mounting plate, straight, single

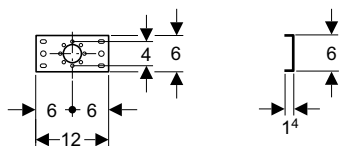

#### Application purposes

- For fastening Geberit Mepla connections
- For fastening Geberit Mapress connections
- For fastening Geberit PushFit connections

#### Characteristics

- Zinc-plated

#### Technical data

Material	Steel
----------	-------

#### Scope of delivery

- Fastening material

Art. no.	SU3 [pc.]	SU2 [pc.]	GBP/pc.
601.736.00.1	40	5	2.76

### Geberit mounting plate, straight, double, connecting distance 10 cm or 12 cm

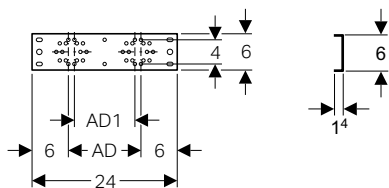

#### Application purposes

- For fastening Geberit Mepla connections
- For fastening Geberit Mapress connections
- For fastening Geberit PushFit connections

#### Characteristics

- Zinc-plated

#### Technical data

Material	Steel
----------	-------

#### Scope of delivery

- Fastening material

Art. no.	AD [cm]	AD1 [cm]	SU3 [pc.]	SU2 [pc.]	GBP/pc.
601.738.00.1	12	10	50	5	6.63

#### Accessories

- Drain pipe bracket for Geberit mounting plates → p. 54

### Geberit mounting plate, straight, double, connecting distance 7.3 cm or 15.3 cm

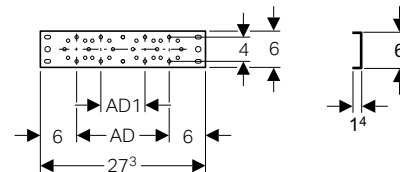

#### Application purposes

- For fastening Geberit Mepla connections
- For fastening Geberit Mapress connections
- For fastening Geberit PushFit connections

#### Characteristics

- Zinc-plated

#### Technical data

Material	Steel
----------	-------

#### Scope of delivery

- Fastening material

Art. no.	AD [cm]	AD1 [cm]	SU4 [pc.]	SU3 [pc.]	SU2 [pc.]	GBP/pc.
601.737.00.1	15.3	7.3	1500	50	5	3.68

#### Accessories

- Drain pipe bracket for Geberit mounting plates → p. 54

### Geberit mounting plate, offset, single

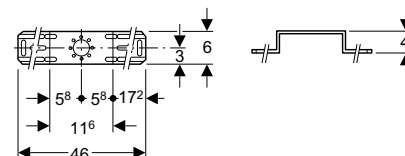

#### Application purposes

- For fastening Geberit Mepla connections
- For fastening Geberit Mapress connections
- For fastening Geberit PushFit connections

#### Characteristics

- Zinc-plated

#### Technical data

Material	Steel
----------	-------

#### Scope of delivery

- Fastening material

Art. no.	SU4 [pc.]	SU3 [pc.]	SU2 [pc.]	GBP/pc.
601.733.00.1	400	25	5	4.03

### Geberit mounting plate, offset, double, connecting distance 10 cm or 12 cm

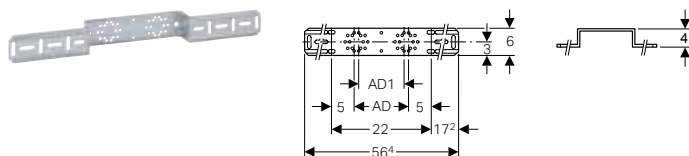

#### Application purposes

- For fastening Geberit Mepla connections
- For fastening Geberit Mapress connections
- For fastening Geberit PushFit connections

#### Characteristics

- Zinc-plated

#### Technical data

Material	Steel
----------	-------

#### Scope of delivery

- Fastening material

Art. no.	AD [cm]	AD1 [cm]	SU4 [pc.]	SU2 [pc.]	GBP/pc.
601.731.00.1	12	10	420	5	4.74

#### Accessories

- Drain pipe bracket for Geberit mounting plates → p. 54

### Geberit mounting plate, offset, double, connecting distance 7.3 cm or 15.3 cm

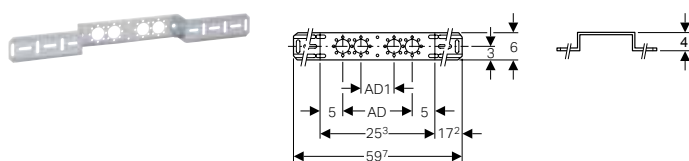

#### Application purposes

- For fastening Geberit Mepla connections
- For fastening Geberit Mapress connections
- For fastening Geberit PushFit connections

#### Characteristics

- Zinc-plated

#### Technical data

Material	Steel
----------	-------

#### Scope of delivery

- Fastening material

Art. no.	AD [cm]	AD1 [cm]	SU4 [pc.]	SU2 [pc.]	GBP/pc.
601.732.00.1	15.3	7.3	420	5	4.20

#### Accessories

- Drain pipe bracket for Geberit mounting plates → p. 54

### Drain pipe bracket for Geberit mounting plates

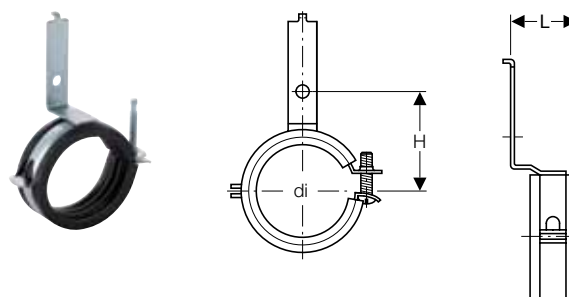

#### Characteristics

- Sound-absorbing
- Zinc-plated

#### Technical data

Material	Steel
----------	-------

#### Scope of delivery

- Fastening material

Art. no.	di, Ø [mm]	H [cm]	L [cm]	SU3 [pc.]	SU2 [pc.]	SU1 [pc.]	GBP/pc.
601.741.00.1	50-56	5.2-5.5	3.5	25	5	1	2.72

### Geberit mounting aid set for straight connector, for drywall construction



#### Characteristics

- Reusable

#### Scope of delivery

- Stud bolt G 1/2
- Protection box

Art. no.	G ["]	SU2 [pc.]	GBP/pc.
601.744.00.1	1/2	2	9.33

## 1.5.8 System seals

### Geberit Mepla set of O-ring and abrasive cut-off wheel



#### Application purposes

- For technical building systems, industry and shipbuilding
- For Geberit Mepla pressing nipples
- Application overview: Geberit Mepla → p. 9

#### Characteristics

- O-ring made of EPDM
- Flat washer made of PE-LD

#### Scope of delivery

- Set of 2 pieces

Art. no.	DN	d, ø [mm]	SU3 [pc.]	SU2 [pc.]	SU1 [pc.]	GBP/pc.
601.910.00.5	12	16	25	5	1	1.11
602.910.00.5	15	20	25	5	1	1.11
603.910.00.5	20	26	25	5	1	1.11
604.910.00.5	25	32		10	1	1.11
605.910.00.5	32	40		10	1	2.55
606.910.00.5	40	50		10	1	4.52
607.910.00.5	50	63		10	1	5.21
608.910.00.5	65	75		10	1	9.63

### Geberit flat gasket Centellen® R 3825

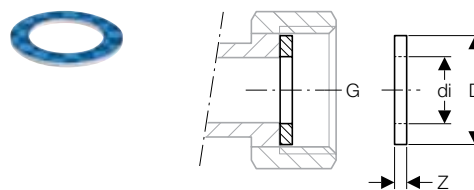

#### Application purposes

- For technical building systems, industry and shipbuilding
- For flat sealing Geberit Mepla screw connections
- Application overview: Geberit Mepla → p. 9

#### Technical data

Operating temperature	-30 - +150 °C
Material	Centellen® R 3825

Art. no.	G ["]	di, ø [mm]	D [cm]	Z [cm]	SU2 [pc.]	GBP/pc.
242.976.00.1	3/8	10	1.5	0.2	5	1.51
242.319.00.1	1/2	11	1.9	0.2	10	1.38
242.320.00.1	3/4	17	2.4	0.2	10	1.38
242.323.00.1	1	21	3	0.2	10	1.38
242.324.00.1	1 1/8	24	3.4	0.2	10	1.38
242.325.00.1	1 1/4	27	3.8	0.2	10	1.38
242.326.00.1	1 1/2	32	4.5	0.2	5	1.38
242.327.00.1	1 3/4	36	4.5	0.2	5	1.38
242.329.00.1	2	42	5.7	0.2	5	2.07
242.330.00.1	2 1/4	42	6.2	0.2	5	4.16
242.331.00.1	2 3/8	52	6.6	0.2	5	4.87
242.332.00.1	2 1/2	54	7.2	0.2	5	6.00
242.333.00.1	2 3/4	63	7.8	0.2	5	8.33

### Geberit flange gasket PN 6

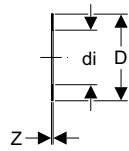

**Application purposes**

- For technical building systems, industry and shipbuilding
- Application overview: Geberit Mepla → p. 9

**Technical data**

Operating temperature	-30 - +180 °C
Material	Centellen® HD 3822

Art. no.	DN	di, ø [mm]	D [cm]	Z [cm]	PN [bar]	SU1 [pc.]	GBP/pc.
91047	65	76	11.6	0.2	6	1	4.09

### Geberit flange gasket PN 10/16

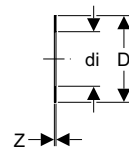

**Application purposes**

- For technical building systems, industry and shipbuilding
- Application overview: Geberit Mepla → p. 9

**Technical data**

Operating temperature	-30 - +180 °C
Material	Centellen® HD 3822

Art. no.	DN	di, ø [mm]	D [cm]	Z [cm]	PN [bar]	SU1 [pc.]	GBP/pc.
91037	65	76	12.7	0.2	10 / 16	1	3.22

## 1.5.9 Sets of bolts for flange connections

### Geberit bolt set for flange connection, made of steel zinc-plated

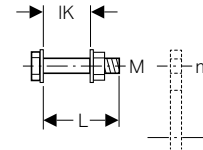

**Application purposes**

- For flanges made of carbon steel, gunmetal and brass

**Characteristics**

- Zinc-plated
- Strength class 8.8, EN 20898-2

**Technical data**

Material	Steel
----------	-------

**Scope of delivery**

- Bolt
- 2 washers
- Nut

Art. no.	M [mm]	m [cm]	L [cm]	IK [cm]	SU2 [pc.]	GBP/pc.
91066	12	1.4	5	3	4	1.57
91067	12	1.4	5.5	3.5	4	1.57
91068	12	1.4	6	4	4	1.57

### Geberit bolt set for flange connection, made of CrNi steel

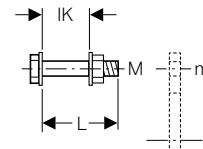

**Application purposes**

- For flanges made of stainless steel, gunmetal and brass

**Characteristics**

- Steel type A2, strength class 70, EN ISO 3506-1

**Technical data**

Material	CrNi steel 1.4301 (EN 10088)
----------	------------------------------

**Scope of delivery**

- Bolt
- 2 washers
- Nut

Art. no.	M [mm]	m [cm]	L [cm]	IK [cm]	SU2 [pc.]	GBP/pc.
91169	16	1.8	5.5	3.3	4	1.76
91170	16	1.8	6	3.8	4	1.76
91171	16	1.8	6.5	4.3	4	1.76
91172	16	1.8	7	4.8	4	1.76
91173	16	1.8	8	5.8	4	1.76

## 1.6 Appendix

### 1.6.1 Abbreviation

Abbreviation	Designation
I1	length, partial dimension (cm)
L2	length (cm)
I2	length, partial dimension (cm)
L3	length (cm)
I3	length, partial dimension (cm)
La	linear expansion (cm)
IK	grip length, screw (cm)
M	metric thread (mm)
m	bolt hole diameter (cm)
n	number of bolts, flange connection (PC)
PN	nominal pressure (bar)
R	taper external thread (")
r	radius (cm)
DN	nominal width
R1	taper external thread (")
Rg	round thread (")
Rp	taper internal pipe thread (")
Rp1	taper internal pipe thread (")
Rp2	taper internal pipe thread (")
S	pipe series
s	wall thickness (mm)
s1	wall thickness (mm)
SW	spanner width (mm)
A	projection (cm)
s ISO	wall thickness (for labels) (mm)
a	partial dimension (cm)
A1	projection (cm)
V	measuring range, volumetric flow rate (l/min)
a1	partial dimension (cm)
AB	connection area (mm)
AB1	connection area (mm)
AB2	connection area (mm)
Acm <sup>2</sup>	clear cross-sectional area (cm <sup>2</sup> )
AD	connecting distance (cm)
arc	angle (°)
AD1	connecting distance (cm)
B	width (cm)
b	partial dimension (cm)
B1	width (cm)
c	flange hole diameter (mm)
d, ø	outer diameter (mm)
UNC	inch thread
D	outer diameter (cm)
d1, ø	outer diameter (mm)
D1	outer diameter (cm)
d2, ø	outer diameter (mm)
d3, ø	outer diameter (mm)
da	outer pipe diameter (mm)

Abbreviation	Designation
di, ø	inner diameter (mm)
DN/OD	nominal width
DN	nominal width
E	insertion depth (cm)
E1	insertion depth (cm)
G	pipe thread (")
G1	pipe thread (")
X	leg length / L-dimension (cm)
X1	leg length / L-dimension (cm)
G2	pipe thread (")
X2	leg length / L-dimension (cm)
H	height (cm)
X3	leg length / L-dimension (cm)
h	height, partial dimension (cm)
H1	height (cm)
X4	leg length / L-dimension (cm)
h1	height, partial dimension (cm)
X5	leg length / L-dimension (cm)
h2	height, partial dimension (cm)
h3	height, partial dimension (cm)
k	flange, diameter of bolt circle (cm)
X6	leg length / L-dimension (cm)
Z	Z-dimension (cm)
Z1	Z-dimension (cm)
Z2	Z-dimension (cm)
Z3	Z-dimension (cm)
Z4	Z-dimension (cm)
K	maximum cutting (cm)
Z5	Z-dimension (cm)
K1	maximum cutting (cm)
Z6	Z-dimension (cm)
K2	maximum cutting (cm)
K3	maximum cutting (cm)
KL	cable length (cm)
L	length (cm)
I	length, partial dimension (cm)
L	L / length (m)
L1	length (cm)

## 1.6.2 Sales und delivery conditions

valid from 1st of April 2016

### GENERAL

1. In these Conditions of Sale "The Company" means Geberit Sales Ltd. "The Customer" means the person, firm or company with whom The Company contracts. "The Contract" Any contract between The Company and the Customer for the sale and purchase of the Goods incorporating the Conditions (including any part or parts of them). "The Goods" Any Goods agreed in the Contract to be supplied to the Customer by The Company (including any part or parts of them).
2. These Conditions of Sale apply to and govern any contract between The Company and the Customer to the exclusion of any other conditions contained on, or in, any letter, order form, receipt of similar document emanating from the Customer. No variation of these Conditions of Sale shall be effective unless expressly agreed by The Company in writing.
3. All quotations are for information only and are not to be considered as an offer by The Company. No Contract shall come into existence until an order by the Customer has been accepted by The Company.
- 3.1 Acceptance by The Company of any order shall be on the basis that Goods will be invoiced at the prices contained in The Company's price list current at the date of despatch unless otherwise agreed in writing by The Company.
4. Except where otherwise stated in the contract or in The Company's current price list all prices include the cost of packaging and delivery (but not installation). The Company reserves the right to make additional charges if the Customer requires a method of packaging or delivery different from that normally employed by The Company.
- 4.1 The Customer shall, in addition to the net purchase price, pay to The Company the amount of any Value Added Tax or other sales tax at the rate in force at the time the Goods are invoiced.

### GENERAL

5. All Goods will be invoiced at the time of, or soon after, despatch. Payment for the Goods must be received by The Company not later than the last day of the month following the date of the invoice. In the event of late payment The Company reserves the right to charge interest at a rate of 2% per month.
- 5.1 In the event of the Customer postponing delivery, or requesting that The Company suspend the manufacture of the Goods, or failing to give The Company sufficient information to enable it to process any order, the Customer shall pay any additional costs and expenses thereby incurred by The Company.
- 5.2 Unless otherwise agreed in writing by The Company the Customer shall not be entitled to set off against any moneys due to The Company under the Contract any sums claimed by or due to the Customer from The Company under the Contract or any other Contract between The Company and the Customer.

### ILLUSTRATION AND DIMENSIONS

6. All information and illustrations contained in brochures, catalogues, price lists, trade literature and advertising material produced by The Company are approximate only, intended to indicate only the general character of the Goods, and do not form any part of any contract between The Company and the Customer.

- 1.1 The dimensions of the Goods are subject to manufacturing tolerances customary within the trade. Dimensions contained in quotations, acknowledgements of orders, or catalogues, price lists, advertising matter and other trade literature are therefore approximate only.

### SUBSTITUTED GOODS

1. The Company reserves the right to substitute Goods which are similar to the Goods ordered by the Customer provided that such substituted Goods are no less suitable for the purpose for which they are generally used than Goods ordered by the Customer.

### DELIVERY

2. The Company cannot offer a timed delivery service, although we will try to meet the customer needs wherever possible. Any deliveries required outside our delivery schedule will be at the customer's expense.
3. Delivery shall be made to the Customer's premises only.
4. The Customer shall be responsible for unloading the Goods at the point of delivery.
5. The Customer will confirm the goods are received at the time of delivery by signing the Proof Of Delivery document (POD) providing a signature, date and printed name.
6. Immediately on collection or delivery, whichever is appropriate, the Customer shall examine the goods. Any shortages, damages or other delivery discrepancies must be notified directly to the Customer Support team of The Company in writing within three working days of delivery or collection. Credits will not be given if a POD has been signed and there have been no reported anomalies within 3 working days of the delivery date.
7. The Company will use its best endeavours to comply with any delivery date, however, collection or delivery dates and times indicated by the Company shall be regarded as best estimates only. The Company cannot be responsible for any loss or damage whatsoever caused by late delivery where circumstance beyond The Company's control have caused such delay.
8. The Company operates a minimum delivery value requirement for deliveries to the Customer's premises. This currently stands at £500.
9. Orders placed below the minimum order value will be subject to a £10 minimum order value charge.
10. Express orders should be placed before our cut offs for delivery the next day. These orders are subject to a carriage charge to the customer and will be priced based on weight.

### RETURNS

11. The Company does not operate a returns policy for saleable stock or for stock that is defective or damaged upon receipt. Any agreed stock return is at the discretion of The Company and only with prior written consent. Where such consent is given, a handling charge of a minimum of 30% of invoiced value will be made.

### RISK AND RETENTION OF OWNERSHIP

12. The risk in the Goods contracted to be sold by The Company shall pass to the Customer when the Goods are delivered to or collected by the Customer.

Sales und delivery conditions

13. Notwithstanding any passing of risk to the Customer, The Company retains ownership of the Goods the subject matter of this Contract the property in which shall not pass to the Customer and the Customer shall keep any Goods delivered to it as bailee for and on behalf of The Company until The Company has received full payment of the price of all Goods (whether or not the Goods are delivered in instalments and some have been paid for by the Customer).
- 13.1 Until ownership of the Goods has passed to the Customer the Customer;
  - (i) shall insure the Goods against any loss or damage with an insurance office of repute.
  - (ii) shall store the Goods separately or in some other way ensure that they are readily identifiable as the property of The Company.
  - (iii) irrevocably authorise the representative of The Company at any time and from time to time (whether or not payment is due) to repossess the Goods and for such purpose to enter any premises occupied by the Customer or where the Goods are or are thought to be and to sever the Goods from anything to which they are attached without being responsible for any damage caused.
  - (iv) shall keep the Goods free from any charge, lien or other encumbrance
- 13.2 If, while under The Company's ownership, the Goods or any of them are processed or incorporated into other Goods ("the New Goods") then, provided the Goods remain a readily identifiable and removable part of the New Goods, the provisions of conditions (a) and (b) shall apply.
- 13.3 The Company (acting on its own account, not as agent for the Customer) may sell or agree to sell any of the Goods or the New Goods in The Company's possession on such terms as it may in its sole discretion consider appropriate.
- 13.4 The Company shall be entitled to a general lien over all Goods and materials of the Customer which is in The Company's possession or control from time to time for any sums due at any time whatsoever to The Company.
- 13.5 Nothing in this condition shall confer any right upon the Customer to refuse or delay payment therefore.

**LIMITATION OF LIABILITIES**

14. Goods may be delivered in cartons, bundles, returnable containers, loose or in other packaging. In any case where it is established to the satisfaction of The Company that the Goods have been damaged or lost (whether wholly or in part) in transit The Company will, at its own cost, repair or replace same provided that
  - (i) in the case of partial loss or damage, the Customer has returned to The Company's representative (or where the Goods have been delivered by a Carrier his representative) The Company' receipt note duly signed by the Customer's representative and indicating thereon as shortage of or damage to cartons, bundles, returnable containers, loose Goods or other such packages as shall make up the delivery and full particulars are notified directly to The Company in writing within three working days of delivery;
  - (ii) in the case of damage the Goods and their packaging are retained by the Customer for inspection by The Company's representative. The Company will not be liable for any loss or damage in transit, except as above.
- 14.1 Where it is established to the satisfaction of The Company that Goods delivered by them or collected by the Customer, contain at the time of receipt by the Customer some defect in quality (not being a defect caused by some act or neglect of the Customer or a third party) and the Goods are returned to The Company at the Customer's expense within three months of despatch to the Customer, The Company will at its own cost repair or replace them (the choice being at The Company's option).
- 14.2 (c) Save as aforesaid and to the extent permitted by law The Company will not be liable to the Customer for any loss or damage whatsoever suffered as a result of a defect in quality or defective installation or the fact that the Goods are not fit for

a particular purpose save for the conditions implied by section 12 of the Sale of Goods Act 1979 and without prejudice to the generality of the foregoing any implied term, condition or warranty statutory or otherwise as to the quality of the Goods sold or their fitness for any particular purpose or as to their correspondence with any description or sample

15. is hereby excluded.
16. No warranty or representation given by or on behalf of The Company including without prejudice to the generality of the foregoing any advice as to the installation quantities use or performance of Goods supplied by The Company shall be binding upon The Company unless specifically stated in writing by The Company to be incorporated in the contract. Nothing in these Conditions excludes or limits the liability of The Company for death or personal injury caused by The Company's negligence or fraudulent misrepresentation.

**CONSEQUENTIAL LOSS**

17. Without prejudice to the generality of the foregoing provisions The Company shall not in any event be liable to the Customer for any indirect or consequential loss of or damage (whether for loss of profit, loss of business, depletion of goodwill or otherwise) costs, expenses or other claims for consequential compensation whatsoever (howsoever caused) which arise out of or in connection with the Contract.

**INSOLVENCY AND BREACH OF CONTRACT**

18. The Company shall have the option (without prejudice to any of its other rights against the Customer) by notice in writing to the Customer to rescind the contract or to suspend delivery in the following events:
  - (i) should any sum owing by the Customer to The Company be overdue.
  - (ii) should the Customer be in breach of any term of the contract with The Company.
  - (iii) should the Customer enter into any composition or arrangement with, or for the benefit of its creditors or have a receiving order in bankruptcy made against him or (if a body corporate) should it go into liquidation either voluntary or compulsory or under supervision or have a receiver and/or manager administrative receiver or administrator appointed over all or any part of its assets, or in Scotland should the Customer become notour bankrupt, or sequestrated, or a receiver, or judicial factor, or trustee is appointed, for any portion of the Customer's estate or effects or suffer any arrestment charge pending or other diligence to be issued or levied upon the Customer his estate or effects.

**HEALTH AND SAFETY**

19. As The Company is under a duty pursuant to S 6 of the Health and Safety at Work Act 1974 in respect of the design, manufacture and supply of any article for use at work, the Customer shall be deemed to have been afforded by The Company reasonable opportunity for the testing and examination of Goods or materials in respect of their safety and risk to health prior to delivery to the Customer, and he shall be deemed to have been afforded by The Company adequate information about the Goods and materials in respect of the use for which they are designed, and have been tested, and of any conditions necessary to ensure that when put to that use they will be safe and without risk to health, whether or not the said information has been requested by the Customer.

## INDUSTRIAL AND INTELLECTUAL PROPERTY RIGHTS

1. The Company is the proprietor or beneficial owner of patents, registered designs, trademarks and tradenames, copyright or other industrial or intellectual property rights relating to the Goods and The Company reserves all such rights to itself and no authorisation of licence is granted to the Customer to use the Goods or any drawing or specifications relating to the same provided to the Customer by The Company otherwise than for the purpose provided.

## FORCE MAJEURE

2. The Company reserves the right to defer the date of delivery or to cancel the Contract or reduce the volume of the Goods ordered by the Customer (without liability to the Customer) if it is prevented from or delayed in the carrying on of its business due to circumstances beyond the reasonable control of the Company including without limitation, acts of God, Governmental actions, war or national emergency, riot, civil commotion, fire, explosion, flood, epidemic, lock out, strikes or other labour disputes (whether or not relating to either party's workforce) or restraints or delays affecting carriers or inability or delay in obtaining supplies of adequate suitable materials.

## WAIVER

3. Forbearance or indulgence by The Company shown or granted to the Customer whether in respect of these Conditions of Sale or otherwise, shall not affect or prejudice the rights of The Company against the Customer or be taken as a waiver of any of these Conditions of Sale.

## GOVERNING LAW

4. Any contract incorporating these Conditions of Sale shall be governed by and construed in accordance with the laws of England and The Company and the Customer hereby agree to submit to the jurisdiction of the English Courts.

## HEADNOTES

5. The head notes to these Conditions have been inserted for convenience and shall not affect their construction.

Conditions Of Sale  
Geberit Sales Ltd  
Geberit House, Academy Drive  
Warwick, Warwickshire  
CV34 6QZ  
Effective January 2016

## 1.6.3 Index

Art. no.	Page	Art. no.	Page	Art. no.	Page	Art. no.	Page
23799	30	601.276.00.5	39	602.130.00.2	10	602.762.26.1	49
63789	30	601.289.00.5	32	602.131.00.2	10	602.763.00.1	49
91037	56	601.293.00.5	32	602.132.00.1	11	602.780.00.5	36
91047	56	601.296.00.5	32	602.134.00.1	11	602.781.00.5	35
91066	56	601.360.00.5	18	602.135.00.1	11	602.782.00.5	35
91067	56	601.508.00.5	19	602.136.00.1	11	602.783.00.5	37
91068	56	601.535.00.5	19	602.200.00.1	11	602.784.00.5	36
91169	56	601.536.00.5	19	602.230.00.1	12	602.785.00.5	35
91170	56	601.555.00.5	20	602.231.00.2	12	602.800.00.1	46
91171	56	601.556.00.5	20	602.232.00.1	12	602.811.00.1	48
91172	56	601.571.00.5	26	602.235.00.1	12	602.910.00.5	55
91173	56	601.575.00.5	13	602.252.00.5	21	603.100.00.1	10
242.319.00.1	55	601.581.00.5	28	602.253.00.5	21	603.110.00.1	10
242.320.00.1	55	601.582.00.5	28	602.256.00.5	21	603.132.00.1	11
242.323.00.1	55	601.583.00.5	28	602.257.00.5	21	603.134.00.1	11
242.324.00.1	55	601.584.00.5	28	602.273.00.5	33	603.135.00.1	11
242.325.00.1	55	601.590.00.5	27	602.274.00.5	33	603.136.00.1	11
242.326.00.1	55	601.595.00.5	27	602.275.00.5	33	603.200.00.1	11
242.327.00.1	55	601.710.00.1	49	602.276.00.5	39	603.230.00.1	12
242.329.00.1	55	601.720.00.1	47	602.283.00.1	31	603.232.00.1	12
242.330.00.1	55	601.731.00.1	54	602.285.00.1	32	603.235.00.1	12
242.331.00.1	55	601.732.00.1	54	602.287.00.1	32	603.253.00.5	21
242.332.00.1	55	601.733.00.1	53	602.289.00.5	32	603.254.00.5	21
242.333.00.1	55	601.736.00.1	53	602.293.00.5	32	603.257.00.5	21
242.976.00.1	55	601.737.00.1	53	602.294.00.5	32	603.258.00.5	21
360.850.00.1	51	601.738.00.1	53	602.295.00.1	33	603.294.00.5	32
361.850.00.1	51	601.741.00.1	54	602.296.00.5	32	603.360.00.5	18
362.848.26.1	52	601.744.00.1	54	602.360.00.5	18	603.362.00.5	18
362.851.26.1	52	601.761.00.1	49	602.422.00.1	40	603.508.00.5	19
362.856.26.1	51	601.763.00.1	49	602.423.00.1	40	603.535.00.5	19
362.857.26.1	51	601.781.00.5	35	602.480.00.1	40	603.536.00.5	19
364.850.00.1	51	601.785.00.5	35	602.482.00.1	40	603.537.00.5	19
365.850.00.1	51	601.800.00.1	46	602.507.00.5	19	603.556.00.5	20
465.034.00.1	34	601.801.00.1	47	602.508.00.5	19	603.557.00.5	20
465.038.00.1	34	601.802.00.1	47	602.509.00.5	19	603.571.00.5	26
601.100.00.1	10	601.805.00.1	47	602.535.00.5	19	603.575.00.5	13
601.130.00.1	10	601.811.00.1	48	602.536.00.5	19	603.582.00.5	28
601.130.00.2	10	601.812.00.1	48	602.555.00.5	20	603.583.00.5	28
601.131.00.2	10	601.813.00.1	48	602.556.00.5	20	603.584.00.5	28
601.132.00.1	11	601.815.00.1	48	602.571.00.5	26	603.585.00.5	28
601.134.00.1	11	601.851.26.1	50	602.575.00.5	13	603.586.00.5	28
601.135.00.1	11	601.852.26.1	50	602.581.00.5	28	603.587.00.5	28
601.136.00.1	11	601.853.26.1	50	602.582.00.5	28	603.590.00.5	27
601.200.00.1	11	601.854.26.1	50	602.583.00.5	28	603.595.00.5	27
601.230.00.1	12	601.855.26.1	50	602.584.00.5	28	603.702.00.1	51
601.230.00.2	12	601.856.26.1	50	602.585.00.5	28	603.710.00.1	49
601.231.00.2	12	601.858.26.1	50	602.586.00.5	28	603.800.00.1	46
601.232.00.1	12	601.859.26.1	50	602.590.00.5	27	603.811.00.1	48
601.235.00.1	12	601.860.26.1	50	602.591.00.5	27	603.910.00.5	55
601.252.00.5	21	601.910.00.5	55	602.595.00.5	27	604.100.00.1	10
601.256.00.5	21	602.100.00.1	10	602.710.00.1	49	604.254.00.5	21
601.273.00.5	33	602.130.00.1	10	602.761.00.1	49	604.258.00.5	21

Art. no.	Page	Art. no.	Page	Art. no.	Page	Art. no.	Page
604.360.00.5	18	606.540.00.5	19	611.603.22.2	45	623.318.00.5	17
604.362.00.5	18	606.559.00.5	20	611.605.BM.1	48	623.372.00.5	23
604.363.00.5	18	606.560.00.5	20	611.610.BM.1	48	623.505.00.5	13
604.508.00.5	19	606.571.00.5	26	612.250.22.5	43	623.536.00.5	20
604.537.00.5	19	606.575.00.5	13	612.251.22.5	43	623.650.00.5	14
604.538.00.5	19	606.580.00.5	28	612.256.00.5	20	623.651.00.5	14
604.557.00.5	20	606.581.00.5	28	612.260.00.1	41	624.245.00.5	15
604.558.00.5	20	606.582.00.5	28	612.265.00.1	42	624.271.00.5	15
604.571.00.5	26	606.583.00.5	28	612.277.00.6	38	624.310.00.5	16
604.575.00.5	13	606.584.00.5	28	612.289.00.5	31	624.311.00.5	17
604.581.00.5	28	606.585.00.5	28	612.293.00.5	31	624.314.00.5	17
604.583.00.5	28	606.590.00.5	27	612.315.00.5	41	624.316.00.5	17
604.584.00.5	28	606.591.00.5	27	612.316.00.5	41	624.317.00.5	17
604.585.00.5	28	606.595.00.5	27	612.319.00.5	41	624.319.00.5	17
604.586.00.5	28	606.596.00.5	27	612.361.22.6	44	624.505.00.5	13
604.590.00.5	27	606.702.00.1	51	612.362.22.5	43	624.537.00.5	20
604.591.00.5	27	606.910.00.5	55	612.512.24.5	29	624.651.00.5	14
604.595.00.5	27	607.100.00.1	10	612.566.00.5	29	624.652.00.5	14
604.596.00.5	27	607.255.00.5	21	613.312.00.5	41	625.245.00.5	15
604.702.00.1	51	607.256.00.5	21	613.313.00.5	41	625.271.00.5	15
604.910.00.5	55	607.360.00.5	18	613.314.00.5	41	625.310.00.5	16
605.100.00.1	10	607.363.00.5	18	613.513.24.5	29	625.317.00.5	17
605.255.00.5	21	607.366.00.5	18	613.567.00.5	29	625.319.00.5	17
605.259.00.5	21	607.508.00.5	19	621.000.00.5	30	625.321.00.5	17
605.360.00.5	18	607.539.00.5	19	621.271.00.5	15	625.505.00.5	13
605.363.00.5	18	607.541.00.5	19	621.272.00.5	22	625.538.00.5	20
605.364.00.5	18	607.560.00.5	20	621.310.00.5	16	625.651.00.5	14
605.508.00.5	19	607.561.00.5	20	621.372.00.5	23	625.652.00.5	14
605.537.00.5	19	607.571.00.5	26	621.505.00.5	13	625.653.00.5	14
605.538.00.5	19	607.581.00.5	28	621.562.00.5	22	626.245.00.5	15
605.539.00.5	19	607.583.00.5	28	622.000.00.5	30	626.271.00.5	15
605.557.00.5	20	607.584.00.5	28	622.271.00.5	15	626.310.00.5	16
605.558.00.5	20	607.587.00.5	28	622.272.00.5	22	626.317.00.5	17
605.559.00.5	20	607.590.00.5	27	622.310.00.5	16	626.319.00.5	17
605.571.00.5	26	607.591.00.5	27	622.311.00.5	17	626.320.00.5	17
605.575.00.5	13	607.595.00.5	27	622.312.00.5	17	626.321.00.5	17
605.581.00.5	28	607.702.00.1	51	622.313.00.5	17	626.505.00.5	13
605.582.00.5	28	607.910.00.5	55	622.314.00.5	17	626.537.00.5	20
605.585.00.5	28	608.100.00.1	10	622.373.00.5	23	626.652.00.5	14
605.589.00.5	28	608.363.00.5	18	622.374.00.5	23	626.653.00.5	14
605.590.00.5	27	608.520.00.5	30	622.375.00.5	23	627.245.00.5	15
605.591.00.5	27	608.541.00.5	19	622.376.00.5	23	627.271.00.5	15
605.595.00.5	27	608.561.00.5	20	622.505.00.5	13	627.310.00.5	16
605.596.00.5	27	608.702.00.1	51	622.535.00.5	20	627.316.00.5	17
605.702.00.1	51	608.910.00.5	55	622.562.00.5	22	627.320.00.5	17
605.910.00.5	55	611.250.22.5	43	622.650.00.5	14	627.321.00.5	17
606.100.00.1	10	611.260.00.1	41	623.000.00.5	30	627.322.00.5	17
606.255.00.5	21	611.263.00.1	42	623.245.00.5	15	627.505.00.5	13
606.256.00.5	21	611.277.00.6	38	623.271.00.5	15	627.539.00.5	20
606.360.00.5	18	611.289.00.5	31	623.310.00.5	16	627.653.00.5	14
606.361.00.5	18	611.319.00.5	41	623.311.00.5	17	627.654.00.5	14
606.363.00.5	18	611.361.22.6	44	623.315.00.5	17	628.245.00.5	15
606.508.00.5	19	611.512.24.5	29	623.316.00.5	17	628.271.00.5	15
606.537.00.5	19	611.565.00.5	29	623.317.00.5	17	628.310.00.5	16

## Index

Art. no.	Page
628.316.00.5	17
628.320.00.5	17
628.321.00.5	17
628.322.00.5	17
628.323.00.5	17
628.505.00.5	13
628.541.00.5	20
628.653.00.5	14
628.654.00.5	14
628.655.00.5	14
631.272.00.6	24
631.372.00.6	25
631.562.00.6	24
632.001.00.1	26
632.005.00.1	18
632.006.00.1	19
632.007.00.1	18
632.008.00.1	18
632.272.00.6	24
632.373.00.6	25
632.374.00.6	25
632.375.00.6	26
632.376.00.6	26
632.562.00.6	24
632.856.00.1	37
632.859.00.1	38
633.372.00.6	25
633.373.00.5	25
641.513.00.1	45
641.514.00.1	46
641.515.00.1	45
641.516.22.1	46
641.517.22.1	46
641.534.22.2	39
642.534.22.2	39